



51 Olivers Meadow

  
BRENNAN & CHATTERTON  
ESTATES

Guide Price £345,000





## 51 Olivers Meadow

A well-presented three-bedroom semi-detached home occupying a corner position within a quiet cul-de-sac.

The property has been improved by the current owners and is presented in good order throughout. The ground floor comprises a modern fitted kitchen with a range of integrated appliances and ample storage, together with a separate dining room which forms part of a former garage conversion. To the rear, the sitting room spans the width of the house and enjoys direct access to the garden through double doors, allowing plenty of natural light to flow through the room.

To the first floor are three bedrooms, including a particularly generous principal bedroom benefitting from fitted wardrobes and a dressing area. The remaining bedrooms are served by a family bathroom fitted with a bath and shower over.

Outside, the property benefits from a wrap-around garden which is a particular feature of the home. The garden extends to the side and rear, providing a combination of lawn and patio areas. The various seating areas and open lawn create a well-balanced outside space, offering plenty of room to enjoy throughout the year. To the front, a private driveway provides off-road parking.





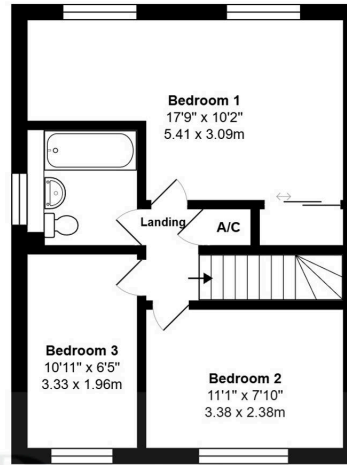

**First Floor**

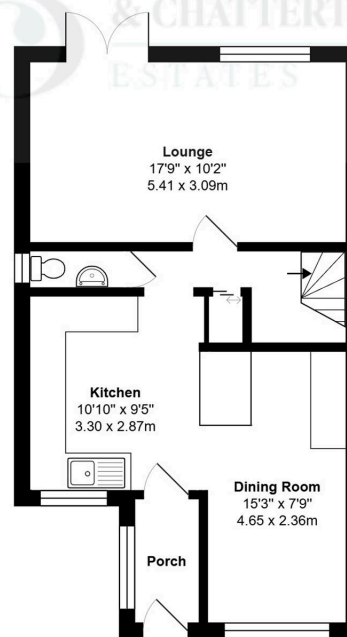

**Ground Floor**

Total Area: 969 ft<sup>2</sup> ... 90.1 m<sup>2</sup>

Whilst every attempt has been made to ensure the accuracy of the floor plan contained here, measurements are approximate and no responsibility is taken for error, omission or mis-statement.  
 This plan is for illustrative purposes only and should be used as such by any prospective purchaser.  
 Created by 1st Image 2026



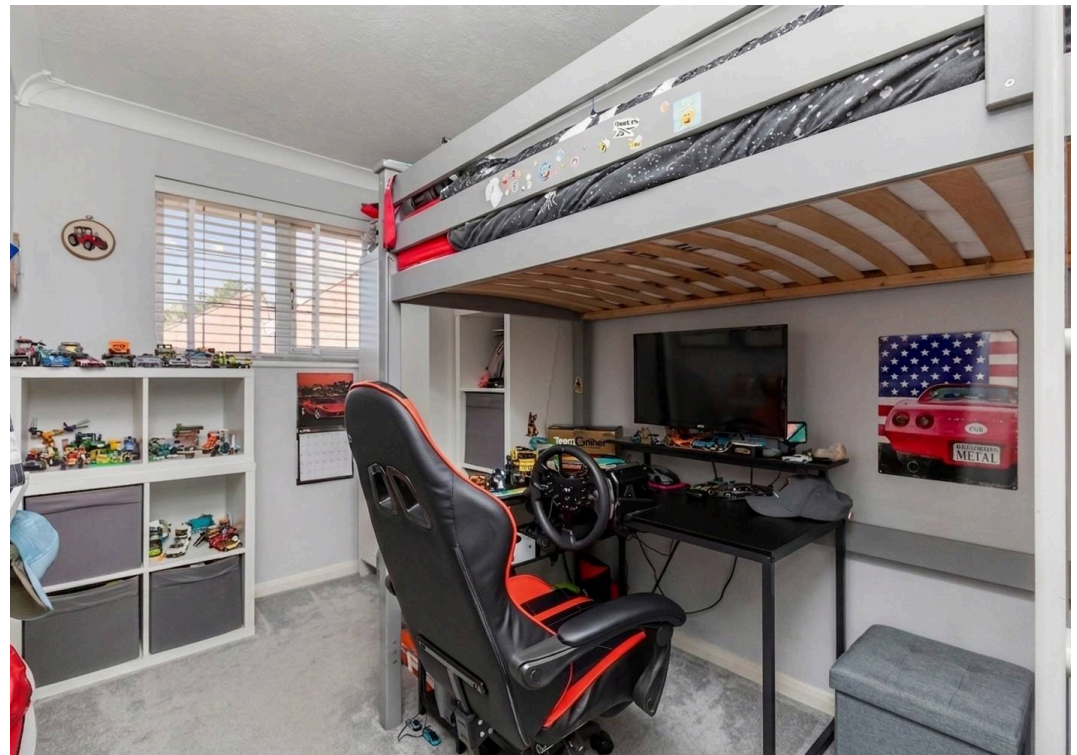









## Brennan and Chatterton Estates

17 Elmer Road, Bognor Regis - PO22 6DZ

01243  
984444 • [info@brennanandchatterton.co.uk](mailto:info@brennanandchatterton.co.uk) • <https://www.brennanandchatterton.co.uk>



**BRENNAN  
& CHATTERTON**  
ESTATES