



Loughborough Park, SW9

£475,000

A well-proportioned two-bedroom apartment measuring just under 850 sq ft, featuring two double bedrooms, two modern bathrooms, a sleek kitchen with generous storage and integrated appliances, and a spacious open-plan living and dining area that opens onto a private balcony. Offered chain-free with a long lease.

Farlow House is located within a contemporary development, just a short walk from the vibrant shops, cafes, and restaurants of both central Brixton and Herne Hill Village. Residents also enjoy close proximity to the expansive green spaces of Brockwell Park and its iconic Lido, with excellent transport links nearby including Brixton Underground, Loughborough Junction, and Herne Hill stations.

Features

- Chain Free
- Bike Storage
- Two Double Bedrooms
- Two Bathrooms

Loughborough Park, London, SW9

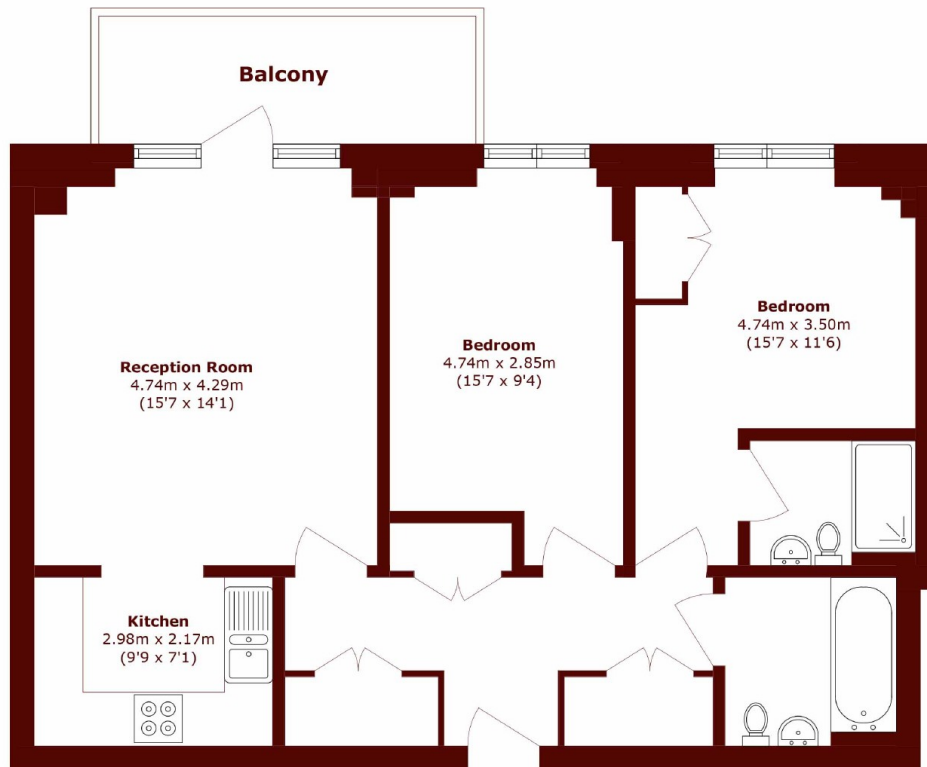

Total area (approx.): 78.2 sq. m (841.7 sq. ft)

Balcony area (approx.): 7.5 sq. m (80.7 sq. ft)