



jordan fishwick

Kinder Road Hayfield High Peak



Kinder Road Hayfield High Peak SK22 2HJ

£325,000



The Property

Located in the heart of the charming and ever popular village of Hayfield, a refurbished and very well presented TWO DOUBLE BEDROOM stone built cottage. Blending character and contemporary with an open plan ground floor comprising a lounge with multi-fuel burning stove, fully fitted contemporary dining kitchen with feature Stone floor, two good sized first floor bedrooms (master with built in wardrobes) and a white bathroom suite. Useful attic for storage, double glazing, gas central heating and a large rear area for both PARKING and a garden. No Chain and Viewing Essential.



- Superb Stone Built Cottage
- Popular Hayfield Village Location
- Convenient For All Local Amenities
- Two Generous Bedrooms
- Off Road Parking and Garden Area
- Open Plan Ground Floor
- Wealth Of Features
- No Chain

Postcode SK22 2HJ

EPC Rating C

Local Authority High Peak

Council Tax C

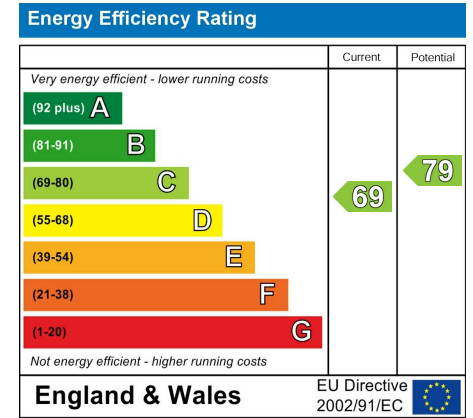

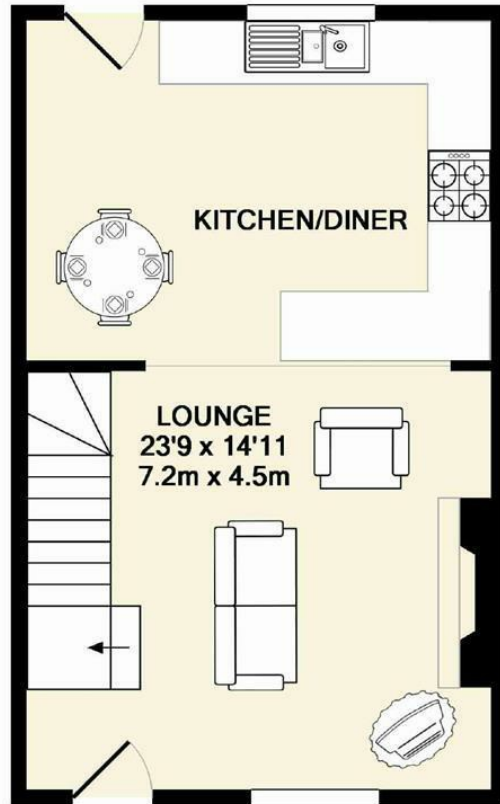

GROUND FLOOR

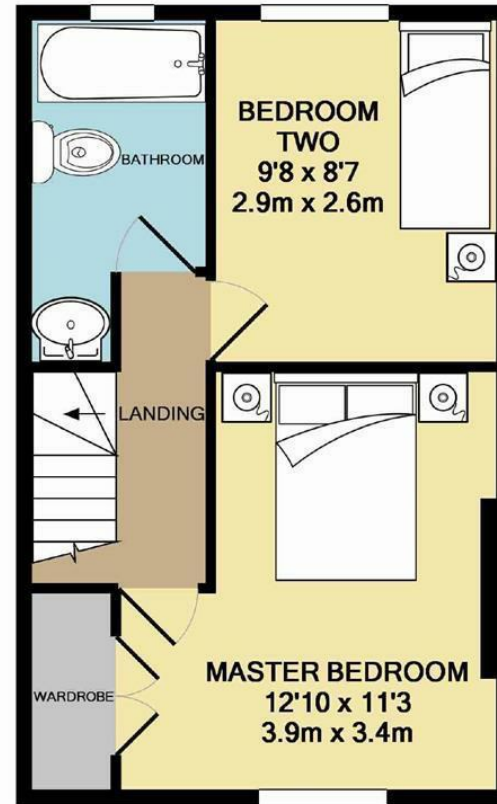

1ST FLOOR

Whilst every attempt has been made to ensure the accuracy of the floor plan contained here, measurements of doors, windows, rooms and any other items are approximate and no responsibility is taken for any error, omission, or mis-statement. This plan is for illustrative purposes only and should be used as such by any prospective purchaser. The services, systems and appliances shown have not been tested and no guarantee as to their operability or efficiency can be given
 Made with Metropix ©2016



These particulars are believed to be accurate but they are not guaranteed and do not form a contract. Neither Jordan Fishwick nor the vendor or lessor accept any responsibility in respect of these particulars, which are not intended to be statements or representations of fact and any intending purchaser or lessee must satisfy himself by inspection or otherwise as to the correctness of each of the statements contained in these particulars. Any floorplans on this brochure are for illustrative purposes only and are not necessarily to scale.

Offices at: Chorlton, Didsbury, Disley, Hale, Glossop, Macclesfield, Manchester Deansgate, Manchester Whitworth Street, New Mills, Sale, Wilmslow and Withington

14 Market St, Disley, Cheshire, Stockport SK12 2AA

01663 767878

disley@jordanfishwick.co.uk
 www.jordanfishwick.co.uk