



See More Online

KFB: Key Facts For Buyers

A Guide to This Property & the Local Area

Wednesday 01st October 2025

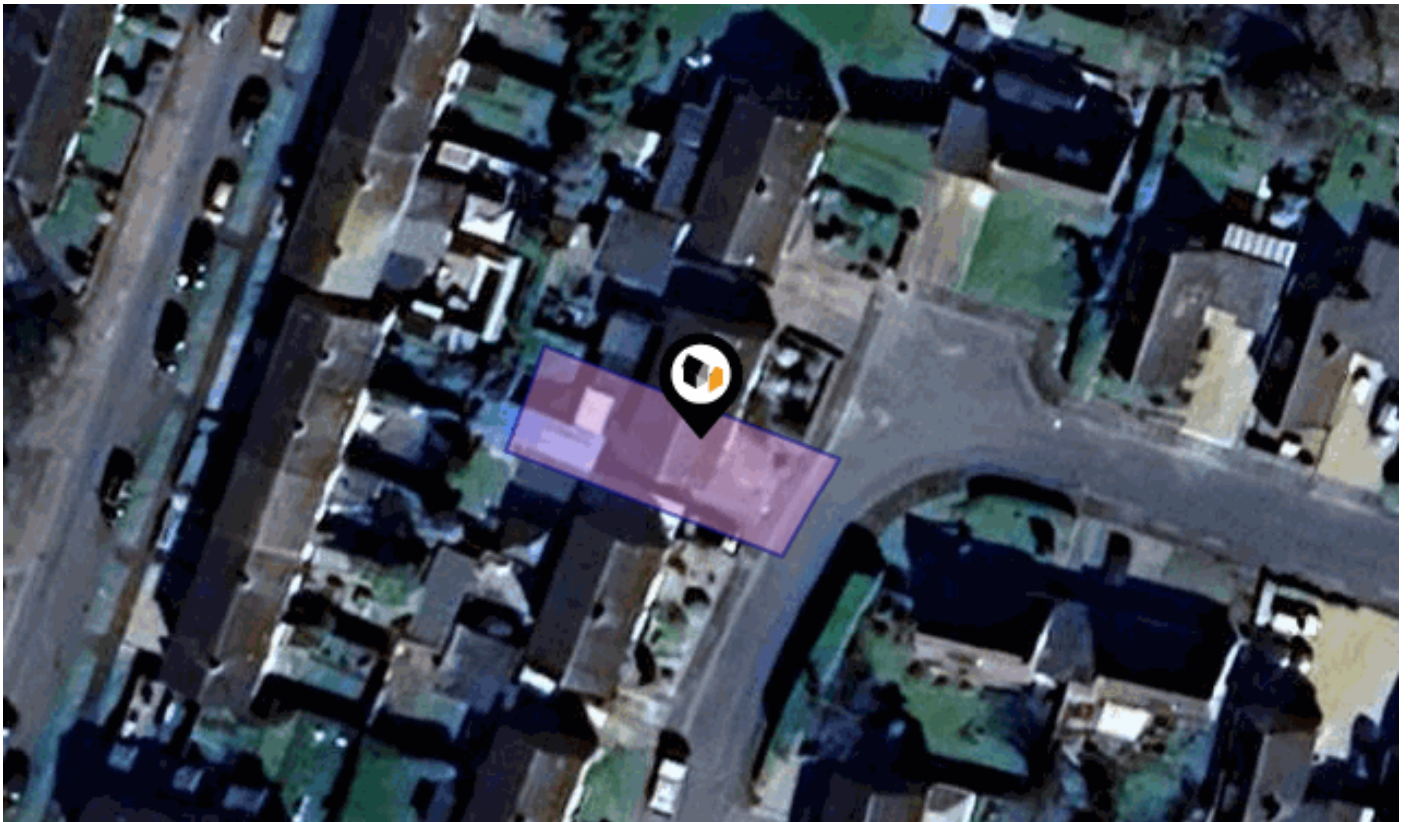

CHAMPNEYS ROAD, DISS, IP22

Whittley Parish | Diss

4-6 Market Hill Diss IP22 4JZ

01379640808

admin@whittleyparish.com

<https://www.whittleyparish.com/>





Property

Type:	Terraced	Tenure:	Freehold
Bedrooms:	3		
Floor Area:	1,119 ft ² / 104 m ²		
Plot Area:	0.06 acres		
Year Built :	1967-1975		
Council Tax :	Band C		
Annual Estimate:	£2,105		
Title Number:	NK17883		

Local Area

Local Authority:	South norfolk
Conservation Area:	No
Flood Risk:	
• Rivers & Seas	Very low
• Surface Water	Very low

Estimated Broadband Speeds (Standard - Superfast - Ultrafast)

17 mb/s	80 mb/s	- mb/s

Mobile Coverage: (based on calls indoors)



Satellite/Fibre TV Availability:



Planning History

This Address



Planning records for: *Champneys Road, Diss, IP22*

Reference - 2013/0192	
Decision:	Decided
Date:	30th January 2013
Description:	Partly demolish conservatory and erect single storey extension



Gallery Photos

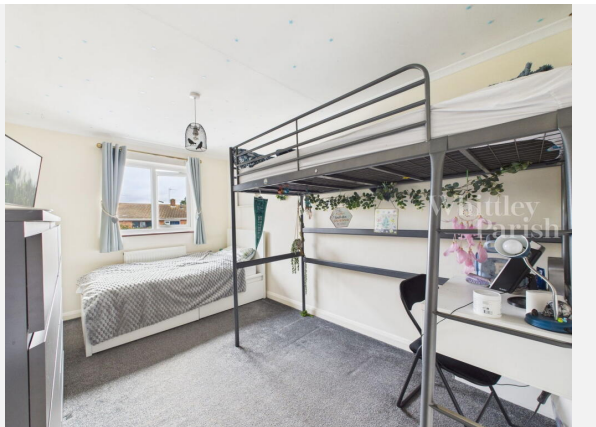





CHAMPNEYS ROAD, DISS, IP22

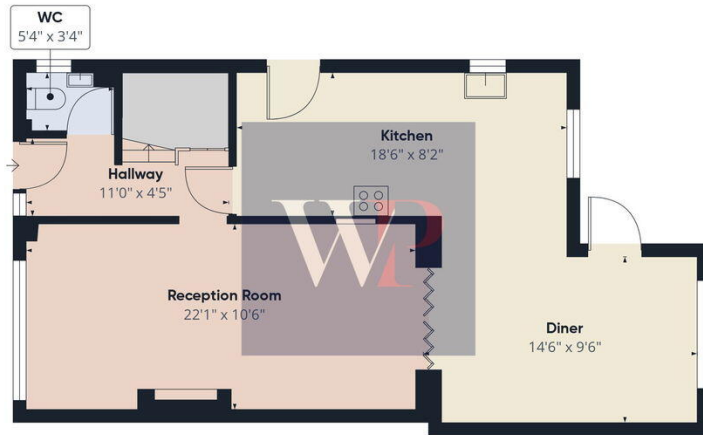

Floor 0

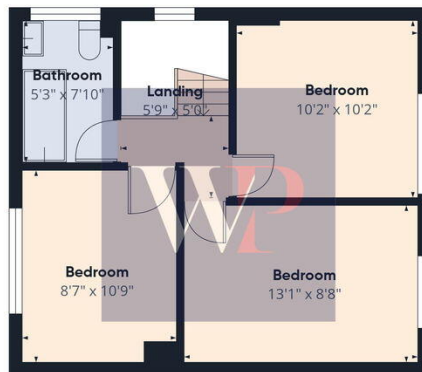

Floor 1



Approximate total area[®]
1003 ft²

(1) Excluding balconies and terraces

Calculations reference the RICS IPMS 3C standard. Measurements are approximate and not to scale. This floor plan is intended for illustration only.

GIRAFFE360



DISS, IP22

Energy rating

C

Valid until 29.09.2035

Score	Energy rating	Current	Potential
92+	A		
81-91	B		
69-80	C	70 c	78 c
55-68	D		
39-54	E		
21-38	F		
1-20	G		

Property

EPC - Additional Data



Additional EPC Data

Property Type:	Semi-detached house
Walls:	Cavity wall, filled cavity
Walls Energy:	Good
Roof:	Pitched, 200 mm loft insulation
Roof Energy:	Good
Window:	Fully double glazed
Window Energy:	Average
Main Heating:	Boiler and radiators, mains gas
Main Heating Energy:	Good
Main Heating Controls:	Programmer, room thermostat and TRVs
Main Heating Controls Energy:	Good
Hot Water System:	From main system
Hot Water Energy Efficiency:	Good
Lighting:	Excellent lighting efficiency
Lighting Energy:	Very good
Floors:	Solid, no insulation (assumed)
Secondary Heating:	Room heaters, dual fuel (mineral and wood)
Air Tightness:	(not tested)
Total Floor Area:	101 m ²

Market

House Price Statistics



10 Year History of Average House Prices by Property Type in IP22

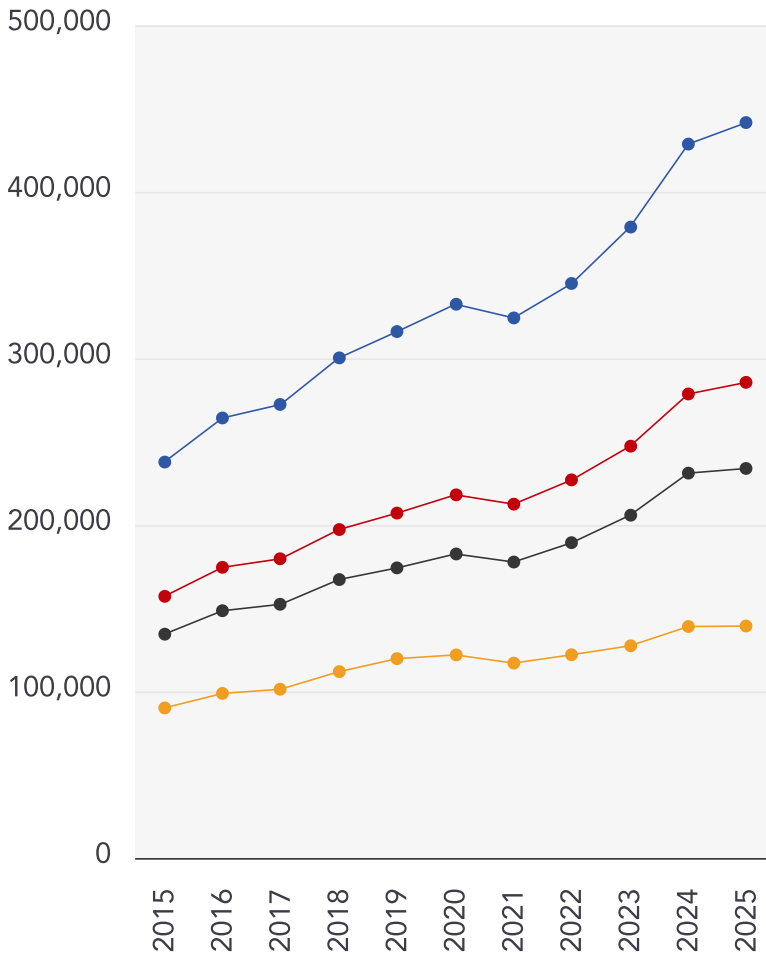

Detached

+85.73%

Semi-Detached

+81.75%

Terraced

+74.03%

Flat

+54.55%

Maps

Coal Mining



This map displays nearby coal mine entrances and their classifications.

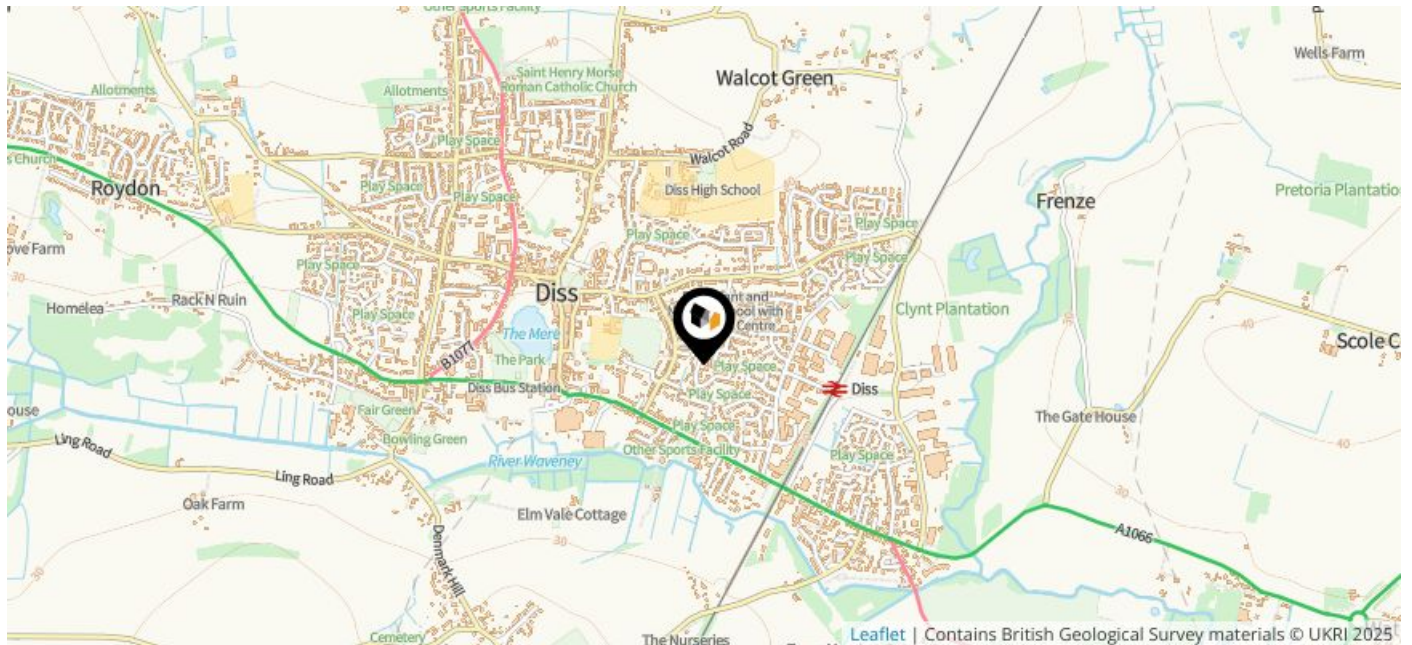

Mine Entry

- ✕ Adit
- ✕ Gutter Pit
- ✕ Shaft

The Coal Authority has records of over 175,000 mine entries within the UK captured in the National Coal Mining database, derived from sources including abandonment plans, geological and topographical plans.

Coal mining activity is recorded as far back as the 13th century, but prior to 1872 there was no requirement to deposit abandonment plans. It is therefore believed there may be many unrecorded mine entries of which the Authority has no information or knowledge. These entries do not, therefore, appear within the Authority's national dataset as shown on this map.

Maps

Conservation Areas



This map displays nearby official conservation areas. Every local authority in England has at least one conservation area. Most are designated by the Council as the local planning authority, though Historic England and the Secretary of State also have the power to create them.

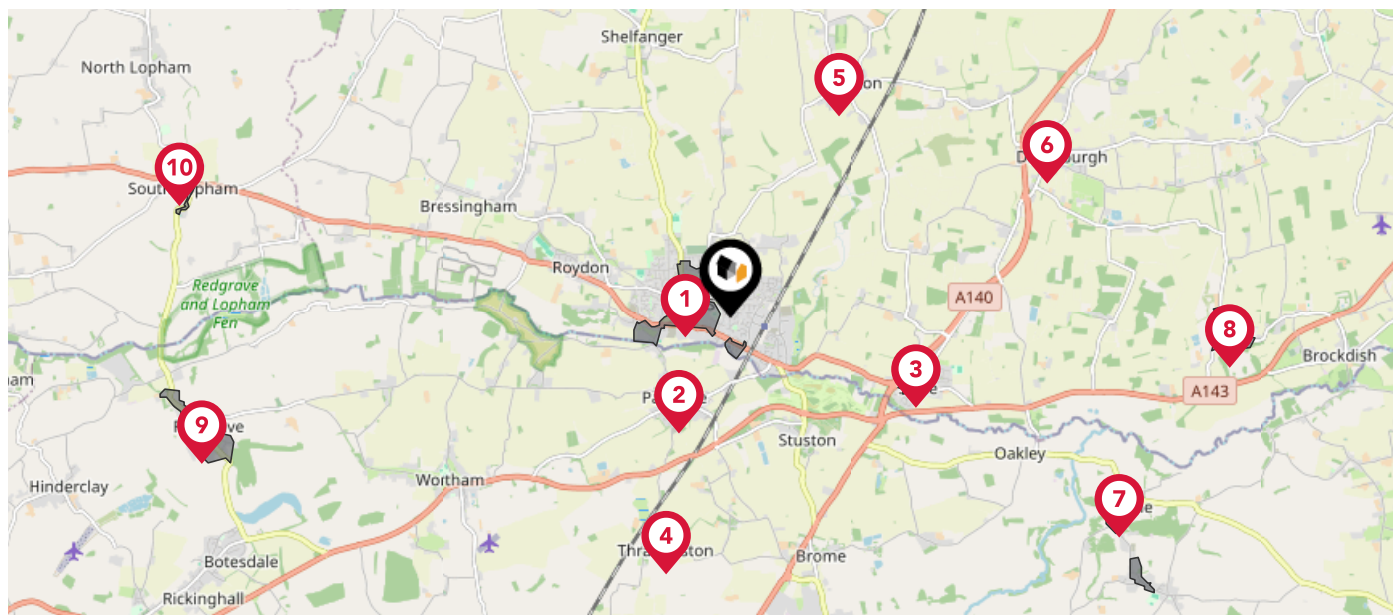

Nearby Conservation Areas

- 1 Diss
- 2 Palgrave
- 3 Scole
- 4 Thrandeston
- 5 Burston
- 6 Dickleburgh
- 7 Hoxne
- 8 Thorpe Abbots
- 9 Redgrave
- 10 South Lopham

Maps



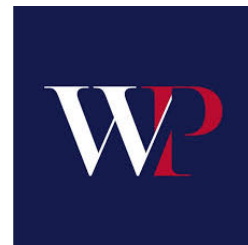



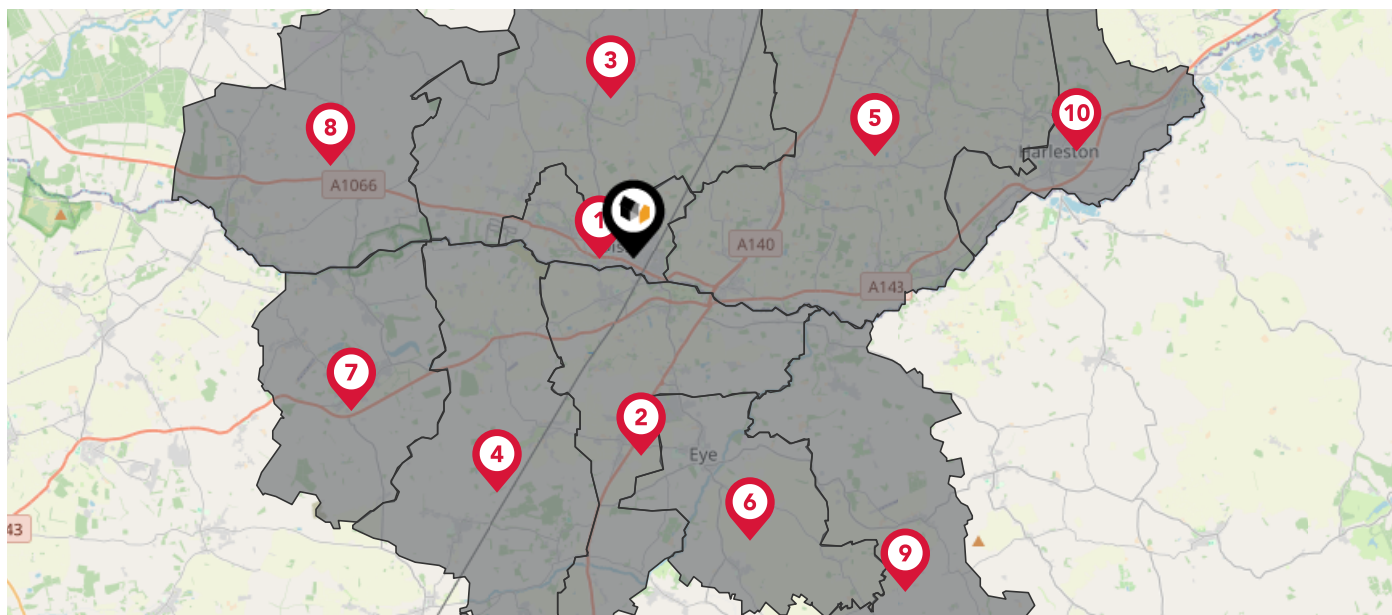



Council Wards



The UK is divided into wards that are used for local elections to elect local government councillors. Sometimes these are known as 'electoral divisions'. Population counts can vary substantially between wards, but the national average is about 5,500



Nearby Council Wards

-  1 Diss & Roydon Ward
-  2 Palgrave Ward
-  3 Bressingham & Burston Ward
-  4 Gislingham Ward
-  5 Beck Vale, Dickleburgh & Scole Ward
-  6 Eye Ward
-  7 Rickinghall Ward
-  8 Guiltcross Ward
-  9 Hoxne & Worlingworth Ward
-  10 Harleston Ward



This map displays the noise levels from nearby network rail and HS1 railway routes that affect this property...

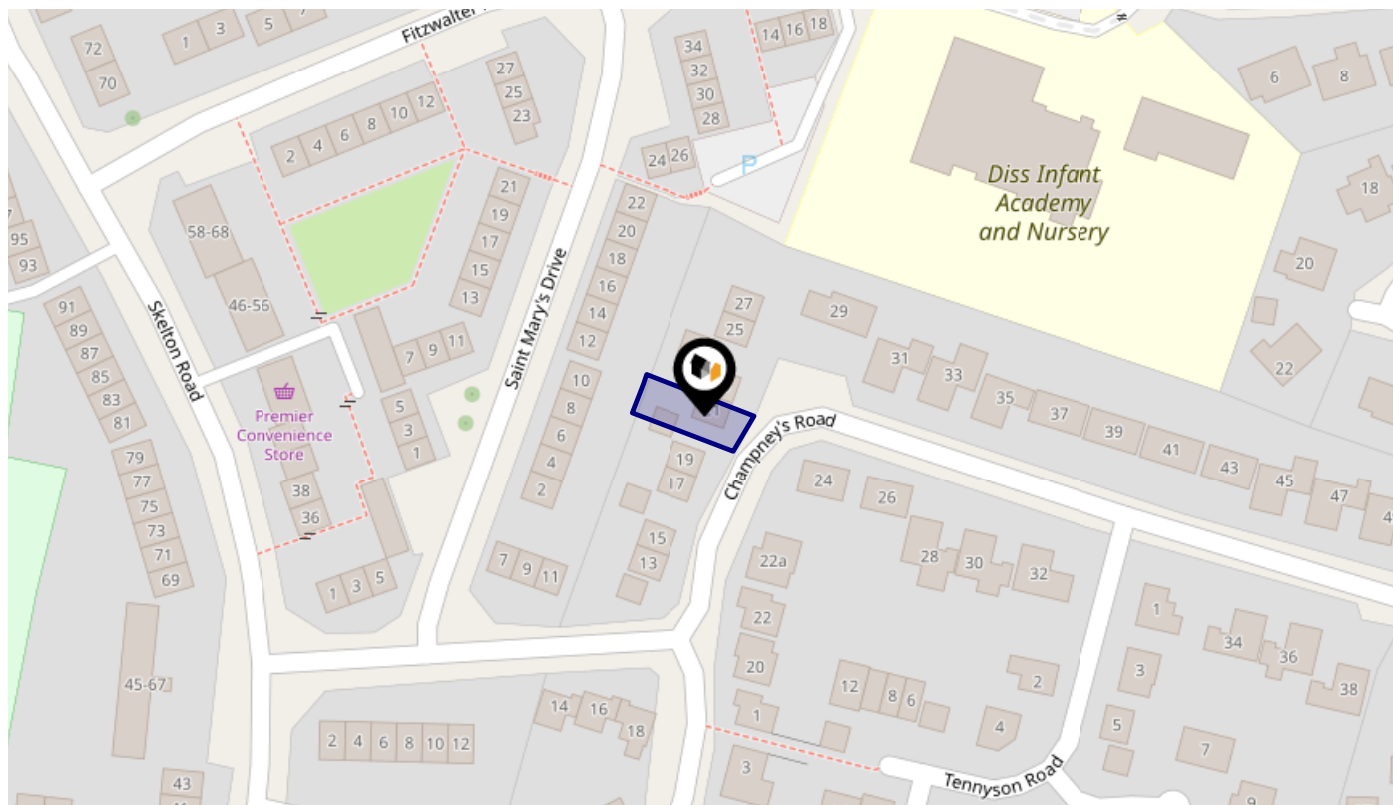

Rail Noise Data

This data indicates the level of noise according to the strategic noise mapping of rail sources within areas with a population of at least 100,000 people (agglomerations) and along Network Rail and HS1 traffic routes.

The data indicates the annual average noise levels for the 16-hour period between 0700 - 2300.

Noise levels are modelled on a 10m grid at a receptor height of 4m above ground, polygons are then produced by merging neighbouring cells within the following noise classes:

5		75.0+ dB	■
4		70.0-74.9 dB	■
3		65.0-69.9 dB	■
2		60.0-64.9 dB	■
1		55.0-59.9 dB	■

Flood Risk

Rivers & Seas - Flood Risk



This map shows the chance of flooding from rivers and / or the sea, taking into account flood defences and their condition.

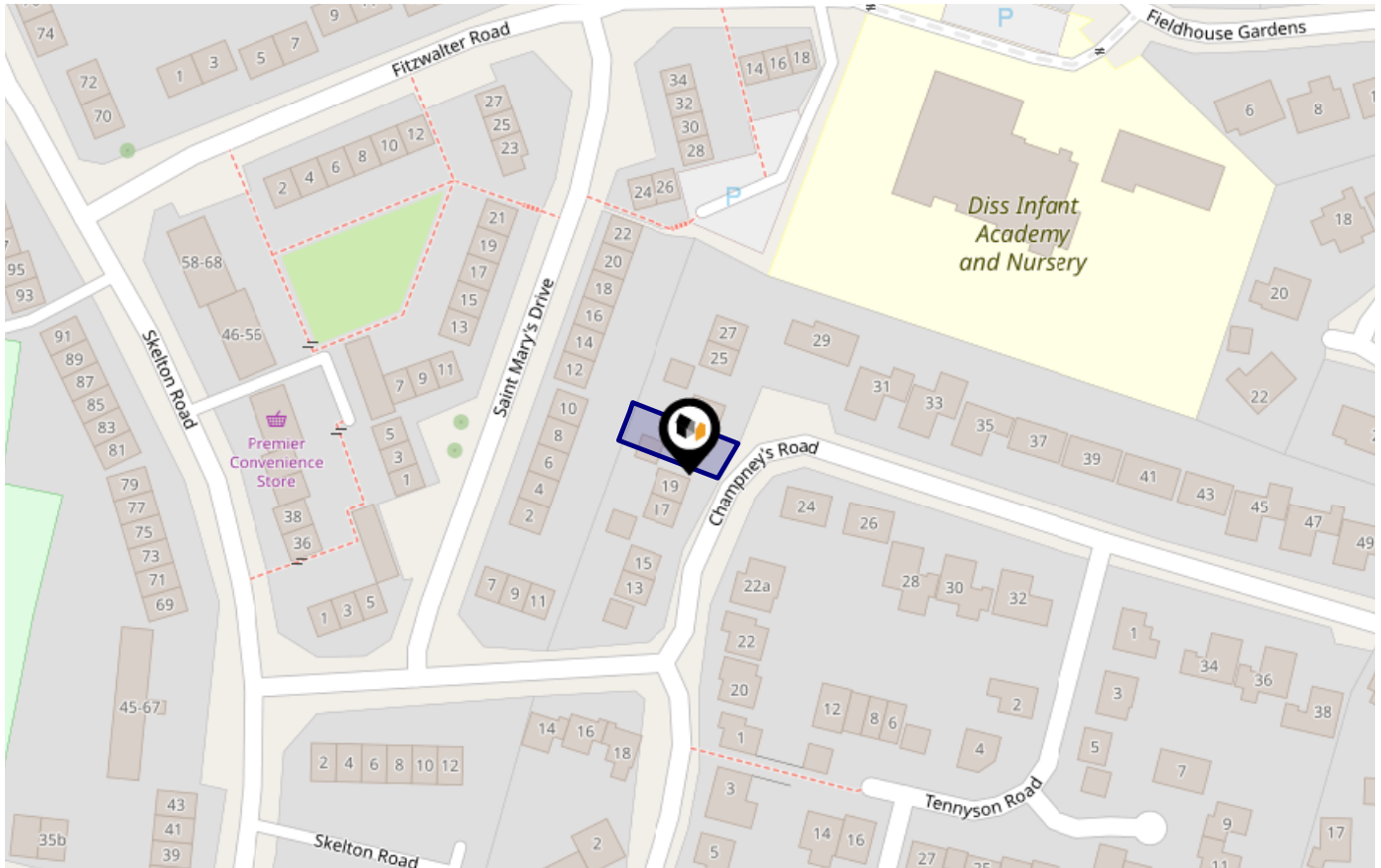

Risk Rating: Very low

The map does not contain sufficient information for it to be used to determine flood risk to individual properties, but it does give you an indication of whether your area may be affected by surface water flooding at this risk level.

- **High Risk** - an area which has a chance of flooding of greater than 1 in 30 (3.3%) in any one year.
- **Medium Risk** - an area which has a chance of flooding of greater than 1 in 100 (1.0%) in any one year.
- **Low Risk** - an area which has a chance of flooding of greater than 1 in 1000 (0.1%) in any one year.
- **Very Low Risk** - an area in which the risk is below 1 in 1000 (0.1%) in any one year.

Chance of flooding to the following depths at this property:



Flood Risk

Rivers & Seas - Climate Change



This map shows the future chance of flooding from rivers and / or the sea **between 2036 and 2069**, taking into account flood defences and their condition. The government climate change models cannot predict exactly when the chance of flooding will go up. It could happen at any time during the time period.

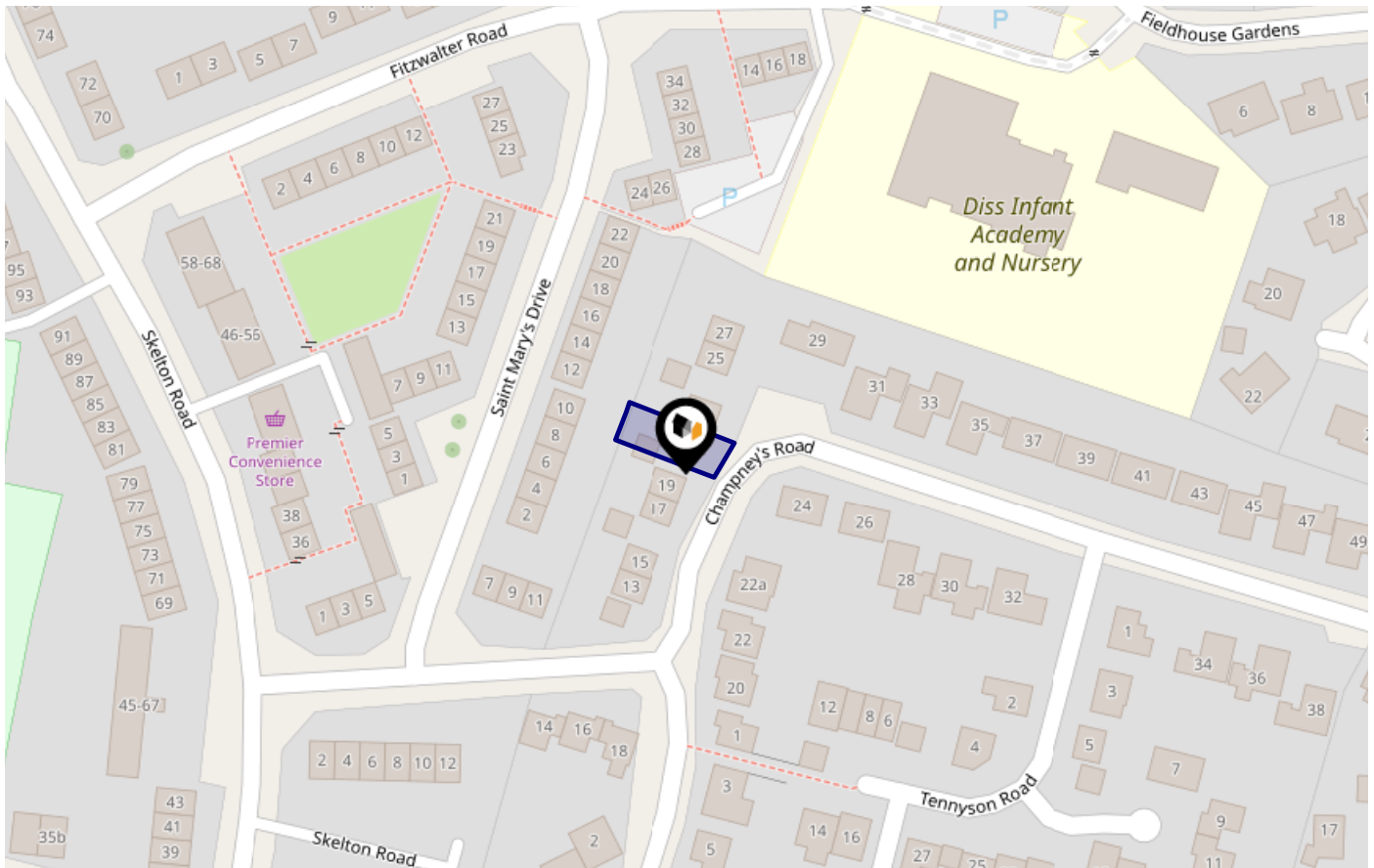

Risk Rating: Very low

The map does not contain sufficient information for it to be used to determine flood risk to individual properties, but it does give you an indication of whether your area may be affected by surface water flooding at this risk level.

- High Risk** - an area which has a chance of flooding of greater than 1 in 30 (3.3%) in any one year.
- Medium Risk** - an area which has a chance of flooding of greater than 1 in 100 (1.0%) in any one year.
- Low Risk** - an area which has a chance of flooding of greater than 1 in 1000 (0.1%) in any one year.
- Very Low Risk** - an area in which the risk is below 1 in 1000 (0.1%) in any one year.

Chance of flooding to the following depths at this property:



Flood Risk

Surface Water - Flood Risk



This map shows the chance of flooding where rainwater has nowhere to drain. This kind of flooding can occur far from rivers or seas.

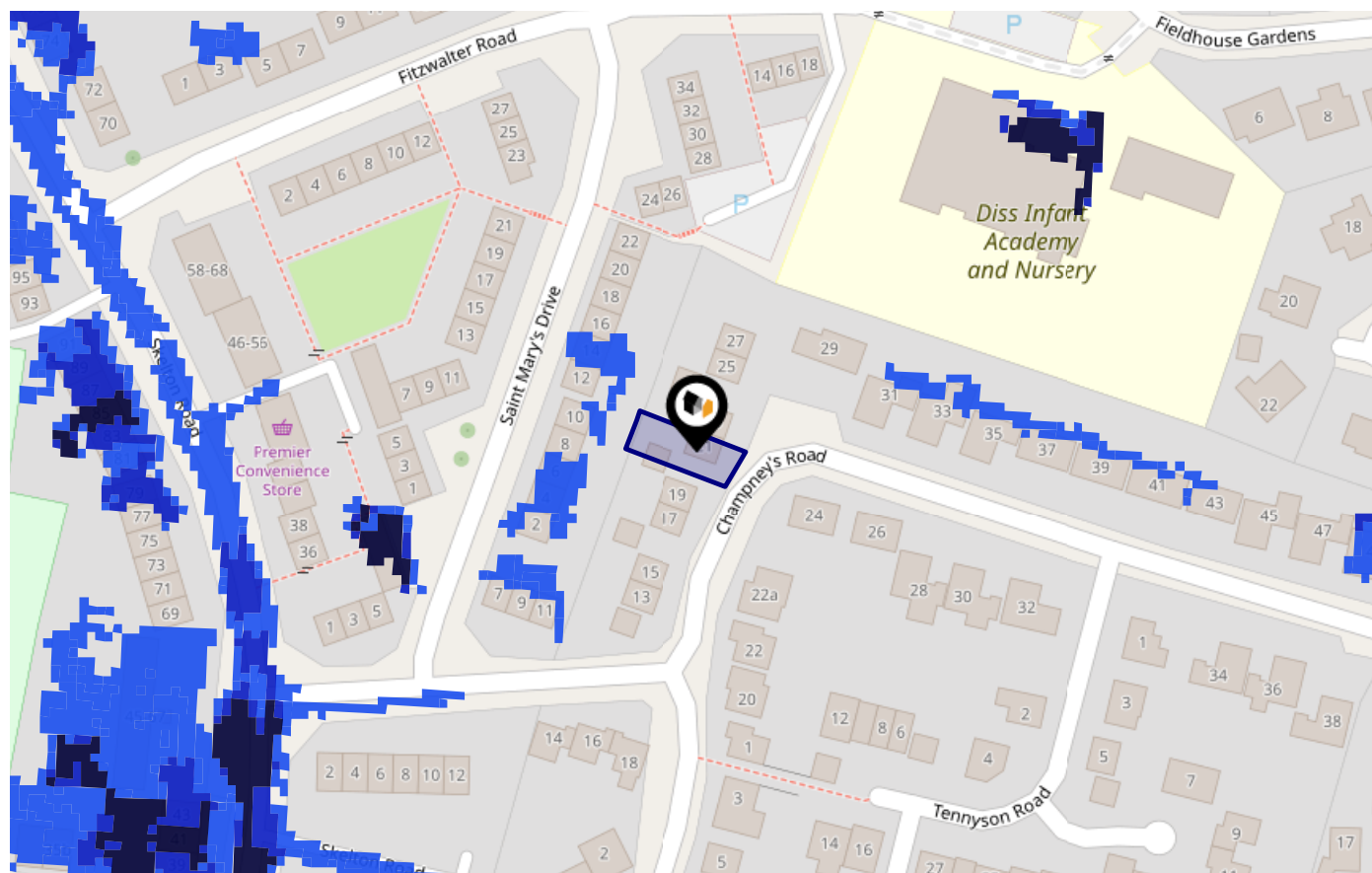

Risk Rating: Very low

The map does not contain sufficient information for it to be used to determine flood risk to individual properties, but it does give you an indication of whether your area may be affected by surface water flooding at this risk level.

- **High Risk** - an area which has a chance of flooding of greater than 1 in 30 (3.3%) in any one year.
- **Medium Risk** - an area which has a chance of flooding of greater than 1 in 100 (1.0%) in any one year.
- **Low Risk** - an area which has a chance of flooding of greater than 1 in 1000 (0.1%) in any one year.
- **Very Low Risk** - an area in which the risk is below 1 in 1000 (0.1%) in any one year.

Chance of flooding to the following depths at this property:

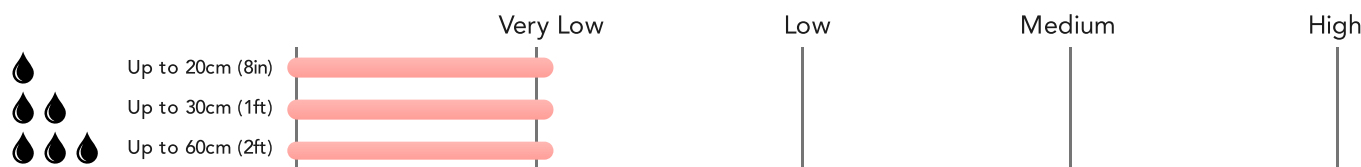

Flood Risk

Surface Water - Climate Change



This map shows the future chance of flooding **between 2040 and 2060** where rainwater has nowhere to drain. This kind of flooding can occur far from rivers or seas. The government climate change models cannot predict exactly when the chance of flooding will go up. It could happen at any time during the time period.

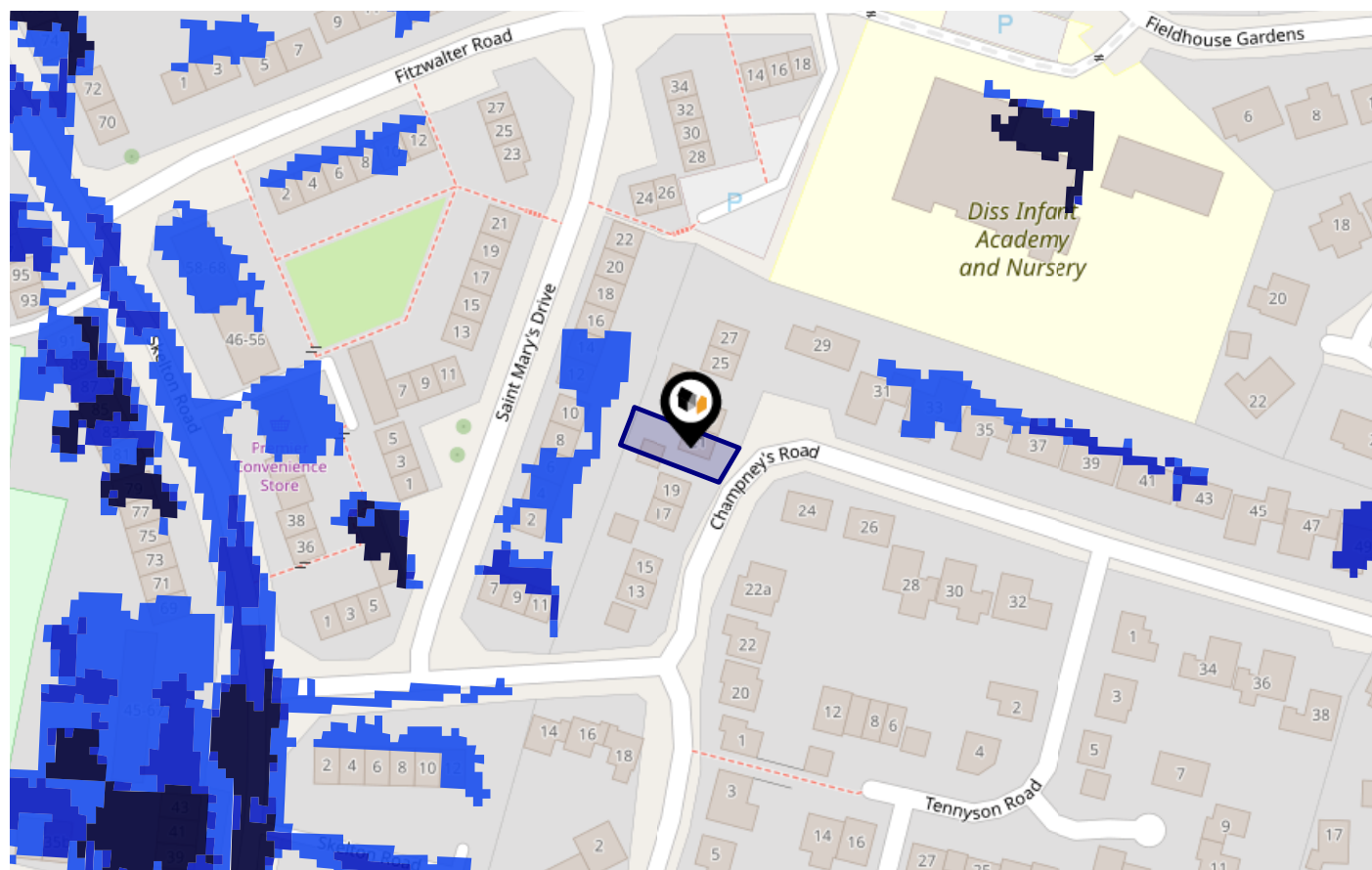

Risk Rating: Very low

The map does not contain sufficient information for it to be used to determine flood risk to individual properties, but it does give you an indication of whether your area may be affected by surface water flooding at this risk level.

- High Risk** - an area which has a chance of flooding of greater than 1 in 30 (3.3%) in any one year.
- Medium Risk** - an area which has a chance of flooding of greater than 1 in 100 (1.0%) in any one year.
- Low Risk** - an area which has a chance of flooding of greater than 1 in 1000 (0.1%) in any one year.
- Very Low Risk** - an area in which the risk is below 1 in 1000 (0.1%) in any one year.

Chance of flooding to the following depths at this property:



Maps

Green Belt



This map displays nearby areas that have been designated as Green Belt...

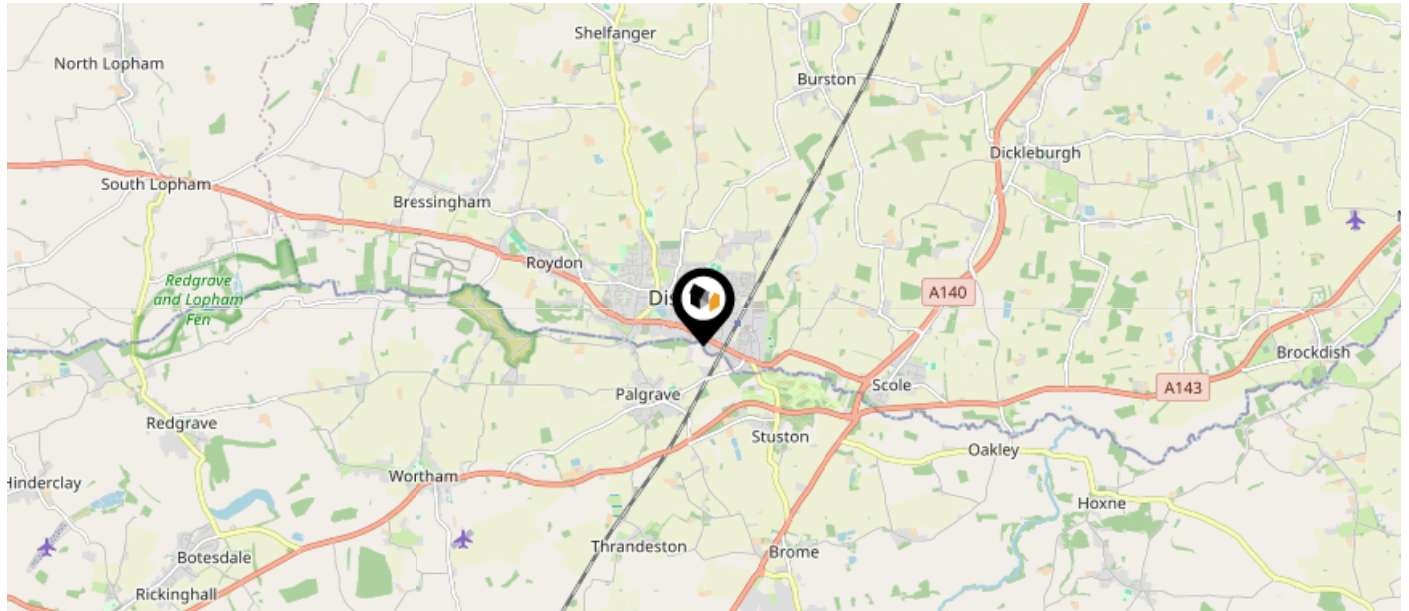

Nearby Green Belt Land

No data available.

Maps

Landfill Sites



This map displays the location of known landfill sites. Historic sites are where there is no environmental permit in force. Active sites are currently authorised by the Environment Agency under Environmental Permitting Regulations.

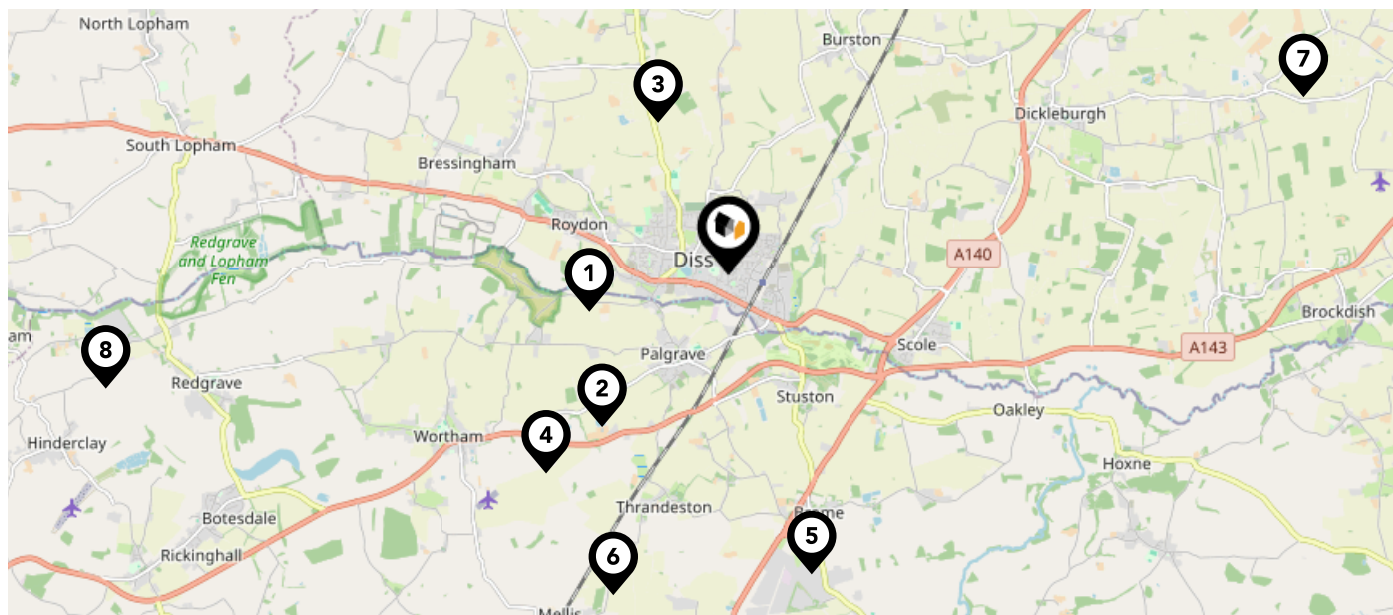

Nearby Landfill Sites

1	Roydon Fen-Roydon, Norfolk	Historic Landfill
2	Rookery Farm-Rookery Farm, Wortham	Historic Landfill
3	Near Shelfhanger Road (B1077)-Diss, Norfolk	Historic Landfill
4	Rookery Farm-Rookery Farm, Wortham	Historic Landfill
5	Land East of Brome Industrial Estate-Brome, Mid Suffolk	Historic Landfill
6	Mellis Road-Mellis Road, Thrandeston	Historic Landfill
7	Furze Green - South Green-Dickleburgh	Historic Landfill
8	Redgrave Road-Hinderclay	Historic Landfill









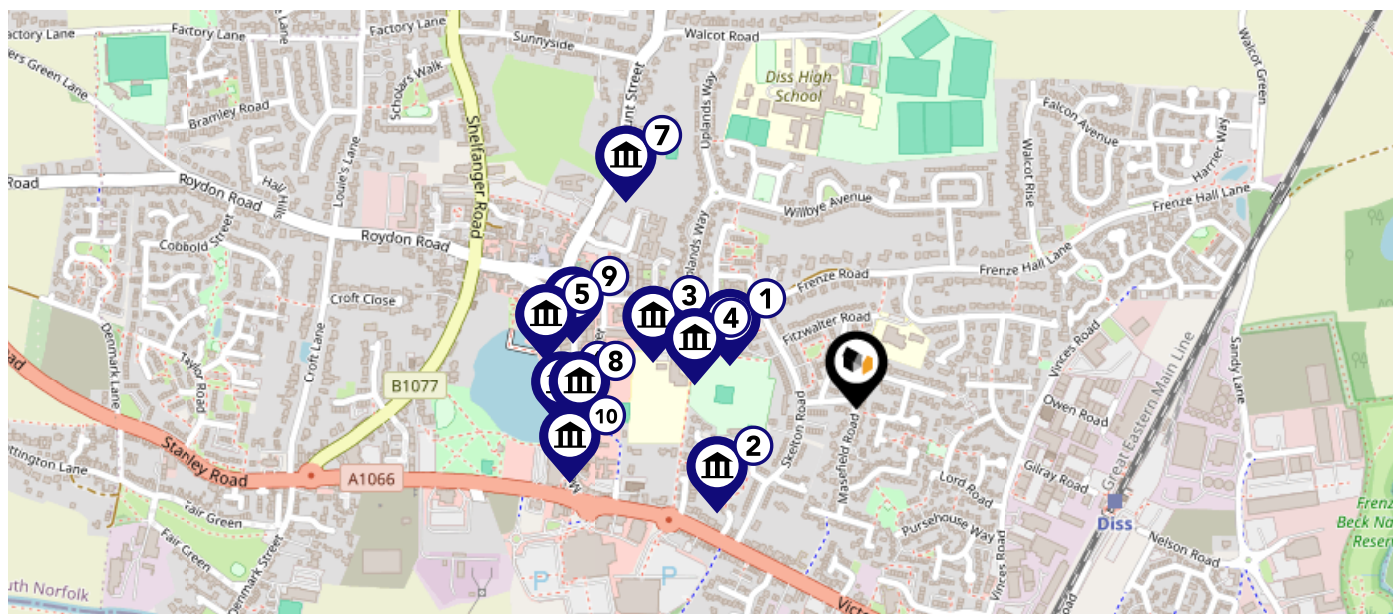

Maps

Listed Buildings



This map displays nearby listed buildings and protected structures, as well as their listed tier and distance from the target property...



Listed Buildings in the local district	Grade	Distance
 1049735 - Diss Quaker Meeting House	Grade II	0.1 miles
 1049691 - Mere Manor	Grade II	0.2 miles
 1169965 - 6 And 7, The Entry	Grade II	0.2 miles
 1271675 - Wilderness Cottage	Grade II	0.2 miles
 1170095 - 16 16a, Market Place	Grade II	0.3 miles
 1049754 - 46 47, Mere Street	Grade II	0.3 miles
 1049718 - The Manor House	Grade II	0.3 miles
 1049756 - 38, Chapel Street	Grade II	0.3 miles
 1049761 - Dolphin Cottage	Grade II	0.3 miles
 1306190 - 25-27, Mere Street	Grade II	0.3 miles

Area Schools

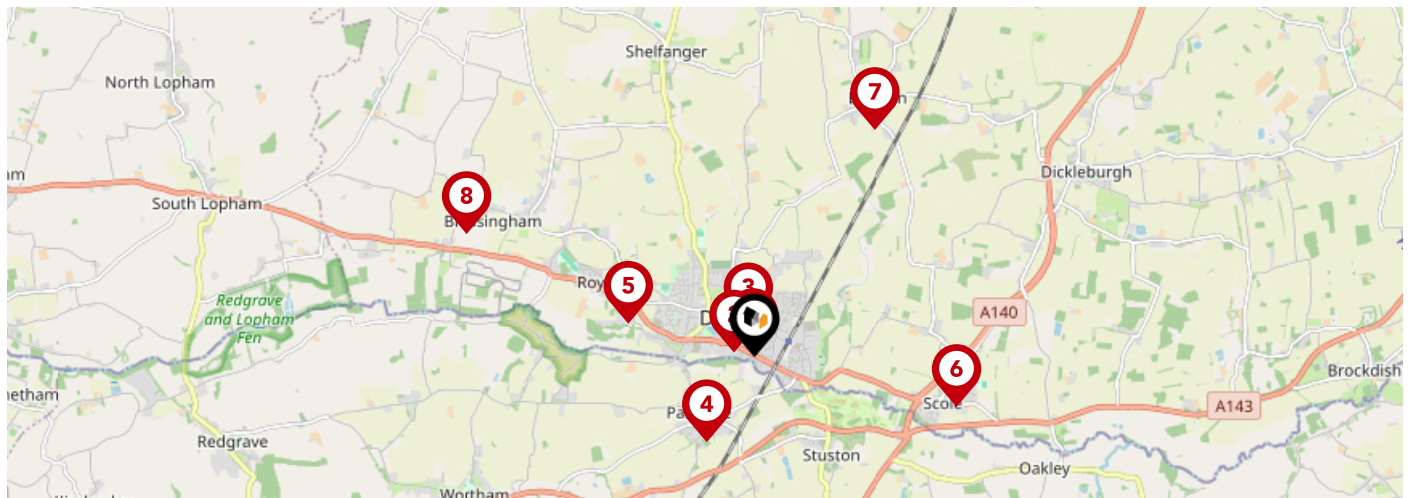

	Nursery	Primary	Secondary	College	Private
1 Diss Infant Academy and Nursery Ofsted Rating: Requires improvement Pupils: 116 Distance:0.07	<input type="checkbox"/>	<input checked="" type="checkbox"/>	<input type="checkbox"/>	<input type="checkbox"/>	<input type="checkbox"/>
2 Diss Church of England Junior Academy Ofsted Rating: Good Pupils: 189 Distance:0.2	<input type="checkbox"/>	<input checked="" type="checkbox"/>	<input type="checkbox"/>	<input type="checkbox"/>	<input type="checkbox"/>
3 Diss High School Ofsted Rating: Good Pupils: 941 Distance:0.3	<input type="checkbox"/>	<input type="checkbox"/>	<input checked="" type="checkbox"/>	<input type="checkbox"/>	<input type="checkbox"/>
4 Palgrave Church of England Primary School Ofsted Rating: Good Pupils: 82 Distance:0.89	<input type="checkbox"/>	<input checked="" type="checkbox"/>	<input type="checkbox"/>	<input type="checkbox"/>	<input type="checkbox"/>
5 Roydon Primary School Ofsted Rating: Good Pupils: 261 Distance:1.19	<input type="checkbox"/>	<input checked="" type="checkbox"/>	<input type="checkbox"/>	<input type="checkbox"/>	<input type="checkbox"/>
6 Scole Church of England Primary Academy Ofsted Rating: Good Pupils: 51 Distance:1.88	<input type="checkbox"/>	<input checked="" type="checkbox"/>	<input type="checkbox"/>	<input type="checkbox"/>	<input type="checkbox"/>
7 Burston Community Primary School Ofsted Rating: Good Pupils: 36 Distance:2.33	<input type="checkbox"/>	<input checked="" type="checkbox"/>	<input type="checkbox"/>	<input type="checkbox"/>	<input type="checkbox"/>
8 Bressingham Primary School Ofsted Rating: Good Pupils: 142 Distance:2.85	<input type="checkbox"/>	<input checked="" type="checkbox"/>	<input type="checkbox"/>	<input type="checkbox"/>	<input type="checkbox"/>

Area Schools

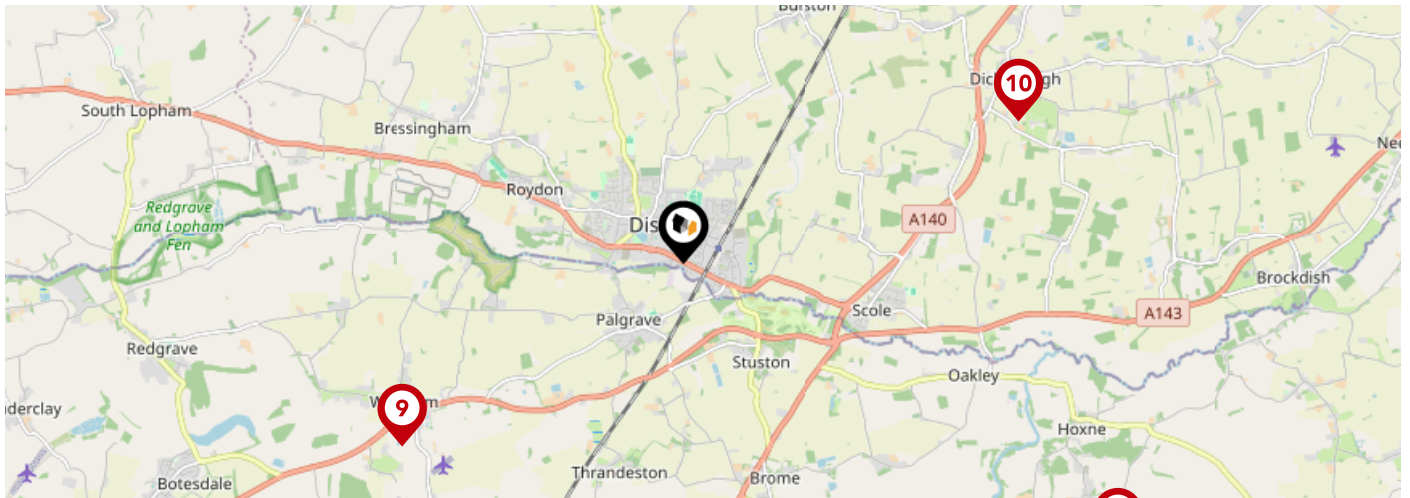

		Nursery	Primary	Secondary	College	Private
	Wortham Primary School Ofsted Rating: Outstanding Pupils: 102 Distance:3.05	<input type="checkbox"/>	<input checked="" type="checkbox"/>	<input type="checkbox"/>	<input type="checkbox"/>	<input type="checkbox"/>
	Dickleburgh Church of England Primary Academy (With Pre-School) Ofsted Rating: Outstanding Pupils: 187 Distance:3.29	<input type="checkbox"/>	<input checked="" type="checkbox"/>	<input type="checkbox"/>	<input type="checkbox"/>	<input type="checkbox"/>
	All Saints Church of England Voluntary Aided Primary School, Winfarthing Ofsted Rating: Good Pupils: 27 Distance:3.53	<input type="checkbox"/>	<input checked="" type="checkbox"/>	<input type="checkbox"/>	<input type="checkbox"/>	<input type="checkbox"/>
	Mellis Church of England Primary School Ofsted Rating: Good Pupils: 154 Distance:3.53	<input type="checkbox"/>	<input checked="" type="checkbox"/>	<input type="checkbox"/>	<input type="checkbox"/>	<input type="checkbox"/>
	Hartismere School Ofsted Rating: Outstanding Pupils: 1063 Distance:3.72	<input type="checkbox"/>	<input type="checkbox"/>	<input checked="" type="checkbox"/>	<input type="checkbox"/>	<input type="checkbox"/>
	St Peter and St Paul Church of England Primary School, Eye Ofsted Rating: Good Pupils: 181 Distance:4.04	<input type="checkbox"/>	<input checked="" type="checkbox"/>	<input type="checkbox"/>	<input type="checkbox"/>	<input type="checkbox"/>
	St Edmund's Primary School Ofsted Rating: Good Pupils: 67 Distance:4.7	<input type="checkbox"/>	<input checked="" type="checkbox"/>	<input type="checkbox"/>	<input type="checkbox"/>	<input type="checkbox"/>
	Tivetshall Community Primary School Ofsted Rating: Good Pupils: 28 Distance:5.06	<input type="checkbox"/>	<input checked="" type="checkbox"/>	<input type="checkbox"/>	<input type="checkbox"/>	<input type="checkbox"/>

Local Area

Masts & Pylons

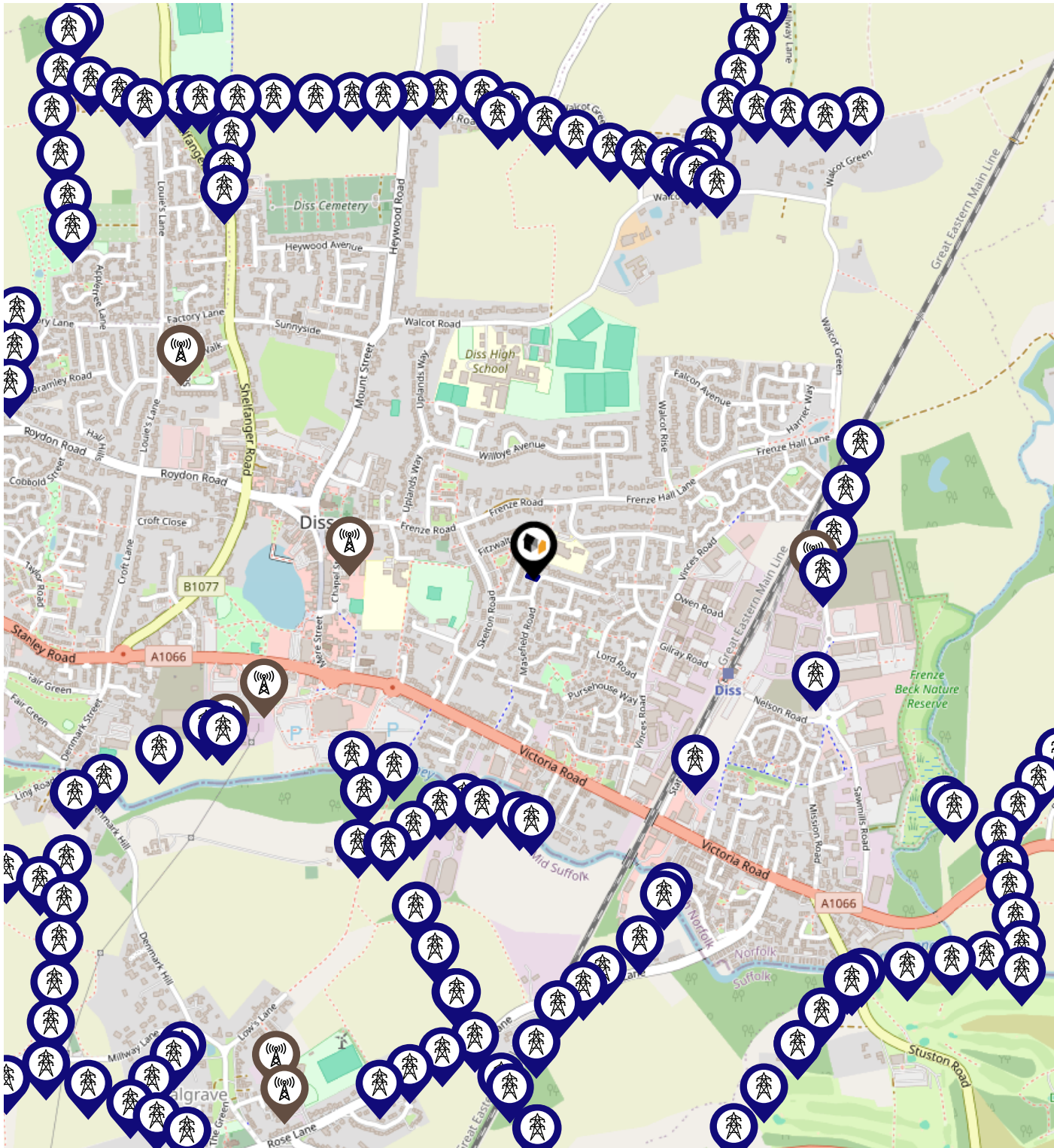

Key:

- Power Pylons
- Communication Masts

Environment

Radon Gas



What is Radon?

Radon is a natural radioactive gas, which enters buildings from the ground. Exposure to high concentrations increases the risk of lung cancer. The UK Health Security Agency (UKHSA) recommends that radon levels should be reduced in homes where the annual average is at or above 200 becquerels per cubic metre (200 Bq/m³).

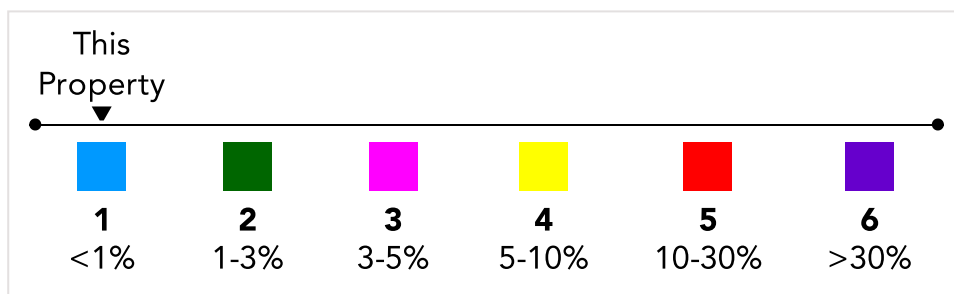
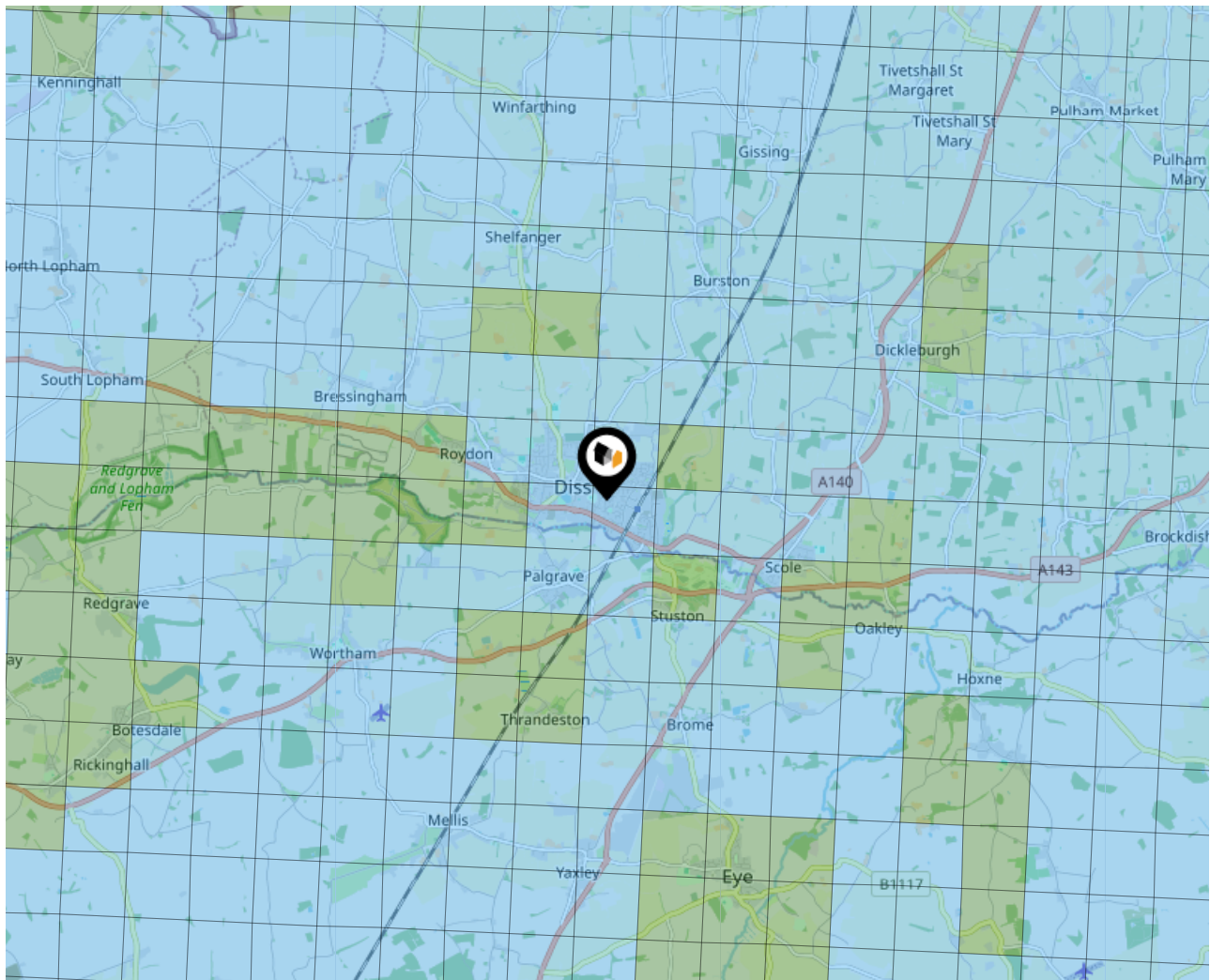

Local Area Road Noise

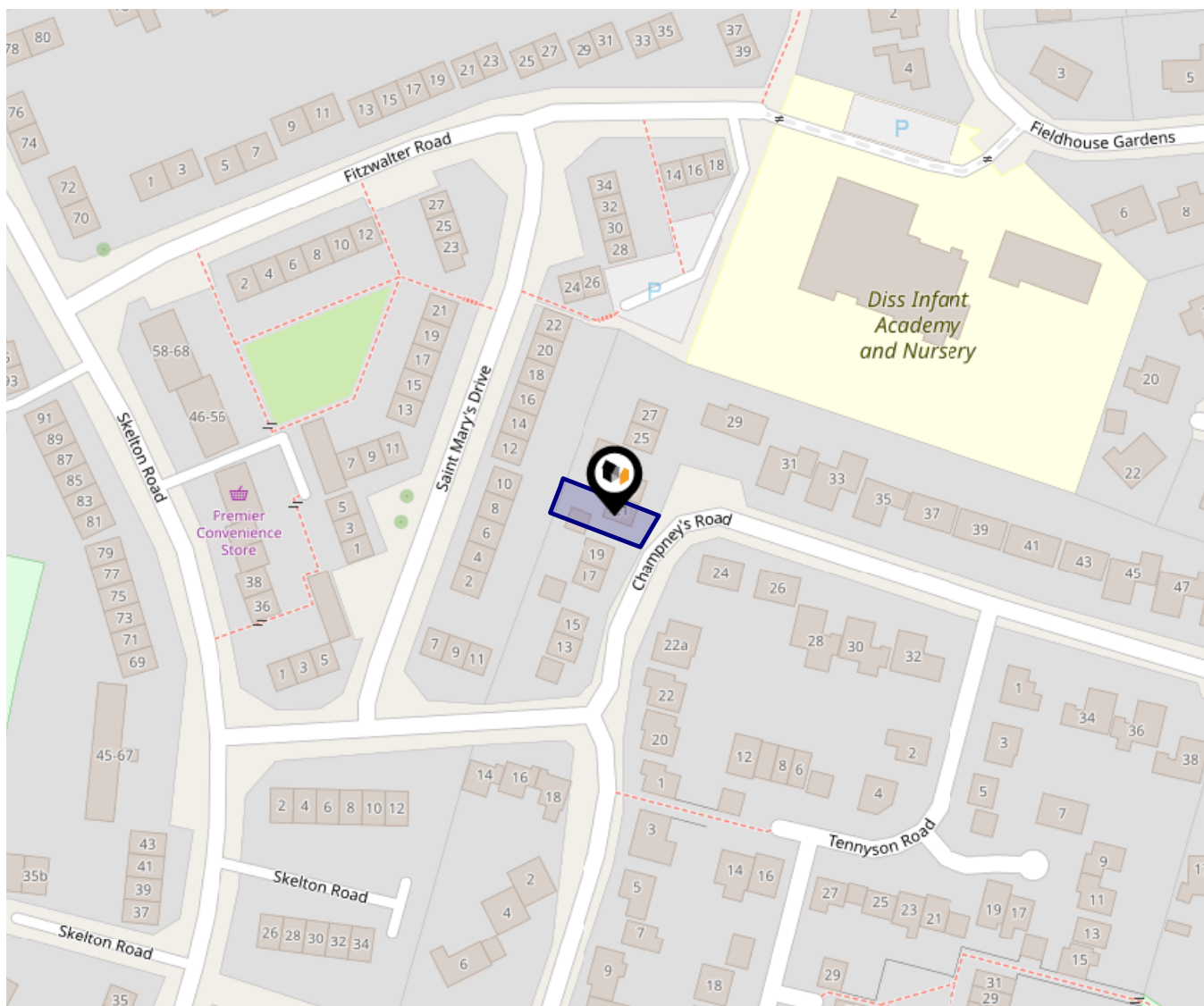

This data indicates the level of noise according to the strategic noise mapping of road sources within areas with a population of at least 100,000 people (agglomerations) and along major traffic routes. This indicates a 24 hour annual average noise level with separate weightings for the evening and night periods.

Noise levels are modelled on a 10m grid at a receptor height of 4m above ground, polygons are then produced by merging neighbouring cells within the following noise classes:

- 75.0+ dB
- 70.0-74.9 dB
- 65.0-69.9 dB
- 60.0-64.9 dB
- 55.0-59.9 dB



Ground Composition for this Address (Surrounding square kilometer zone around property)

Carbon Content:	VARIABLE	Soil Texture:	LOAM TO CLAYEY LOAM, LOCALLY CHALKY
Parent Material Grain:	MIXED (ARGILLIC- RUDACEOUS)	Soil Depth:	DEEP
Soil Group:	MEDIUM TO LIGHT(SILTY) TO HEAVY		

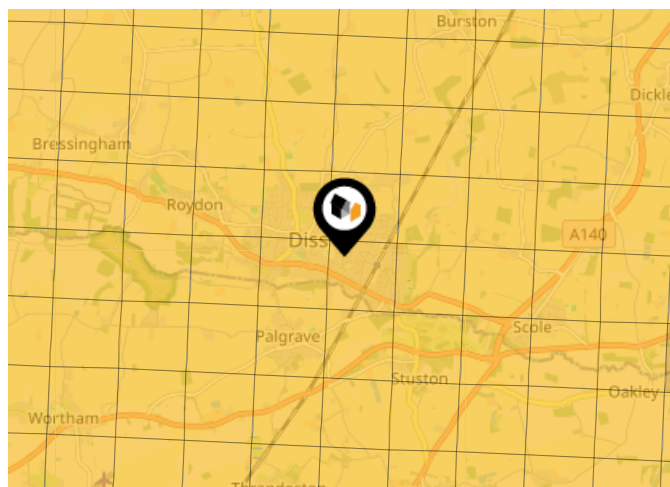

Primary Classifications (Most Common Clay Types)

C/M	Claystone / Mudstone
FPC,S	Floodplain Clay, Sand / Gravel
FC,S	Fluvial Clays & Silts
FC,S,G	Fluvial Clays, Silts, Sands & Gravel
PM/EC	Prequaternary Marine / Estuarine Clay / Silt
QM/EC	Quaternary Marine / Estuarine Clay / Silt
RC	Residual Clay
RC/LL	Residual Clay & Loamy Loess
RC,S	River Clay & Silt
RC,FS	Riverine Clay & Floodplain Sands and Gravel
RC,FL	Riverine Clay & Fluvial Sands and Gravel
TC	Terrace Clay
TC/LL	Terrace Clay & Loamy Loess

Area

Transport (National)

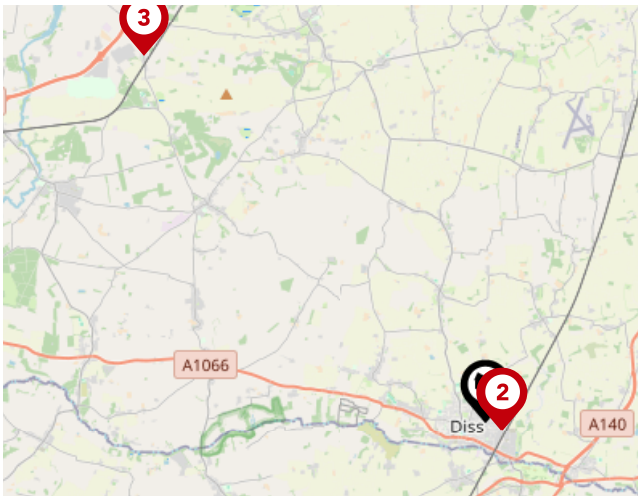

National Rail Stations

Pin	Name	Distance
1	Diss Rail Station	0.33 miles
2	Diss Rail Station	0.33 miles
3	Eccles Road Rail Station	9.06 miles

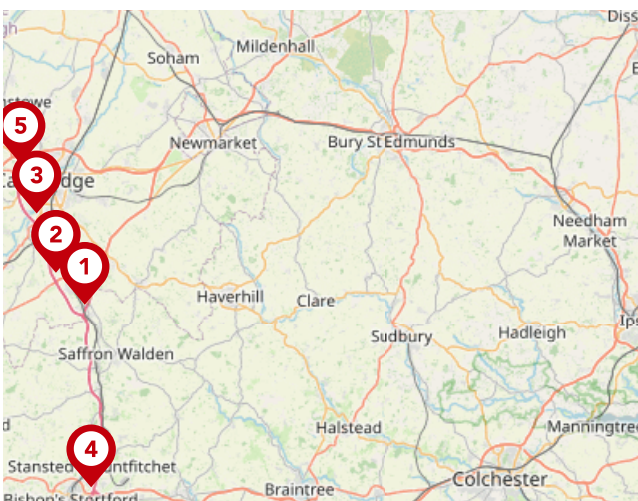

Trunk Roads/Motorways

Pin	Name	Distance
1	M11 J9	44.94 miles
2	M11 J10	45.67 miles
3	M11 J11	45.4 miles
4	M11 J8	52.33 miles
5	M11 J13	45.38 miles



Airports/Helipads

Pin	Name	Distance
1	Norwich International Airport	21.45 miles
2	Southend-on-Sea	58.53 miles
3	Cambridge	41.54 miles
4	Stansted Airport	49.47 miles

Area

Transport (Local)

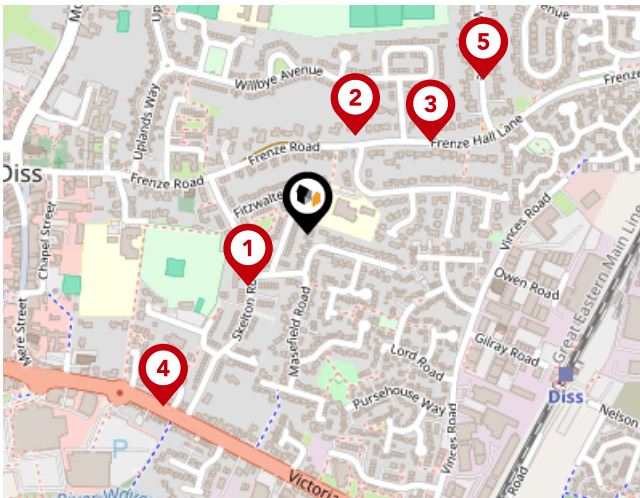

Bus Stops/Stations

Pin	Name	Distance
1	stores	0.09 miles
2	Field House Gardens	0.13 miles
3	Field House Gardens	0.18 miles
4	Whytehead Gardens	0.25 miles
5	Falcon Lane	0.27 miles

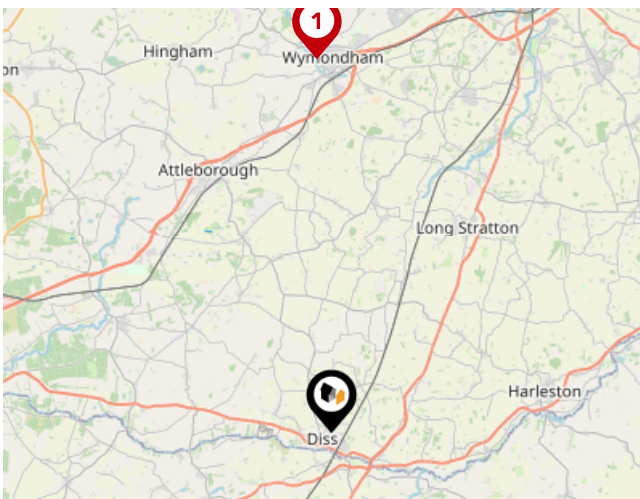

Local Connections

Pin	Name	Distance
1	Wymondham Abbey (Mid Norfolk Railway)	13.46 miles

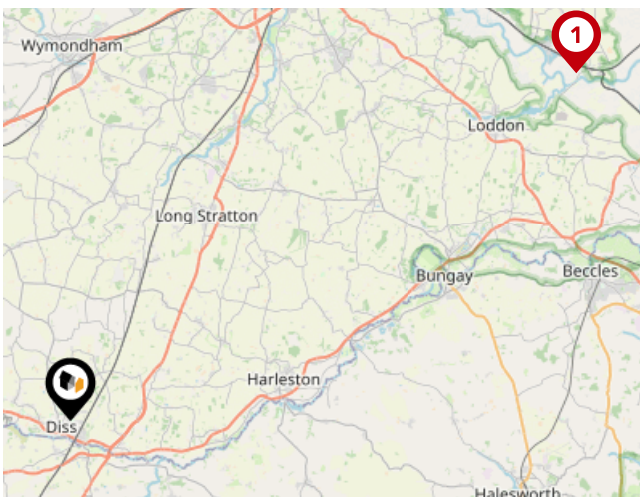

Ferry Terminals

Pin	Name	Distance
1	Reedham Ferry South	22.2 miles



Whittley Parish | Diss

At Whittley Parish, we strive to offer the best experience for all of our valued clients. We employ an experienced team and support our people with the best processes, cutting edge technology, marketing and training. We continue to improve and learn from feedback to strive to be the best at what we do and achieve.

Our proactive approach combined with advertising across four major property portals (Rightmove, Zoopla, onthemarket.com and Primelocation) as well as on social media platforms; coupled with our large database of registered applicants allows us to promote our properties to the widest target market.

With family roots still at the heart of all operations, Alex Parish ensures the original ethos and vision continues to run throughout the company's core, never comprising the personal service its reputation has been built upon.



Testimonial 1



It was a pleasure doing business with the Attleborough branch. Kept to every promise made and acted really fast. Made a stressful time far less stressful.

Testimonial 2



We asked Whittley Parish Diss to carry out a house valuation for us. Alex Parish came to do the job - he was kind, considerate and professional. The process was thorough but yet quick and easy for us. We couldn't ask for more - many thanks.

Testimonial 3



The whole team at Whittley Parish were first class from first introduction to final sale. With lots of estate agents in the Long Stratton area, this is the only one you need to know. Excellent would highly recommend.



[/whittleyparishmanagementltd](#)



[/whittleyparish](#)



[/whittleyparish/?hl=en](#)

Whittley Parish | Diss

Data Quality

We are committed to comprehensive property data being made available upfront to make the home buying and selling process quicker, easier and cheaper. This is why we have partnered with Sprift, the UK's leading supplier of property-specific data.



Contains public sector information licensed under the Open Government License v3.0

The information contained within this report is for general information purposes only.

Sprift Technologies Ltd aggregate this data from a wide variety of sources and while we endeavour to keep the information up to date and correct, we make no representations or warranties of any kind, express or implied, about the completeness, accuracy, reliability, of the information or related graphics contained within this report for any purpose.

Any reliance you place on such information is therefore strictly at your own risk. In no event will we be liable for any loss or damage including without limitation, indirect or consequential loss or damage, or any loss or damage whatsoever arising from loss of data or profits arising out of, or in connection with, the use of this report.



Whittley Parish | Diss

4-6 Market Hill Diss IP22 4JZ

01379640808

admin@whittleyparish.com

<https://www.whittleyparish.com/>

