



ALLDAY
& MILLER



8 Arla Place, Ruislip, HA4 0FF
£385,000

 2  2  1  B

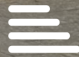

8 Arla Place, Ruislip, HA4 0FF

£385,000

- Beautifully Presented Two Double Bedroom Apartment
- Chain Free
- Allocated Parking
- Walking Distance to Local Amenities
- First Floor
- Two Bathroom
- Short Walk From the Local Underground Station
- Sought After Development
- Private Balcony
- 773 Sq Ft

Description

A spacious and well-appointed two-bedroom home offering bright and comfortable living accommodation throughout. The property briefly comprises a welcoming entrance hall, a generous reception room with space for dining, and a fitted kitchen with access onto a balcony.

There are two well-proportioned bedrooms, with the master bedroom benefiting from an en-suite bathroom, in addition to a separate modern bathroom.

Situation

Emerald Court, Arla Place with Ruislip Manor and Eastcote high street being just a short distance away with its variety of local shops, cafes, coffee shops, takeaways and restaurants. South Ruislip station is just moments away with the Central line making the journey into central London a breeze,. For the motorist A40 leading to London and the Home Counties is also close by. The area is served by a number of highly regarded schools including Lady Bankes primary school and Ruislip high school.



Floor Plans

Graphite Court, Arla Place, Ruislip, HA4

Approximate Area = 773 sq ft / 71.8 sq m

For identification only - Not to scale

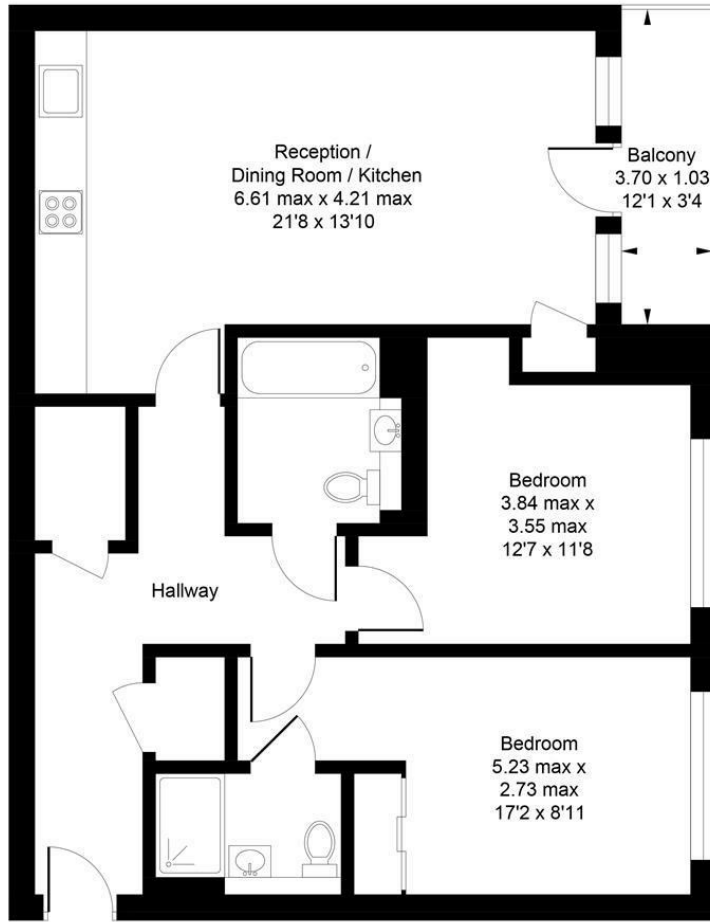

First Floor

Floor plan produced in accordance with RICS Property Measurement Standards incorporating International Property Measurement Standards (IPMS2 Residential). ©Vizion Property Marketing 2026. Produced for Allday & Miller.

ALLDAY & MILLER
estate agents

Area Map

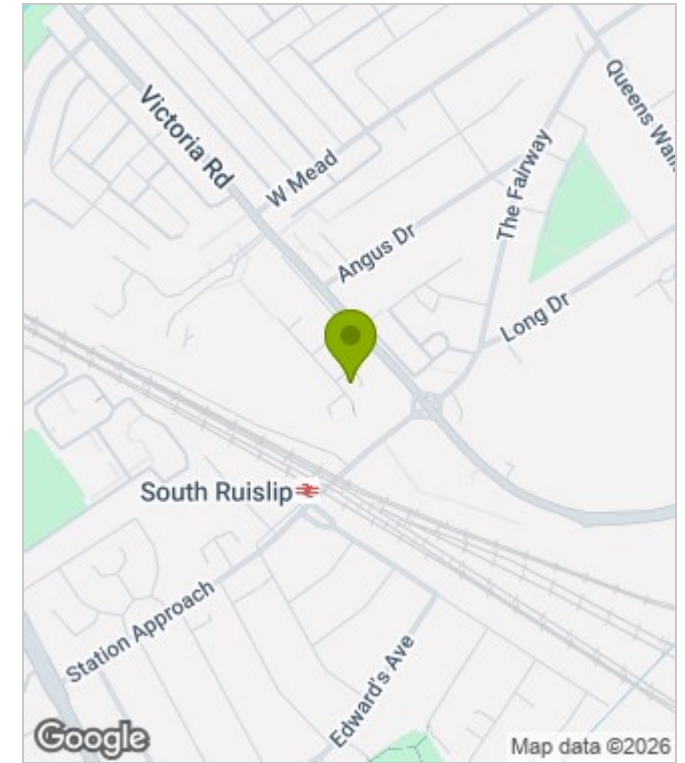

Energy Performance Graph

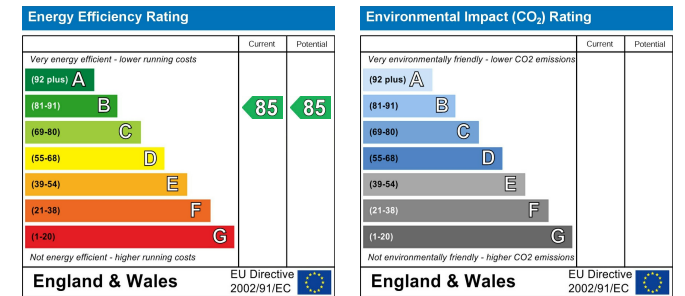

These particulars, whilst believed to be accurate are set out as a general outline only for guidance and do not constitute any part of an offer or contract. Intending purchasers should not rely on them as statements of representation of fact, but must satisfy themselves by inspection or otherwise as to their accuracy. No person in this firm's employment has the authority to make or give any representation or warranty in respect of the property.