

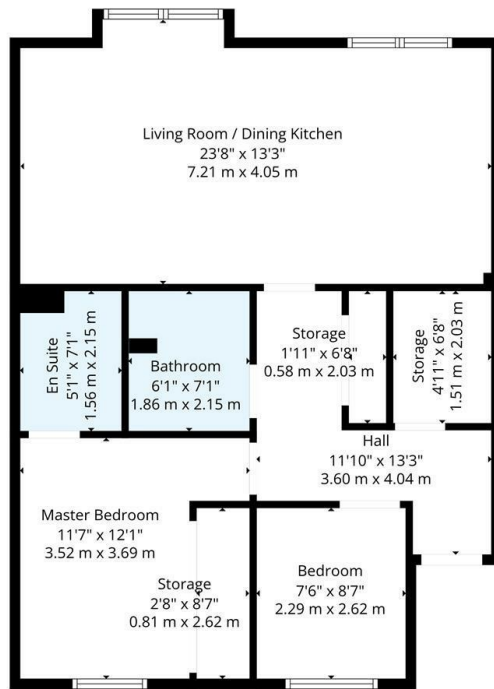

2/3, 17 Seamore Street, Glasgow, G20 6UG

Offers Over £160,000

- Modern second floor apartment
- En-suite shower room off Bedroom one
- Gas central heating and double glazing
- EER Band
- Stylish presentation throughout
- Separate Bathroom
- Security entry
- Two double sized bedrooms
- Open plan kitchen/living room
- Communal gardens



TOTAL: 661 sq. ft, 61 m²
 1st floor: 661 sq. ft, 61 m²
 EXCLUDED AREAS: STORAGE: 71 sq. ft, 6 m², WALLS: 58 sq. ft, 5 m²

Floor Plan Created By Cubicase App. Measurements Deemed Highly Reliable But Not Guaranteed.

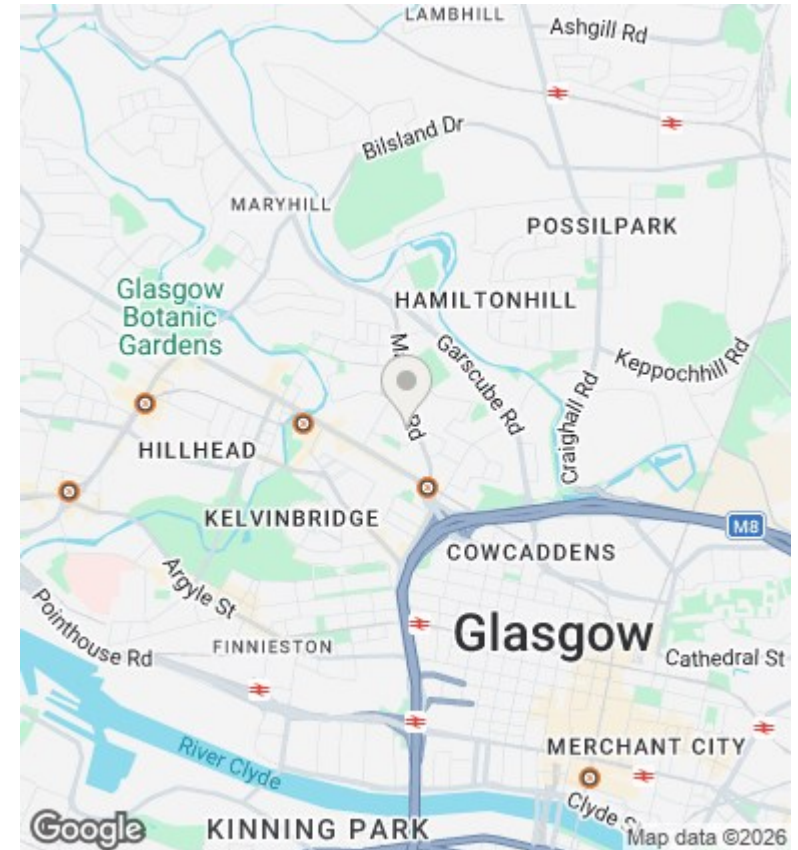

Directions

Viewings

Viewings by arrangement only. Call 01417262111 to make an appointment.

Council Tax Band

EPC Rating:

B

Energy Efficiency Rating		
	Current	Potential
Very energy efficient - lower running costs		
(92 plus) A		
(81-91) B	81	81
(69-80) C		
(55-68) D		
(39-54) E		
(21-38) F		
(1-20) G		
Not energy efficient - higher running costs		
Scotland	EU Directive 2002/91/EC	