



LB

Loporto Browne

— RESIDENTIAL —

Brondesbury Villas, NW6

Guide Price £600,000

🛏️ 2 🍽️ 2 🚗 1



- 697 sq ft and a long lease
- Large south facing private garden
- Spacious and well laid out flat
- Wooden floors
- Oli and Liana are delighted to be instructed on this gorgeous flat, please watch the video and book a viewing.
- 2 bed 2 bath maisonette
- Open plan living room/ kitchen
- Own entrance
- Bay window





Brondesbury Villas
 Approx. Gross Internal Area 697 Sq Ft - 64.75 Sq M

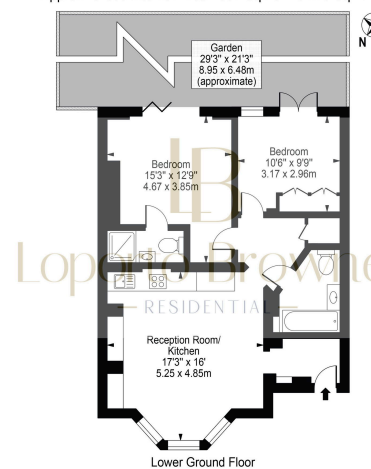

Lower Ground Floor
 For Illustration Purposes Only - Not To Scale
This floor plan should be used as a general guide only and does not constitute an offer or contract. Any intending purchaser or lessee should satisfy themselves by inspection, enquiries and full survey as to the correctness of each statement. Any areas, measurements or distances quoted are approximate and should not be used to value a property or be the basis of any sale or let.

Brondesbury Villas, NW6 – Two Bedroom/ Two Bathroom Garden Flat with Office Pod

Tucked away on the peaceful, tree-lined Brondesbury Villas, this beautifully presented two-bedroom, two-bathroom garden flat offers a blend of charm, space, and practicality, complete with its own private entrance and a sunny south-facing garden. Positioned on the lower ground floor of a handsome period building, this home has been thoughtfully renovated to a high standard, combining contemporary interiors with original character features such as wooden floors and a bay-fronted reception room with period fireplace.

