



Golden Lane Estate, EC1Y

£275,000

A large studio apartment with a separate kitchen and exceptional built-in storage. Positioned on the first floor, the property enjoys gloriously sunny, southerly views directly towards Fann Street Wildlife Garden, the Barbican Centre, and the City. The rear of the property overlooks the tennis courts and swimming pool. Cullum Welch House, a distinctive part of the renowned Golden Lane Estate, known for its mid-century design, was granted Grade II listed status in 1997.

With exceptional transport links, major rail and Underground stations are just minutes away, providing fast, direct routes to all London airports. The property is also ideally located for a seamless 10-15 minute door-to-door commute to key business districts, including Shoreditch, Liverpool Street, and St Paul's.

Features

- Central Location
- South Facing
- First Floor
- Separate Kitchen
- Sold Chain Free
- Golden Lane Estate

Golden Lane Estate, London, EC1Y

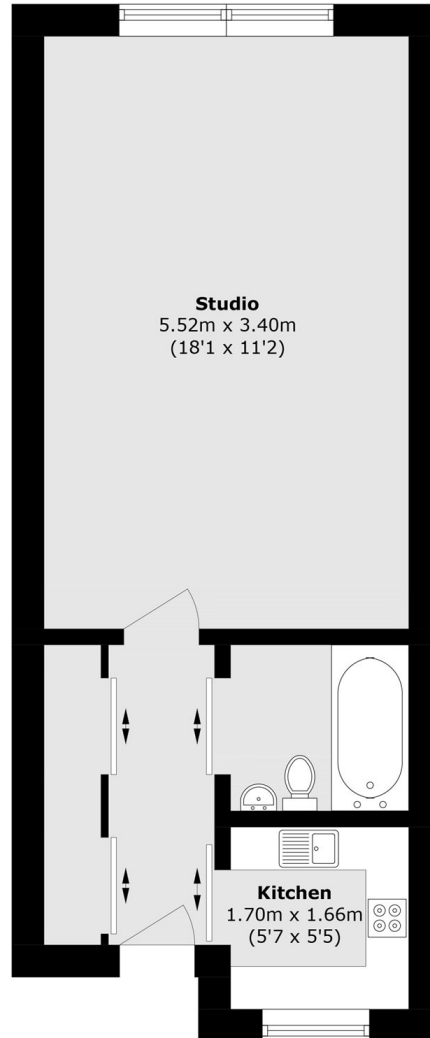

Ground Floor

Total area (approx.): 29.8 sq. m (320.8 sq. ft)