



Domar Close | | Liverpool | L32 9QR

£220,000



Domar Close |
 Liverpool | L32 9QR
 £220,000

Located in the very popular Domar close, Southdene, this delightful dormer bungalow. The property offers a perfect blend of comfort and space for modern family living. With a generous size of 1,115 square feet, this home boasts four well-proportioned bedrooms, providing ample room for family members or guests.

This property has been fully rewired and has been extended to offer a larger kitchen and also introducing a sun room / dining room with bi-fold doors, the third bedroom has also been used as a second lounge, the detached garage can also be converted to a garden room enhancing what is

- 3 double bedrooms
- Cosy reception room
- 1,115 sq ft of space
- Quiet residential area
- En-Suite
- Modern bathroom
- Dormer-Semi style home
- Ideal for families
- Viewing recommended
- A new epc will be available soon.

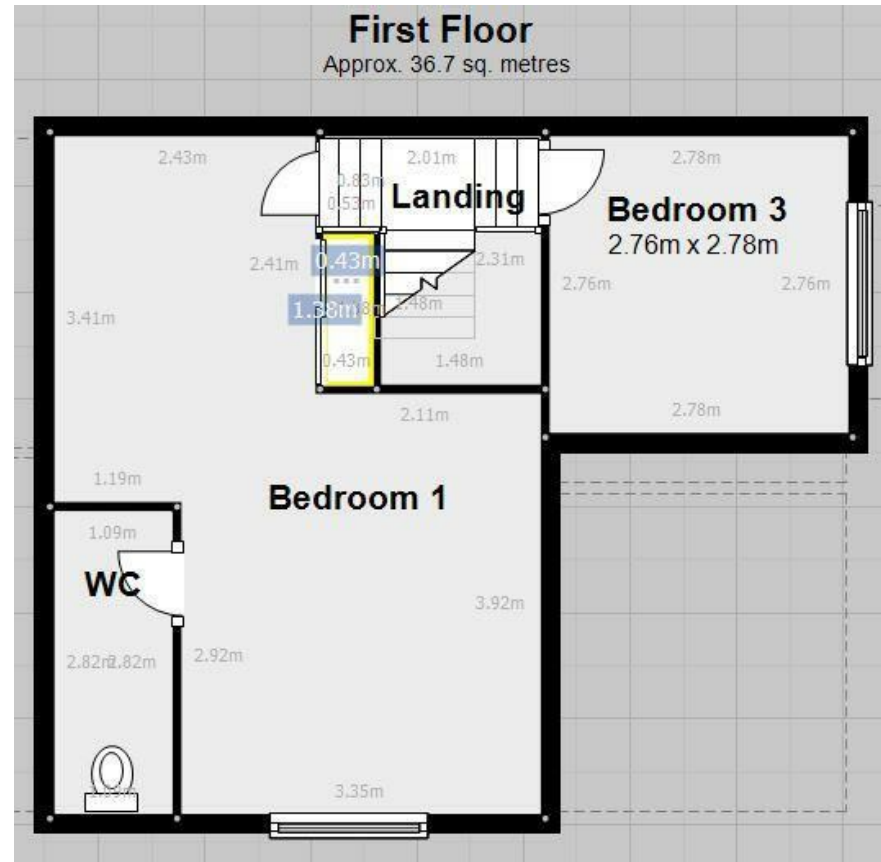

Energy Efficiency Rating		Current	Potential
Very energy efficient - lower running costs			
(92 plus)	A		
(81-91)	B		
(69-80)	C		
(55-68)	D		
(39-54)	E	54	66
(21-38)	F		
(1-20)	G		
Not energy efficient - higher running costs			
England & Wales		EU Directive 2002/91/EC	

Council Tax Band A
 EPC Rating E

14 Park Brow Drive
 Kirkby
 Merseyside
 L32 6QP
 0151 289 8585
 jodie@dorankennedy.co.uk