



Connells

Bourton Road
Banbury



Property Description

Situated on the highly sought-after Hanwell View development, this beautifully presented four-bedroom end-terrace home offers stylish, modern living across three spacious floors.

The welcoming entrance hall sets the tone for the accommodation throughout, with tasteful décor and a light, airy feel. At the heart of the home is a well-appointed kitchen featuring extensive fitted storage and integrated appliances, while the generous living room enjoys attractive views over the rear garden, creating the perfect space for relaxing or entertaining.

The accommodation is arranged over three floors and includes four bedrooms, comprising three doubles and one single. The master bedroom benefits from its own en-suite shower room, complemented by a stylish family bathroom and an additional shower room, providing excellent flexibility for growing families.

Outside, the rear garden has been thoughtfully landscaped to create an attractive and practical outdoor space, ideal for family life, entertaining guests, or simply enjoying the warmer months. A single garage adds valuable storage and parking provision.

The location is particularly appealing for families, with the highly regarded Cherry Fields Primary School just a short walk away and excellent transport links providing convenient access to Banbury town centre the M40, local business parks and surrounding countryside.

Situated on the highly sought-after Hanwell View development, this beautifully presented four-bedroom end-terrace home offers stylish, modern living across three spacious floors.

The welcoming entrance hall sets the tone for the accommodation throughout, with tasteful décor and a light, airy feel. At the heart of the home is a well-appointed kitchen featuring extensive fitted storage and integrated appliances, while the generous living room enjoys attractive views over the rear garden, creating the perfect space for relaxing or entertaining.

The accommodation is arranged over three floors and includes four bedrooms, comprising three doubles and one single. The master bedroom benefits from its own en-suite shower room, complemented by a stylish family bathroom and an additional shower room, providing excellent flexibility for growing families.

Outside, the rear garden has been thoughtfully landscaped to create an attractive and practical outdoor space, ideal for family life, entertaining guests, or simply enjoying the warmer months. A single garage adds valuable storage and parking provision.

The location is particularly appealing for families, with the highly regarded Cherry Fields Primary School just a short walk away and excellent transport links providing convenient access to Banbury town centre the M40, local business parks and surrounding countryside.

Situated on the highly sought-after Hanwell

View development, this beautifully presented four-bedroom end-terrace home offers stylish, modern living across three spacious floors.

The welcoming entrance hall sets the tone for the accommodation throughout, with tasteful décor and a light, airy feel. At the heart of the home is a well-appointed kitchen featuring extensive fitted storage and integrated appliances, while the generous living room enjoys attractive views over the rear garden, creating the perfect space for relaxing or entertaining.

The accommodation is arranged over three floors and includes four bedrooms, comprising three doubles and one single. The master bedroom benefits from its own en-suite shower room, complemented by a stylish family bathroom and an additional shower room, providing excellent flexibility for growing families.

Outside, the rear garden has been thoughtfully landscaped to create an attractive and practical outdoor space, ideal for family life, entertaining guests, or simply enjoying the warmer months. A single garage adds valuable storage and parking provision.

The location is particularly appealing for families, with the highly regarded Cherry Fields Primary School just a short walk away and excellent transport links providing convenient access to Banbury town centre the M40, local business parks and surrounding countryside.

Situated on the highly sought-after Hanwell View development, this beautifully presented four-bedroom end-terrace home offers stylish, modern living across three spacious floors.

The welcoming entrance hall sets the tone for

the accommodation throughout, with tasteful décor and a light, airy feel. At the heart of the home is a well-appointed kitchen featuring extensive fitted storage and integrated appliances, while the generous living room enjoys attractive views over the rear garden, creating the perfect space for relaxing or entertaining.

The accommodation is arranged over three floors and includes four bedrooms, comprising three doubles and one single. The master bedroom benefits from its own en-suite shower room, complemented by a stylish family bathroom and an additional shower room, providing excellent flexibility for growing families.

Outside, the rear garden has been thoughtfully landscaped to create an attractive and practical outdoor space, ideal for family life, entertaining guests, or simply enjoying the warmer months. A single garage adds valuable storage and parking provision.

The location is particularly appealing for families, with the highly regarded Cherry Fields Primary School just a short walk away and excellent transport links providing convenient access to Banbury town centre the M40, local business parks and surrounding countryside.







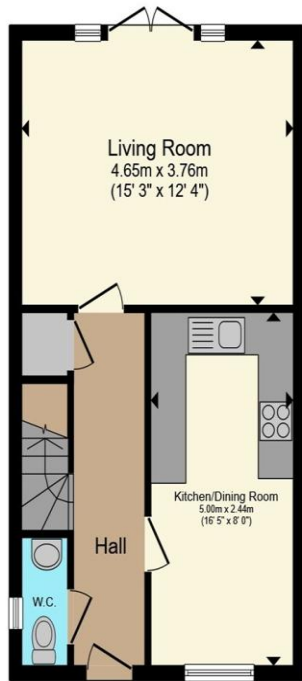

Ground Floor

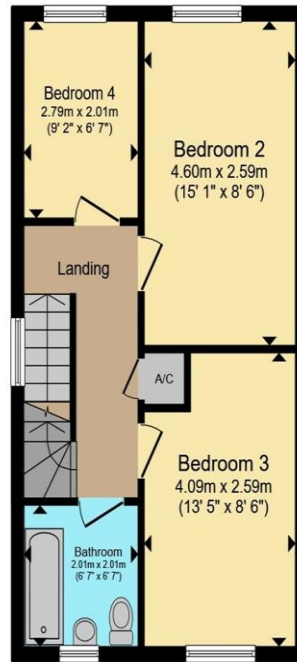

First Floor

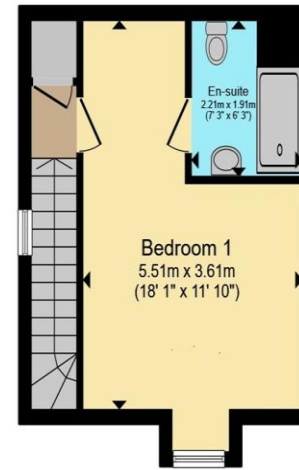

Second Floor

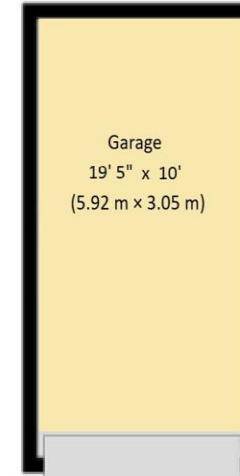

Total floor area 108.6 m² (1,169 sq.ft.) approx

This floor plan is for illustrative purposes only. It is not drawn to scale. Any measurements, floor areas (including any total floor area), openings and orientation are approximate. No details are guaranteed, they cannot be relied upon for any purpose and they do not form part of any agreement. No liability is taken for any error, omission or misstatement. A party must rely upon its own inspection(s). Powered by www.propertybox.io



To view this property please contact Connells on

T 01295 268 101
E banbury@connells.co.uk

33 Bridge Street
BANBURY OX16 5PN

EPC Rating: B Council Tax
Band: D

Tenure: Freehold

view this property online connells.co.uk/Property/BAN310132



1. MONEY LAUNDERING REGULATIONS Intending purchasers will be asked to produce identification documentation at a later stage and we would ask for your co-operation in order that there will be no delay in agreeing the sale. 2. These particulars do not constitute part or all of an offer or contract. 3. The measurements indicated are supplied for guidance only and as such must be considered incorrect. Potential buyers are advised to recheck measurements before committing to any expense. 4. We have not tested any apparatus, equipment, fixtures, fittings or services and it is in the buyers interest to check the working condition of any appliances.

Connells Residential is registered in England and Wales under company number 1489613, Registered Office is Cumbria House, 16-20 Hockliffe Street, Leighton Buzzard, Bedfordshire, LU7 1GN. VAT Registration Number is 500 2481 05.

See all our properties at www.connells.co.uk | www.rightmove.co.uk | www.zoopla.co.uk

Property Ref: BAN310132 - 0003