



Wesley Close, Wanstrow, Shepton Mallet BA4 4TA

welcome to

Wesley Close, Wanstrow Shepton Mallet

A charming two-bedroom end-of-terrace bungalow, beautifully positioned in the highly sought-after village of Wanstrow.

This well-presented home offers a spacious lounge/diner, complete with a feature fireplace and ample room for a dining table and chairs. French doors open into the bright conservatory, which in turn leads out to the private rear garden, creating a lovely flow of indoor-outdoor living.

The kitchen, accessed from the main living area, is fitted with stylish wall and base units and includes integrated appliances such as an oven, four-ring hob, extractor hood and under-counter fridge.

Both bedrooms are generously sized, with the master bedroom benefiting from a fully tiled wet room. A separate modern family bathroom adds further practicality.

To the rear of the property, a useful laundry room houses the washing machine, tumble dryer and oil boiler. The enclosed rear garden features a well-positioned patio area and established planting and shrubs, offering a peaceful and private outdoor space. A side gate provides access to the front garden, which is also attractively planted and includes a gentle sloped pathway to the front door — ideal for wheelchair or pushchair access.



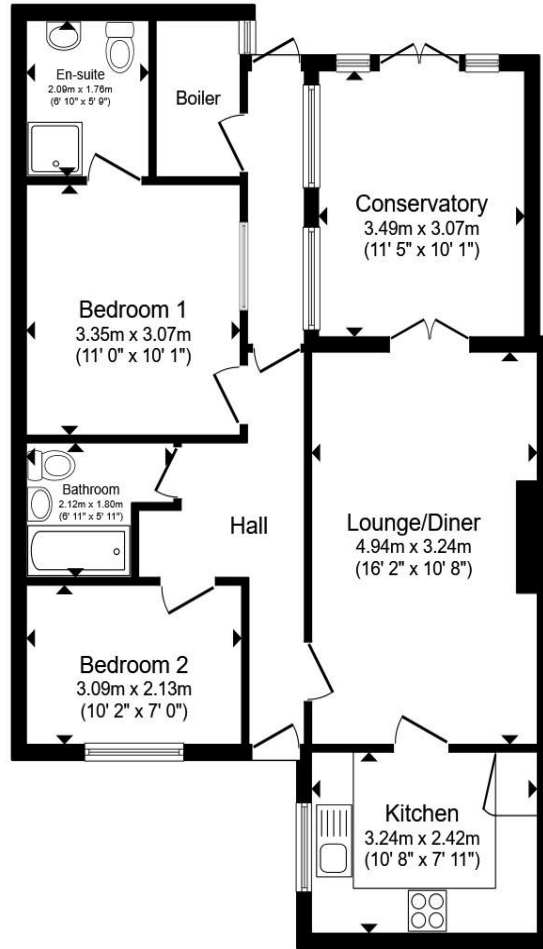

Hallway

Kitchen

10' 8" x 7' 11" (3.25m x 2.41m)

Lounge/Diner

16' 2" x 10' 8" (4.93m x 3.25m)

Conservatory

11' 5" x 10' 1" (3.48m x 3.07m)

Bedroom One

11' x 10' 1" (3.35m x 3.07m)

En-Suite Wet Room

Bedroom Two

10' 2" x 7' (3.10m x 2.13m)

Bathroom

Boiler/Utility Room

Front Garden

Rear Garden

Total floor area 75.5 m² (813 sq.ft.) approx

This floor plan is for illustrative purposes only. It is not drawn to scale. Any measurements, floor areas (including any total floor area), openings and orientation are approximate. No details are guaranteed, they cannot be relied upon for any purpose and they do not form part of any agreement. No liability is taken for any error, omission or misstatement. A party must rely upon its own inspection(s). Powered by www.propertybox.io

welcome to

Wesley Close, Wanstrow Shepton Mallet

- Two Generous Bedrooms
- Master with En-Suite Shower Room
- Modern Fitted Kitchen
- Spacious Lounge/Diner
- Bright Conservatory

Tenure: Freehold EPC Rating: D
Council Tax Band: A

offers in excess of
£270,000



Please note the marker reflects the
postcode not the actual property

view this property online allenandharris.co.uk/Property/FRO112000



Property Ref:
FRO112000 - 0004

1. MONEY LAUNDERING REGULATIONS Intending purchasers will be asked to produce identification documentation at a later stage and we would ask for your co-operation in order that there is no delay in agreeing the sale. 2. These particulars do not constitute part or all of an offer or contract. 3. The measurements indicated are supplied for guidance only and as such must be considered incorrect. Potential buyers are advised to recheck measurements before committing to any expense. 4. We have not tested any apparatus, equipment, fixtures or services and it is in the buyers interest to check the working condition of any appliances. 5. Where an EPC, or a Home Report (Scotland only) is held for this property, it is available for inspection at the branch by appointment. If you require a printed version of a Home Report, you will need to pay a reasonable production charge reflecting printing and other costs. 6. We are not able to offer an opinion either written or verbal on the content of these reports and this must be obtained from your legal representative. 7. Whilst we take care in preparing these reports, a buyer should ensure that his/her legal representative confirms as soon as possible all matters relating to title including the extent and boundaries of the property and other important matters before exchange of contracts.

 allen & harris



01373 462999



Frome@allenandharris.co.uk



9 The Bridge, FROME, Somerset, BA11 1AR



allenandharris.co.uk