



35 Deykin Road,  
Offers Over £580,000

6 3 2



- Guide Price £580,000 - £600,000
- Stunning kitchen, dining & family space
- Three bathrooms and two ensuites
- Double garage gym and rear parking
- No Onward Chain
- Six-bedroom family home totalling approx 2351sqft
- Living room and conservatory
- Dressing room/home office
- Prime Darwin Park location



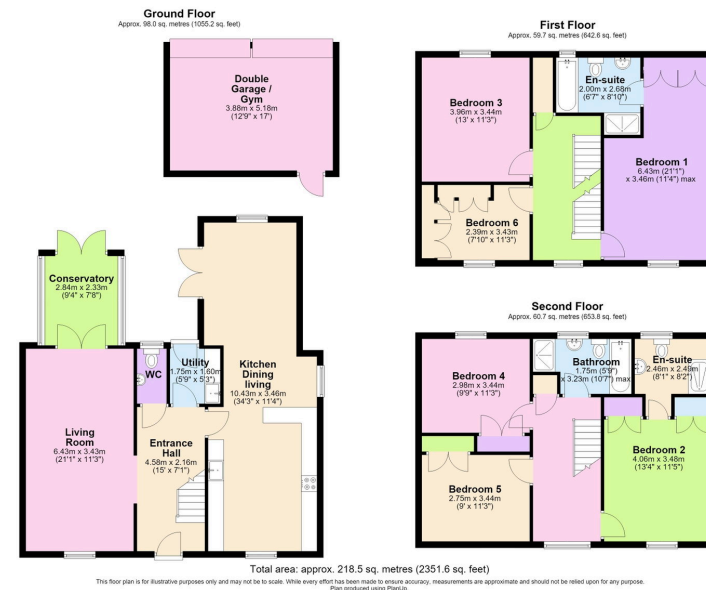

Some homes give you more space. Others give you a better lifestyle. This Home somehow manages both. Set over three impressive floors and offering up to six bedrooms, three bathrooms and multiple living spaces, this is a home designed around modern family life. Beautifully finished throughout, the standout kitchen, dining and family space forms the heart of the home, whilst outside you'll find a low-maintenance garden and a double garage currently set up as a gym. All of this sits on Darwin Park, where morning walks past Lichfield Cathedral, trips into the city centre and a stroll to Waitrose become part of everyday life.

