



## Granville Gardens, W5

£750,000

A ground floor two double bedroom and two bathroom period conversion offered to the market with no onward chain. Both the main kitchen/living area and the principle bedroom open up onto a decked and lawn laid rear garden with partially insulated storage area. There is a private entrance to the flat, and a share of the freehold.

Located adjacent to Ealing common tube station with the popular Piccadilly Line. The green space of Ealing common is a short walk away. Ealing Broadway for Elizabeth, Central and District lines is under a mile. There is a wide range of local shops, café's and amenities located on the doorstep, along Station Parade.

### Features

- Two Bedrooms
- Two Bathrooms
- Private Garden
- Share Of Freehold
- No Onward Chain
- Next To Station

# Granville Gardens, London, W5

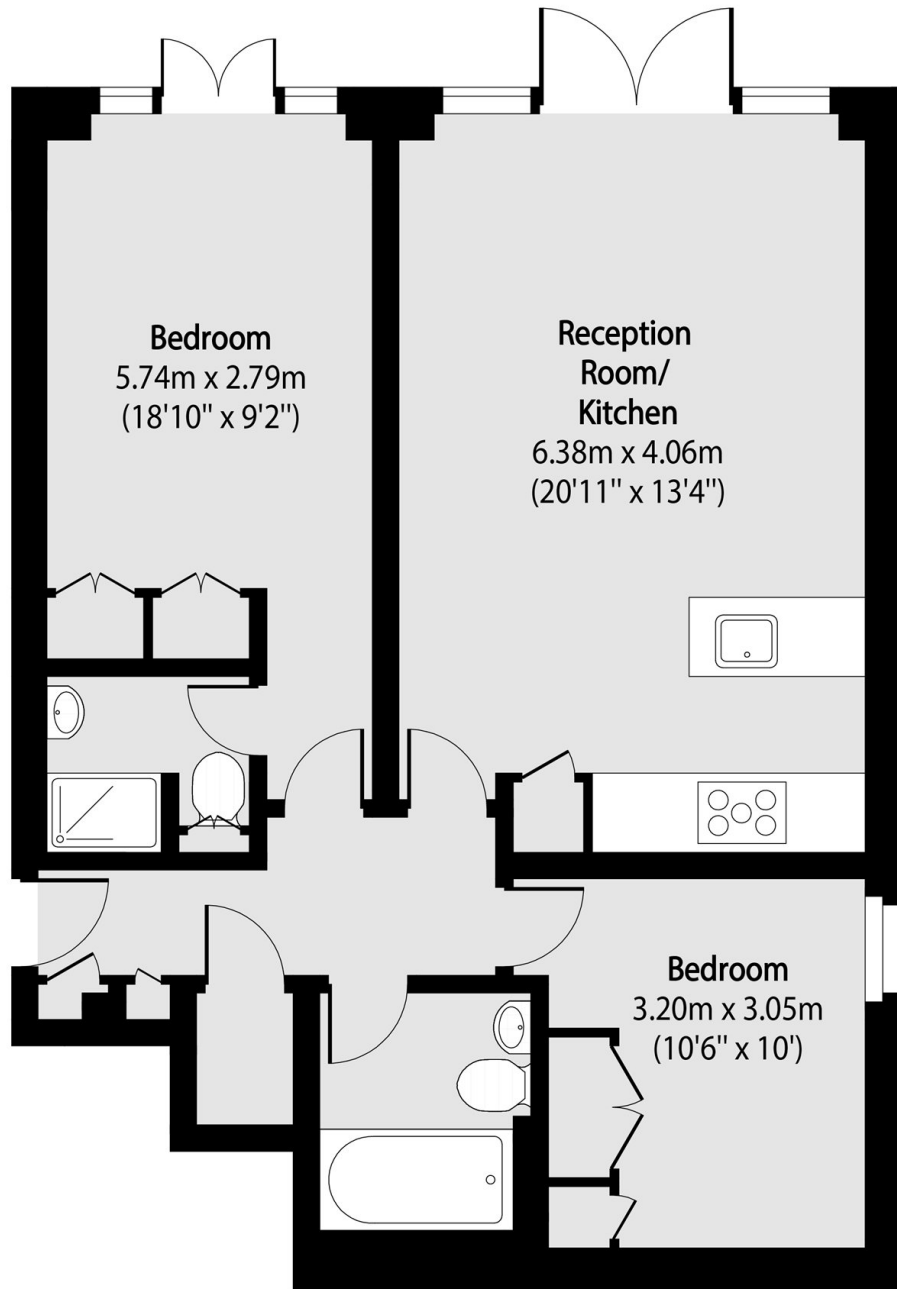

Total area (approx): 65.49 sq m (705 sq. ft)