



6, Northumberland Place, Greenfields, Shrewsbury, SY1 2RL

£750 Per Month



6, Northumberland Place, Greenfields, Shrewsbury, SY1 2RL

**£750 Per Month**

VIRTUAL TOUR AVAILABLE: Superb modern, one bedroom end of terrace house occupying a quiet and private cul-de-sac position within a popular area a short walk from local amenities and town centre. Driveway parking for two cars.

Available: 15/06/26

## Description

Comprising: Modern open plan kitchen with dining and living area, stairs to double bedroom, re-fitted en-suite shower room, gas fired central heating, rear garden, double glazing, private parking for two cars. EPC D

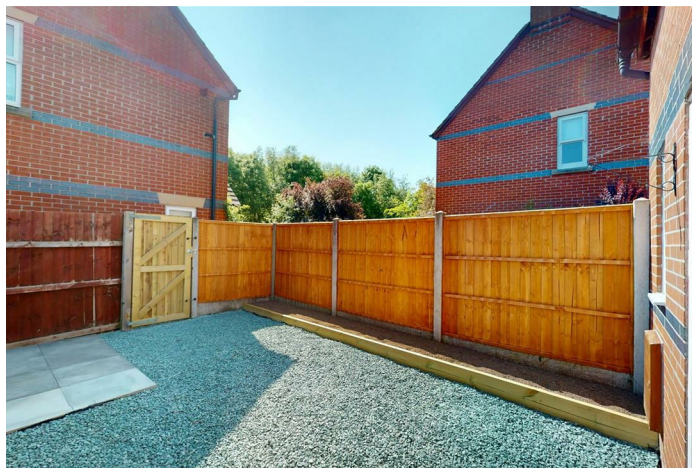

Unfurnished

Council Tax Band: A

Available: 15th June 2026

EPC: D

## Floor Plans

### Ground Floor

Approx. 22.9 sq. metres (246.8 sq. feet)

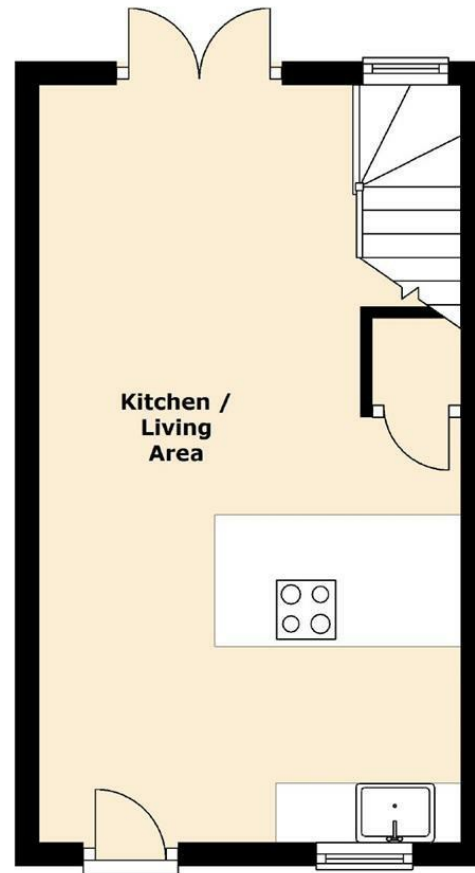

### First Floor

Approx. 12.1 sq. metres (130.4 sq. feet)

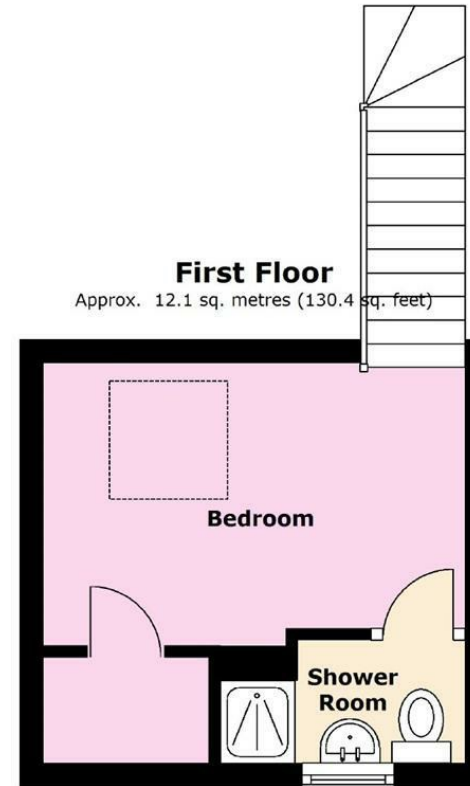

Total area: approx. 35.0 sq. metres (377.2 sq. feet)

We accept no responsibility for any mistake or inaccuracy contained within the floorplan. The floorplan is provided as a guide only and should be taken as an illustration only. The measurements, contents and positioning are approximations only and provided as a guidance tool and not an exact replication of the property.

Plan produced using PlanUp.

These particulars, whilst believed to be accurate are set out as a general outline only for guidance and do not constitute any part of an offer or contract. Intending purchasers should not rely on them as statements of representation of fact, but must satisfy themselves by inspection or otherwise as to their accuracy. No person in this firm's employment has the authority to make or give any representation or warranty in respect of the property.