

Pius Drove, Upwell, Wisbech, PE14 9AL

Non-Standard Construction Dwelling - Generous Plot - Field Views To Rear - No Upward Chain -
Must View (01354) 696700

£80,000



Porch
2.06m (6'9") x 0.87m (2'10")
Double glazed stable door to front, windows to front and both sides, and door to:

Kitchen/Breakfast Room
4.83m (15'10") x 3.39m (11'1")
Base units, stainless steel sink, radiator and two windows to rear.

WC
1.68m (5'6") x 0.85m (2'9")
WC and window to rear.

Lounge
4.09m (13'5") x 3.42m (11'3")
Two windows to front and radiator.

Hall
3.56m (11'8") x 0.96m (3'2")
Window to front, radiator and opening to:

Hall
3.52m (11'7") x 0.98m (3'3")
Window to front, radiator and door to:

Bedroom 1
3.41m (11'2") x 2.30m (7'7")
Window to front and radiator.

Bedroom 2
3.56m (11'8") x 2.27m (7'5")
Window to hall.

Bedroom 3
3.52m (11'7") x 2.28m (7'6")
Window to hall.

Show er Room
1.73m (5'8") x 1.65m (5'5")
Fitted with three-piece suite comprising a shower, wash hand basin, low-level WC and radiator.

Garden Room
2.83m (9'3") x 2.05m (6'9")
Door to front, windows to side and rear and electric heater.

Outside
This nonstandard construction dwelling is situated on a generous plot with field views to the rear.

EPC - TBC

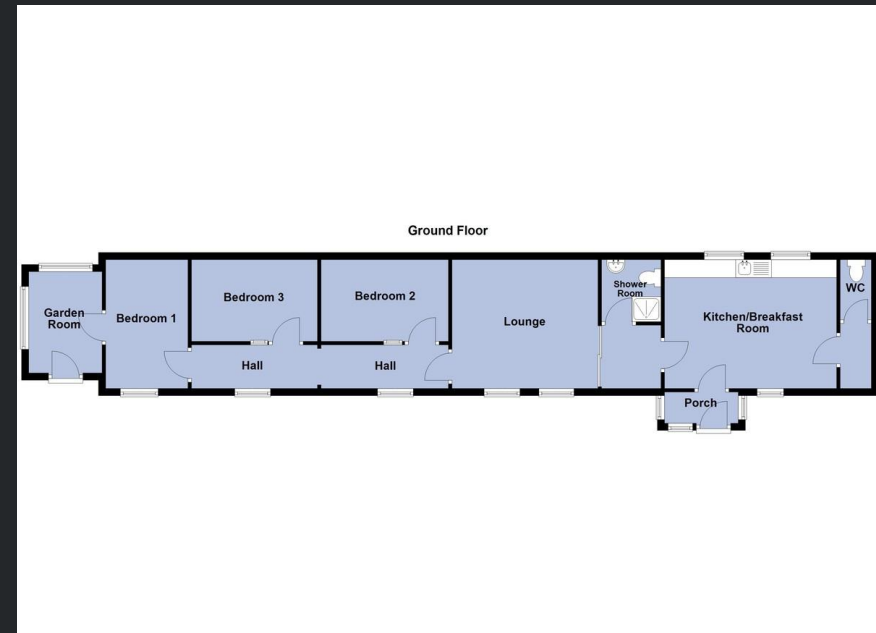

Call to arrange a viewing **01354 696700** **T Payne & Co**
SALES & LETTINGS

Agents Notes: Whilst every care has been taken to prepare these sales particulars, they are for guidance purposes only. All measurements are approximate and for general guidance purposes only and whilst every care has been taken to ensure their accuracy, they should not be relied upon and potential buyers are advised to recheck the measurements.