



BRITISH  
PROPERTY  
AWARDS

2024

★★★★★

GOLD WINNER

ESTATE AGENT  
IN DEREHAM



**homeworks**  
estate agent



54 Swaffham Road  
Dereham, NR19 2DL

☎ (01362) 65 44 44  
✉ [sales@homeworks-uk.com](mailto:sales@homeworks-uk.com)  
🌐 [www.homeworks-uk.com](http://www.homeworks-uk.com)



# The Street, Bawdeswell, Dereham, NR20 4RT

£500,000

5 3 3





- \*\* DETACHED BUNGALOW WITH DETACHED ANNEX & DOUBLE GARAGE WITH WORKSHOP \*\*
- 13'11 DINING ROOM
- FAMILY BATHROOM
- GENEROUS PLOT
- FOUR DOUBLE BEDROOMS
- 20'10 LOUNGE
- 20'7 KITCHEN / BREAKFAST ROOM
- ANNEX THAT PRODUCES CIRCA 25K PA
- VIEWING IS HIGHLY ADVISED!!!







GROUND FLOOR  
2204 sq.ft. (204.7 sq.m.) approx.

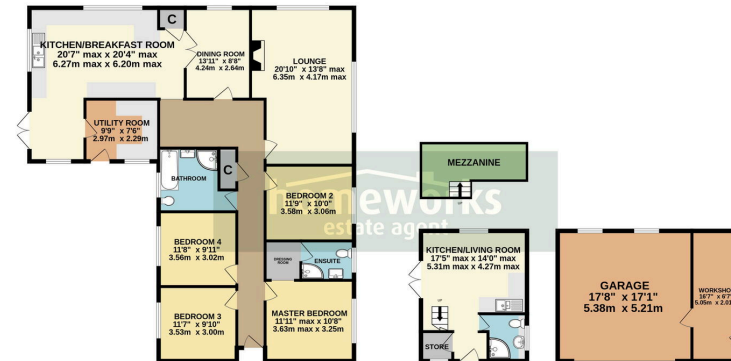

TOTAL FLOOR AREA: 2204 sq ft (204.7 sq m.) approx.

Whilst every attempt has been made to ensure the accuracy of the floorplan contained herein, measurements of doors, windows, rooms and any other items are approximate and no responsibility is taken for any error, omission or mis-statement. This plan is for illustrative purposes only and should be used as such for any prospective purchaser. The services, systems and appliances shown have not been tested and no guarantee as to their operability or efficiency can be given.  
Made with Homestyler ©2023

**\*\* DETACHED BUNGALOW WITH DETACHED ANNEX & DOUBLE GARAGE WITH WORKSHOP \*\* FOUR DOUBLE BEDROOMS | EN-SUITE | 20'10 LOUNGE | 13'11 DINING ROOM | 20'7 KITCHEN / BREAKFAST ROOM | FAMILY BATHROOM | ANNEX THAT PRODUCES CIRCA 25K PA | .27 ACRE PLOT | VIEWING IS HIGHLY ADVISED!!!**



C AMOS MNAEA Managing Director

VAT no. 185 328 683

zoopla

rightmove

Homeworks (Dereham) Ltd. Registration Number (08951563) incorporated in England. Registered Office: 45a Norwich Road, Dereham, Norfolk, England, NR20 3AS