



Terraced Villa

10 Treesbank, Kilwinning, KA13 6LY



taylorandhenderson.co.uk

2		3		2		C	EPC rating
---	--	---	--	---	--	---	----------------------



10 Treesbank

Taylor & Henderson are delighted to bring to the market this rarely available mid terrace villa located within a popular residential area. The accommodation comprises entrance vestibule with generous storage cupboard, hallway with open staircase, w/c, open plan modern fitted dining kitchen with patio doors to the rear garden, lounge all on the ground floor. 2 double bedrooms with mirrored fitted wardrobes, single bedroom and modern fitted bathroom with over bath shower. The property further benefits from gas central heating, double glazing and generous storage. The front garden is paved with a gate and brick wall, the enclosed rear garden has a decked patio seating area, paved & chipped section with an artificial lawn beyond. Kilwinning offers an array of local amenities to include primary and secondary schools, bus routes, local shops. It is also within easy access of road and rail links to Glasgow in the north, all west coast towns train including Ayr to the south and thus is well located for travel throughout west central Scotland.

Measurements

Hall / Landing	
Lounge	21'4 x 11'2
WC	ss
Kitchen Dining Room	17'5 x 9'6
Bathroom	6'3 x 5'1
Bedroom 1	13'1 x 10'1
Bedroom 2	10'1 x 10'2
Bedroom 3	10'2 x 7'1



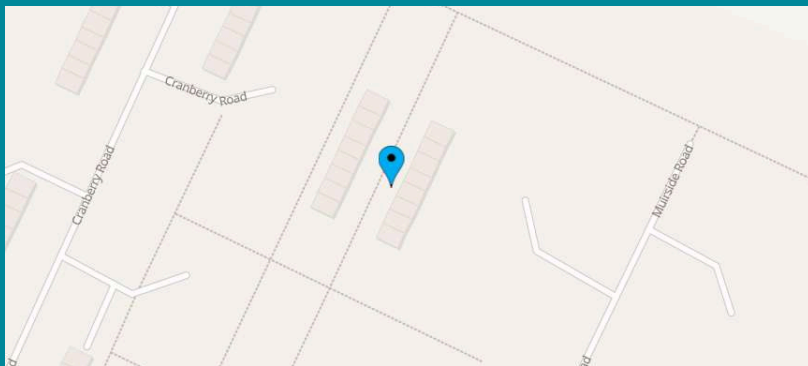

Viewing
Through solicitors on 01294 606700

Email
property@taylorandhenderson.co.uk

Reference
E508912

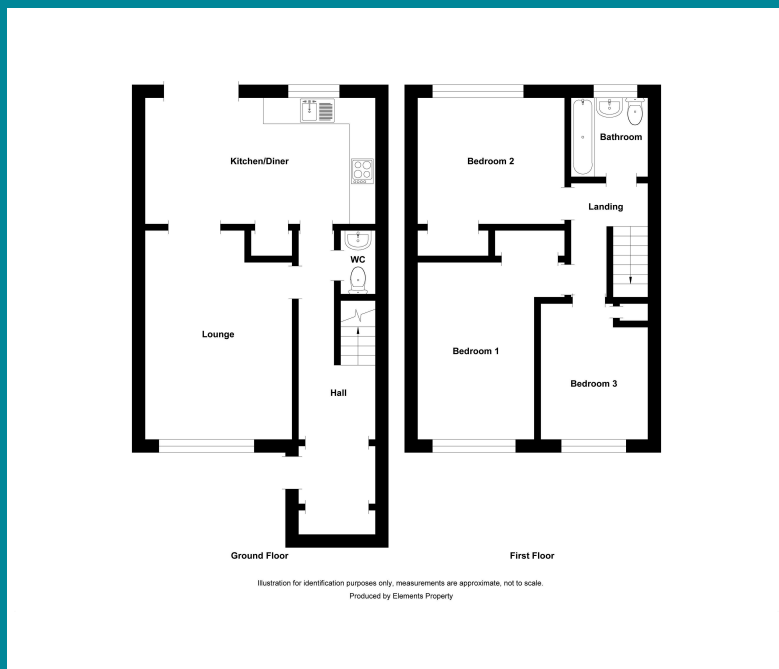

Our Offices

51 Hamilton Street, Saltcoats, Ayrshire, KA21 5DX
Tel: 01294 606700 & Fax: 01294 464827

22 Bank Street, Irvine, Ayrshire, KA12 0AG
Tel: 01294 278306 & Fax: 01294 272886

83 Main Street, Kilwinning, Ayrshire, KA13 6AN
Tel: 01294 557506 & Fax: 01294 558552
Email: property@taylorandhenderson.co.uk

espc rightmove  ZOOPLA  OnTheMarket



DISCLAIMER: Whilst we endeavour to make these particulars as accurate as possible, they do not form part of any contract of offer, nor are they guaranteed. Measurements are approximate and in most cases are taken with a digital/sonic-measuring device and are taken to the widest point. We have not tested the electricity, gas or water services or any appliances. Photographs are reproduced for general information and it must not be inferred that any item is included for sale with the property. If there is any part of this that you find misleading or simply wish clarification on any point, please contact our office immediately when we will endeavour to assist you in any way possible.