

oakheart



£350,000

Asking Price

Chatsworth Road, West Mersea

Located on the popular Chatsworth Road, this two-bedroom detached bungalow offers well-balanced accommodation and excellent potential for buyers seeking single-level living. The property is offered with no onward chain, making it an appealing option for those looking for a straightforward and hassle-free move.

The bungalow benefits from off-road parking, providing convenient access. Inside, the accommodation includes a

spacious lounge that serves as the heart of the home, offering a comfortable and bright living space. The kitchen is practical in layout, with a good range of units and work surfaces, and provides scope for updating to suit modern tastes.

There are two well-proportioned double bedrooms, both offering plenty of space for furnishings and flexibility for a variety of uses. The bathroom is fitted with standard fixtures and is easily accessible from all areas of the home.

To the rear, the property enjoys a west-facing garden, ideal for taking advantage of afternoon and evening sunshine. This outdoor space offers a pleasant setting for relaxing or entertaining and has the potential to be further enhanced.

Overall, this detached bungalow represents a great opportunity to acquire a home in a desirable location, with the added benefit of no onward chain and the potential to personalise to individual preference









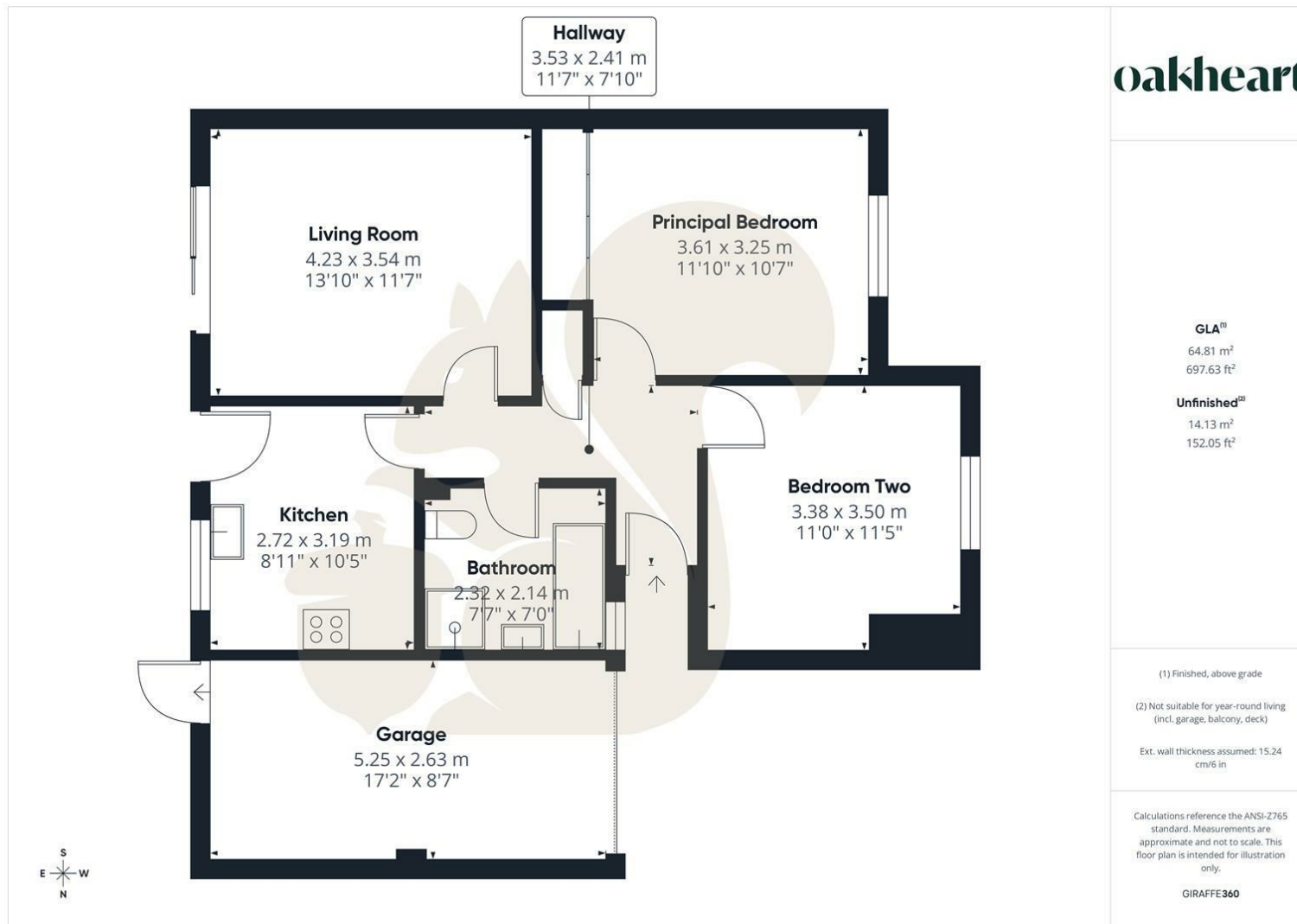

Local Authority:

Tenure:
Freehold

Council Tax Band:
D

Energy Efficiency Rating

	Current	Potential
<i>Very energy efficient - lower running costs</i>		
(92 plus) A		
(81-91) B		
(69-80) C		
(55-68) D		
(39-54) E		
(21-38) F		
(1-20) G		
<i>Not energy efficient - higher running costs</i>		
England & Wales	EU Directive 2002/91/EC 	

Agents Note: Whilst every care has been taken to prepare these particulars, they are for guidance purposes only. All measurements are approximate and are for general guidance purposes only and whilst every care has been taken to ensure their accuracy, they should not be relied upon.