



Paradise Orchard, Aylesbury HP18 0EX



welcome to

Paradise Orchard, Aylesbury

NO UPPER CHAIN A well-presented and spacious two-bedroom top floor apartment being situated within walking distance of the local railway station and being on the popular Berryfields development. The property features double glazing, gas heating system with radiators, entrance hall, open plan lounge/dining/kitchen, two bedrooms, bathroom, gated parking area. Internal viewing is highly recommended to fully appreciate this top floor apartment.



Accommodation Comprises

Entrance Hall

Lounge/Dining/Kitchen

22' 8" x 11' 6" (6.91m x 3.51m)

Bedroom One

11' 5" x 9' 11" (3.48m x 3.02m)

Bedroom Two

11' 5" x 8' 4" (3.48m x 2.54m)

Bathroom

Outside

Allocated Parking

Agents Note

The sellers have confirmed there is also an assigned bike storage as well as access to a loft space from inside the property.

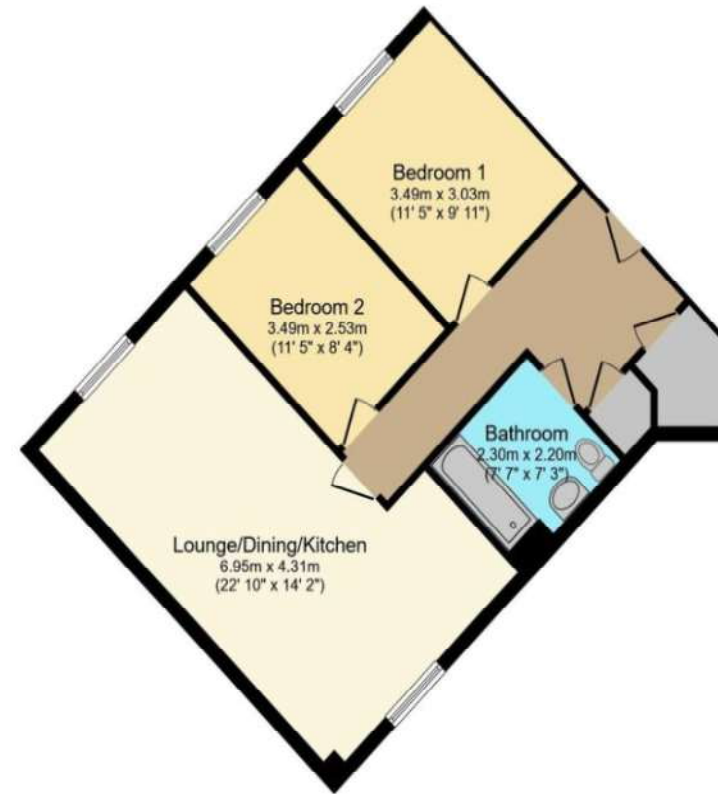

Ground Floor

Floor area 79.2 sq.m. (852 sq.ft.) approx



view this property online brownandmerry.co.uk/Property/AYL116330



welcome to

Paradise Orchard, Aylesbury

- TOP FLOOR APARTMENT
- OPEN PLAN LOUNGE/ DINING/ KITCHEN
- TWO BEDROOMS
- BATHROOMS
- ALLOCATED PARKING

Tenure: Leasehold EPC Rating: B

Council Tax Band: C Service Charge: 2670.00

Ground Rent: 250.00

This is a Leasehold property with details as follows; Term of Lease 125 years from 01 Jan 2014. Should you require further information please contact the branch. Please Note additional fees could be incurred for items such as Leasehold packs.

£210,000



Please note the marker reflects the postcode not the actual property

view this property online [brownandmerry.co.uk/Property/AYL116330](https://www.brownandmerry.co.uk/Property/AYL116330)



Property Ref:
AYL116330 - 0004

1. MONEY LAUNDERING REGULATIONS Intending purchasers will be asked to produce identification documentation at a later stage and we would ask for your co-operation in order that there is no delay in agreeing the sale. 2. These particulars do not constitute part or all of an offer or contract. 3. The measurements indicated are supplied for guidance only and as such must be considered incorrect. Potential buyers are advised to recheck measurements before committing to any expense. 4. We have not tested any apparatus, equipment, fixtures or services and it is in the buyers interest to check the working condition of any appliances. 5. Where an EPC, or a Home Report (Scotland only) is held for this property, it is available for inspection at the branch by appointment. If you require a printed version of a Home Report, you will need to pay a reasonable production charge reflecting printing and other costs. 6. We are not able to offer an opinion either written or verbal on the content of these reports and this must be obtained from your legal representative. 7. Whilst we take care in preparing these reports, a buyer should ensure that his/her legal representative confirms as soon as possible all matters relating to title including the extent and boundaries of the property and other important matters before exchange of contracts.

Brown & Merry is a trading name of Sequence (UK) Limited which is registered in England and Wales under company number 4268443, Registered Office is Cumbria House, 16-20 Hockliffe Street, Leighton Buzzard, Bedfordshire, LU7 1GN. VAT Registration Number is 500 2481 05.

brown & merry



01296 488111



Aylesbury@brownandmerry.co.uk



5-7 Market Street, AYLESBURY,
Buckinghamshire, HP20 2PN



[brownandmerry.co.uk](https://www.brownandmerry.co.uk)