



ASPIRE

— TO MOVE —



Newbridge Hill, Bath, BA1

Video viewing and physical viewing available. One bedroom, first floor flat located on Newbridge Hill that can be offered furnished or unfurnished. Available from the 14th August 2026

Newbridge hill is located within Newbridge on the West side of Bath. It offers great access into Bath city centre as well as given access to Bristol. The property lies 0.2 miles from Royal United hospital and 0.4 miles from local shops on Chelsea Road.

- Video viewing available
- Furnished or unfurnished
- Available from the 14th August
- Close to local amenities
- One bedroom flat
- Council tax A
- On street parking
- Holding deposit: £288.00

£1,250 PCM

Floor Plans

FIRST FLOOR 474 sq.ft. (44.0 sq.m.) approx.

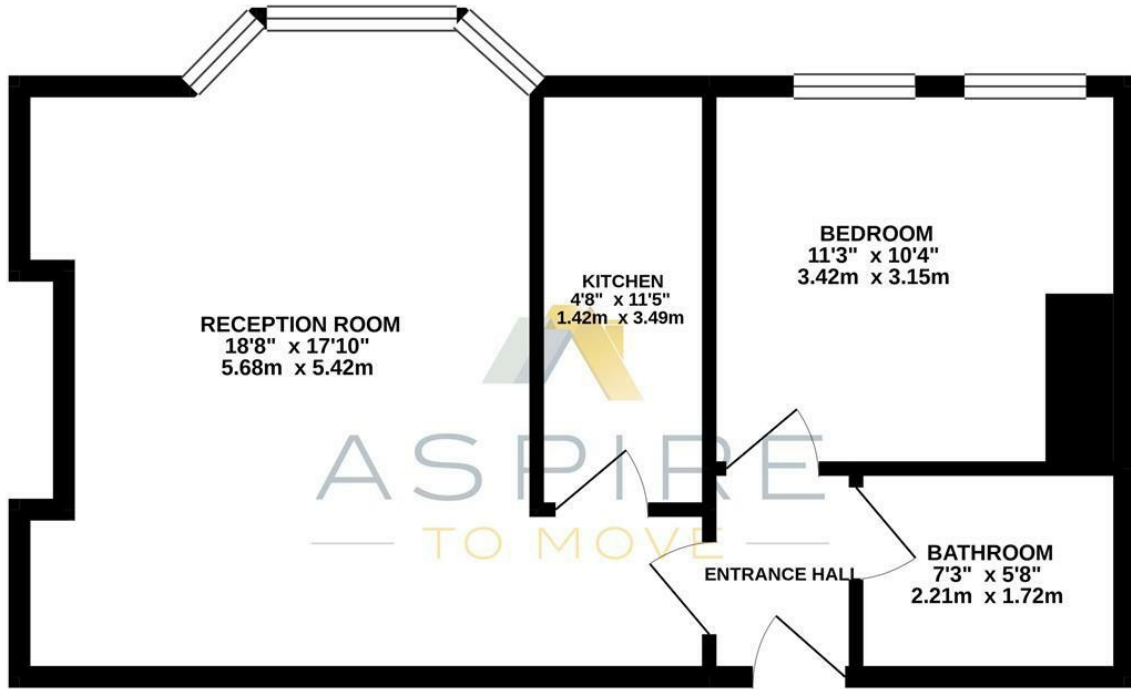

NEWBRIDGE HILL, BATH, BA1

TOTAL FLOOR AREA : 474 sq.ft. (44.0 sq.m.) approx.

Whilst every attempt has been made to ensure the accuracy of the floorplan contained here, measurements of doors, windows, rooms and any other items are approximate and no responsibility is taken for any error, omission or mis-statement. This plan is for illustrative purposes only and should be used as such by any prospective purchaser. The services, systems and appliances shown have not been tested and no guarantee as to their operability or efficiency can be given.
Made with Metropix ©2021

Energy Performance Graph

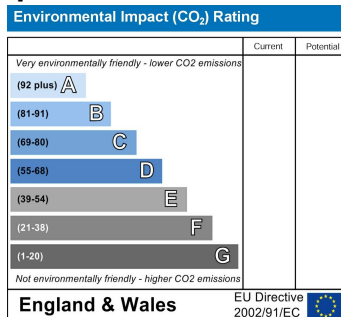
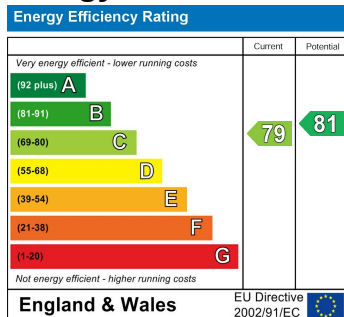

These particulars, whilst believed to be accurate are set out as a general outline only for guidance and do not constitute any part of an offer or contract. Intending purchasers should not rely on them as statements of representation of fact, but must satisfy themselves by inspection or otherwise as to their accuracy. No person in this firm's employment has the authority to make or give any representation or warranty in respect of the property.