

Floorplan

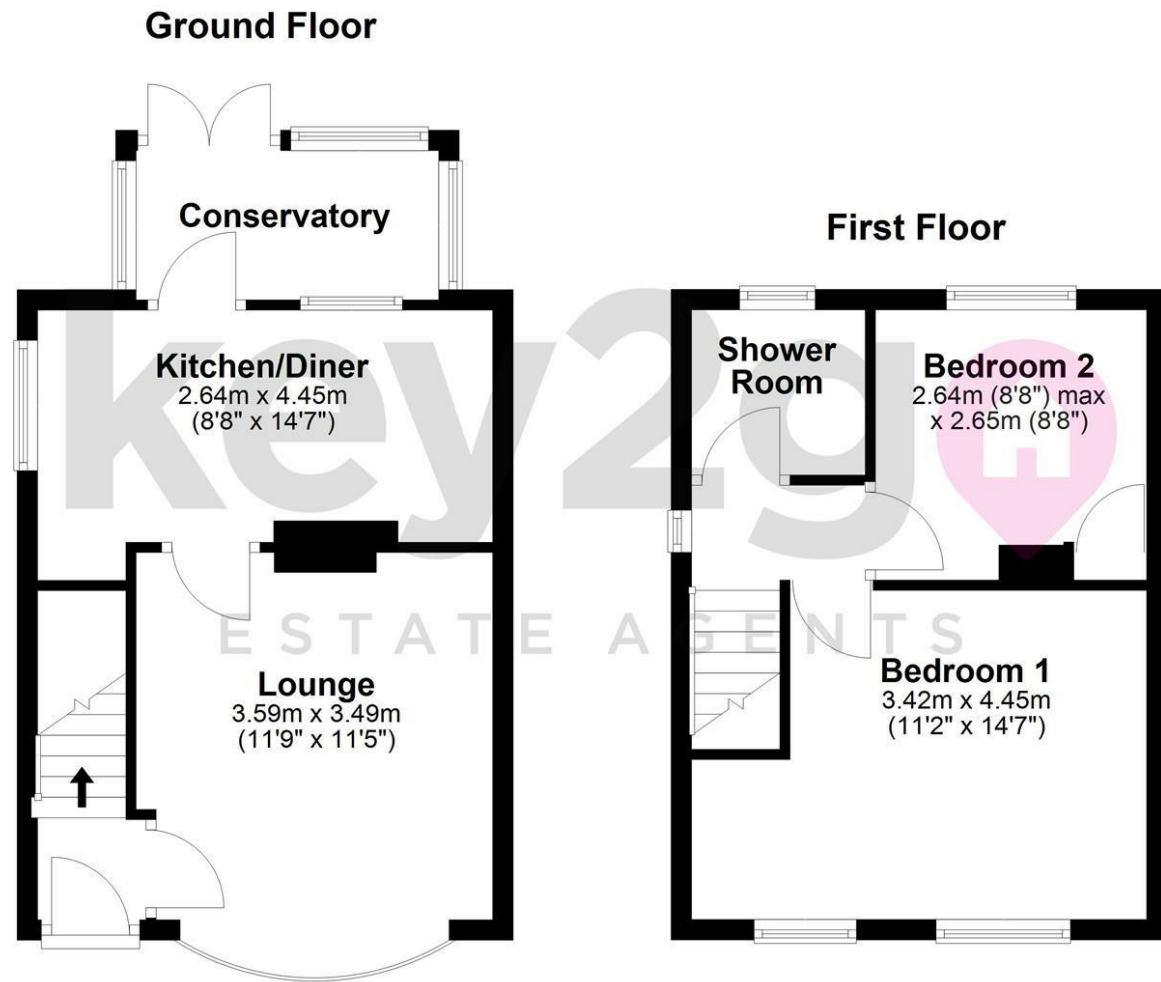

Area Map

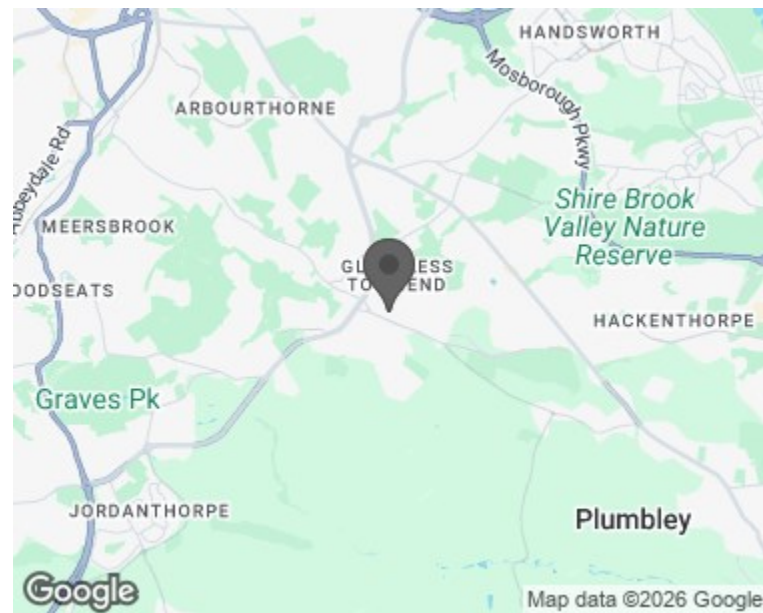

Energy Efficiency Graph

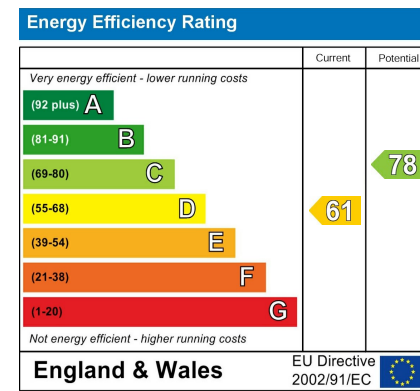

22 Carson Mount  
Sheffield, S12 3GA

£940 PCM



Viewing

Please contact our Lettings Team Office on 0114 2478819 if you wish to arrange a viewing appointment for this property or require further information.

These particulars, whilst believed to be accurate are set out as a general outline only for guidance and do not constitute any part of an offer or contract. Intending purchasers should not rely on them as statements of representation of fact, but must satisfy themselves by inspection or otherwise as to their accuracy. No person in this firm's employment has the authority to make or give any representation or warranty in respect of the property.



# 22 Carson Mount

Sheffield, S12 3GA

£940 PCM



This well presented two double bedroom semi detached home is available to rent in the popular area of basegreen, close to public transport, local amenities, and schools!

Inside, the property features a spacious lounge with a bay window, a modern stylish kitchen with ample storage, and a bright conservatory! Upstairs offers two double bedrooms and a stylish shower room!

Outside, there is a generous rear garden, a garage, and a shared driveway to the front.

Early viewing advised.

