

PINNER VIEW, NORTH HARROW



One Bedroom First Floor Converted flat

Guide Price £275,000

Description

A spacious one bedroom first floor conversion with its own entrance and own section of rear garden well positioned for shopping and transport facilities in the surrounding area including both Harrow Metropolitan and West Harrow Stations. The property is offered for sale in good order with gas fired central heating, double glazed windows and a recently renewed lease to over 160 years with a zero ground rent and a nil service charge. No Upper Chain can be offered, and as such, an internal inspection comes highly advised.



Location:

It is located within the catchment area to the Outstanding OFSTED rated Nower Hill School. The property is also just 0.7 miles from West Harrow Station, and 0.8 Miles to North Harrow Station its high street and amenities. Both Stations provides access to the Metropolitan Line.

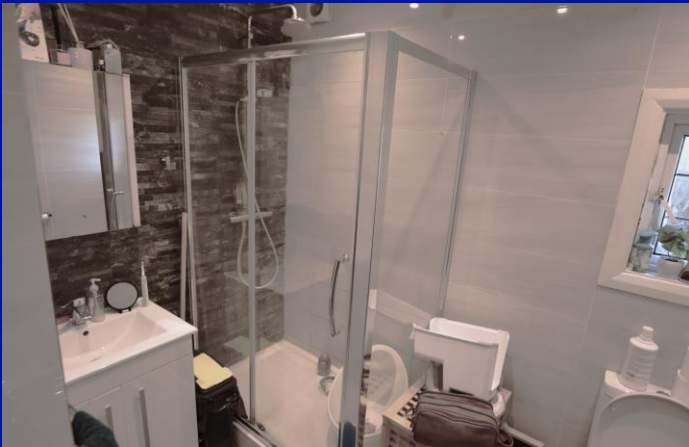



- *One bedroom first floor conversion*
- *Recently renewed lease to over 160 years with zero ground rent and service charge*
- *Close to all facilities including North Harrow and West Harrow stations*
- *Good order with gas central heating and double glazed windows*
- *Own section of rear garden*
- *No Upper Chain can be available*

Additional Information

TENURE. LEASEHOLD

LOCAL AUTHORITY. LONDON BOROUGH OF HARROW

ENERGY EFFICIENCY RATING. TBA

First Floor

Approx. 54.0 sq. metres (581.7 sq. feet)

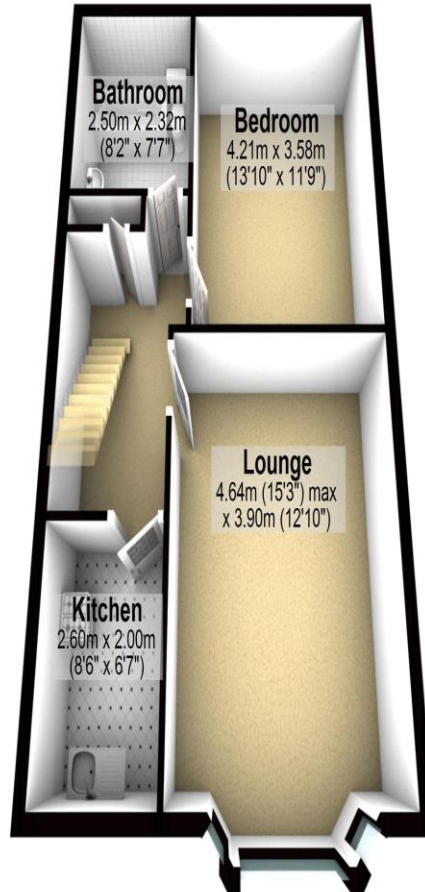

Total area: approx. 54.0 sq. metres (581.7 sq. feet)



We have not sought to verify the legal title of the property, the existence of planning permissions and/or building regulation approvals and have been unable to check the working condition of any services or appliances.

Property layouts are for general guidance and are not drawn exactly to scale. Measurements are taken at the widest points and bays, alcoves, wardrobes etc. may not be shown.