



Stockleigh Road, St Leonards-On-Sea TN38 0JP

Offers in excess of £150,000



A stylish ONE BEDROOM APARTMENT located in a sought after St. Leonards setting. It's enviably positioned just a short stroll from the hub of St. Leonards on Sea where there are a range of local stores on Norman Road and surrounding, award winning eateries, the beach and a mainline railway station with connections to London. Set on the TOP FLOOR of this PERIOD RESIDENCE, the accommodation here is arranged as a BRIGHT OPEN PLAN LIVING/KITCHEN SPACE which measures 17 x 14'2 with space for a dining table and is fitted with CONTEMPORARY UNITS and integrated appliances. The DOUBLE BEDROOM is positioned at the rear of the property and benefits from BUILT-IN STORAGE, together with the bathroom with bath and shower over. Externally there is communal parking available on a first come first serve basis. Set in a CONVENIENT LOCATION, with a SHARE OF FREEHOLD this fantastic property would make the PERFECT FIRST TIME HOME or SEASIDE RETREAT and is not to be missed.

GROUND FLOOR
411 sq.ft. (38.2 sq.m.) approx.

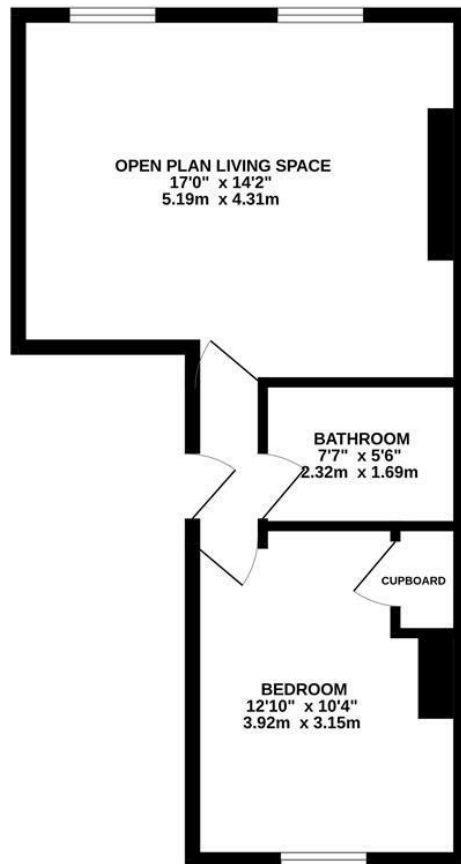

TOTAL FLOOR AREA : 411 sq.ft. (38.2 sq.m.) approx.

Whilst every attempt has been made to ensure the accuracy of the floorplan contained here, measurements of doors, windows, rooms and any other items are approximate and no responsibility is taken for any error, omission or mis-statement. This plan is for illustrative purposes only and should be used as such by any prospective purchaser. The services, systems and appliances shown have not been tested and no guarantee as to their operability or efficiency can be given.
Made with Metropix ©2025

