



**Constables**  
SALES & LETTINGS

Croft Green

Bromborough, Wirral

£175,000

Offered for sale with no onward chain.  
A two bedroom mid-terraced property located in a  
cul-de-sac just off New Chester Road in  
Bromborough. The property is conveniently situated  
for local amenities and transport links.  
The accommodation comprises, hallway, lounge,  
kitchen-dining room, two bedrooms and a bathroom.  
Externally there is a driveway and at the rear is a low  
maintenance garden and decked area.

*I can do all things  
through Christ  
who strengthens me*





# Constables

SALES & LETTINGS

- Two Bedroom Mid-Terraced Property
- Lounge & Kitchen Dining Room
- Enclosed Rear Garden
- Cul-De-Sac Location
- Two Double Bedrooms
- No Onward Chain
- Close to amenities and transport links
- Off Road Parking

## Hallway

## Lounge

14'7" x 9'8" extending to 12'11"  
(4.45m x 2.97m extending to  
3.94m)

## Kitchen-Dining Room

9'2" x 12'10" (2.8m x 3.93m)

## Landing

## Bedroom One

12'11" max reducing to 9'9" x 12'6"  
max (3.94m max reducing to  
2.99m x 3.82m max)

## Bedroom Two

11'2" x 7'10" (3.42m x 2.40m)

## Bathroom

8'9" x 4'9" (2.68m x 1.47m)





# EPC & Floor Plan

Energy Efficiency Rating		
	Current	Potential
<i>Very energy efficient - lower running costs</i>		
(92 plus) <b>A</b>		<b>90</b>
(81-91) <b>B</b>		
(69-80) <b>C</b>	<b>69</b>	
(55-68) <b>D</b>		
(39-54) <b>E</b>		
(21-38) <b>F</b>		
(1-20) <b>G</b>		
<i>Not energy efficient - higher running costs</i>		
<b>England &amp; Wales</b>	EU Directive 2002/91/EC	

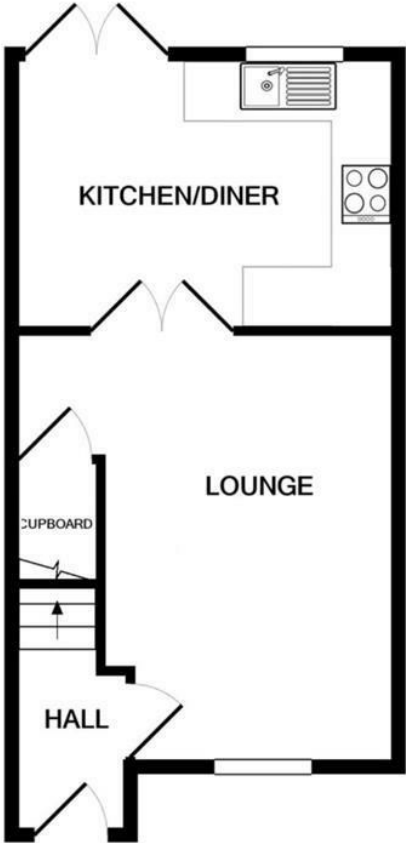

GROUND FLOOR

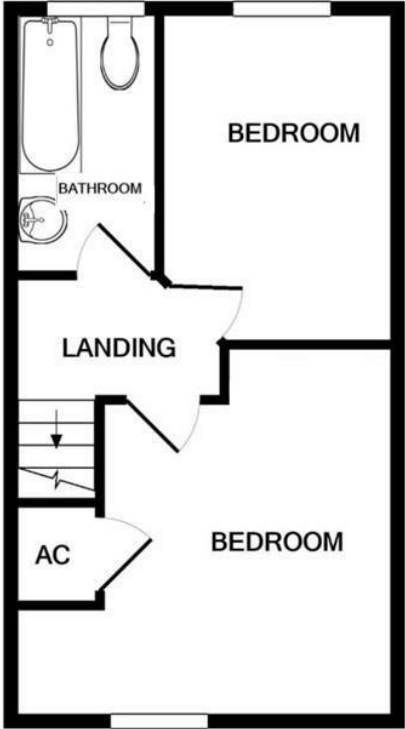

FIRST FLOOR

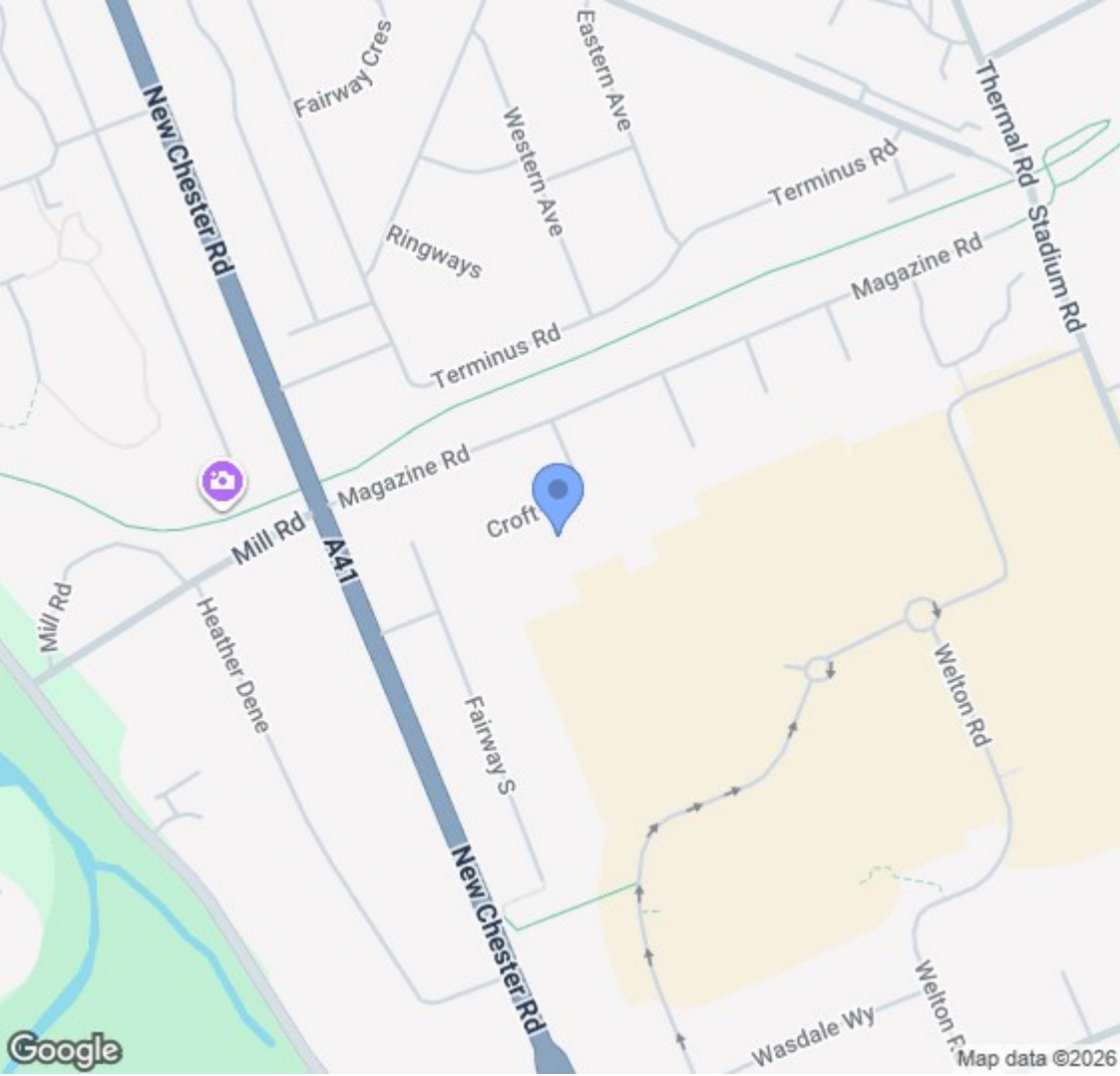
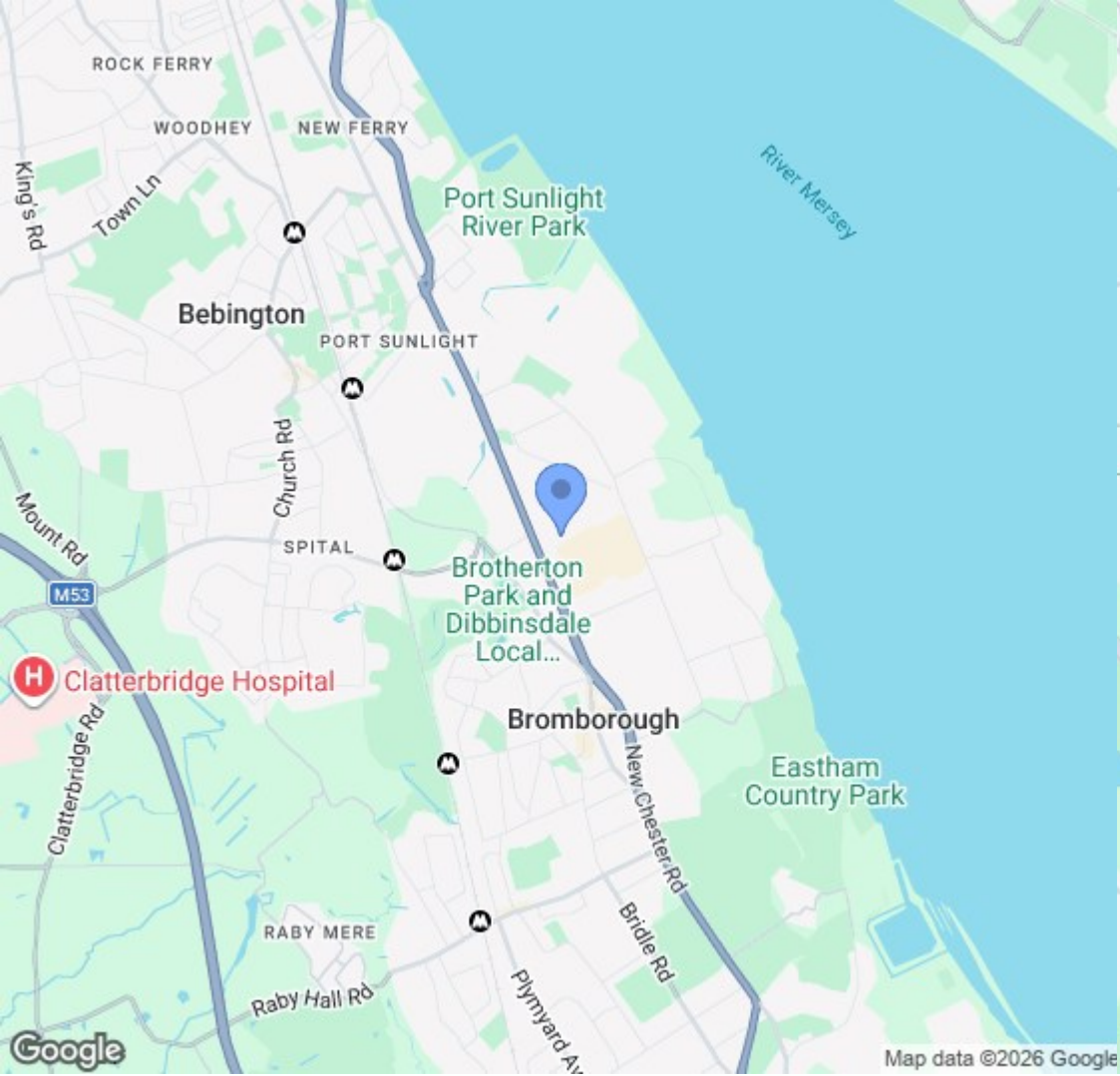

## Location Map

# Constables

S A L E S & L E T T I N G S

21 High Street, Neston

South Wirral, Neston, Cheshire

[www.constablesestateagents.co.uk](http://www.constablesestateagents.co.uk)

[info@constablesestateagents.co.uk](mailto:info@constablesestateagents.co.uk)

0151 353 1333