

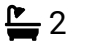

EUGEN COTORANU

Personal Estate Agent
exp

Kingsnorth House, Ladbroke Grove W10 6SH

£550,000

 4  2  1



A spacious 4-bedroom apartment arranged over two floors with a private balcony, set in a well-connected location close to Ladbroke Grove and Notting Hill.

SELL | BUY | LET | INVEST
07774807085 | eugen.cotoranu@exp.uk.com

EUGEN COTORANU

Personal Estate Agent
exp

- Please Quote EC0801
- Private balcony
- Separate kitchen and dining area
- Close to Ladbroke Grove
- Moments from Portobello Road Market
- 1,044 sq ft internal space
- Two bathrooms
- Strong rental potential
- Within easy reach of Notting Hill
- Excellent transport links

KINGSNORTH HOUSE

APPROXIMATE GROSS INTERNAL FLOOR AREA: 1044 SQ FT - 97 SQ M



SECOND FLOOR

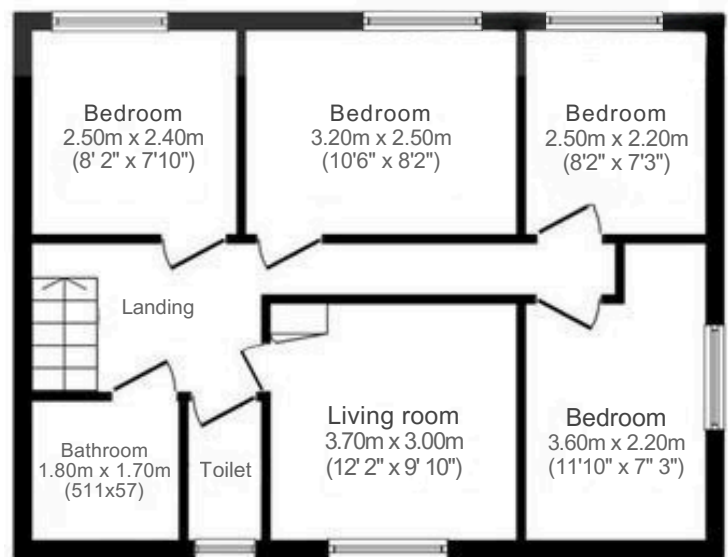

THIRD FLOOR

FOR IDENTIFICATION PURPOSES ONLY, NOT TO SCALE

SELL | BUY | LET | INVEST
07774807085 | eugen.cotoranu@exp.uk.com