

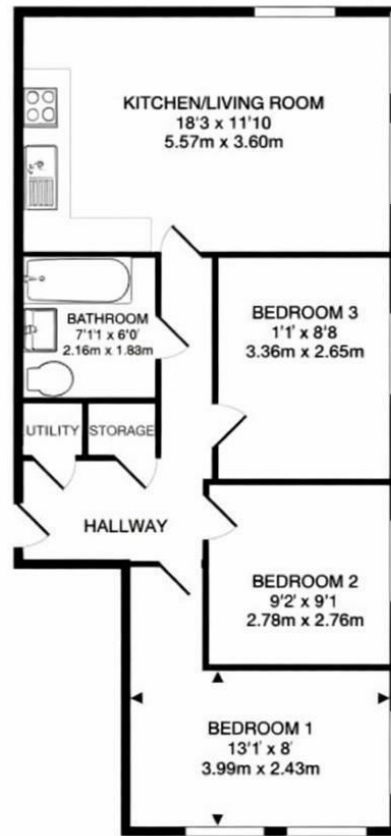

3 Bed
Apartment
located in

£1,800 Per month





TOTAL APPROX. FLOOR AREA 661 SQ.FT. (61.4 SQ.M.)

Whilst every attempt has been made to ensure the accuracy of the floor plan contained here, measurements of doors, windows, rooms and any other items are approximate and no responsibility is taken for any error, omission or mis-statement. This plan is for illustrative purposes only and should be used as such by any prospective purchaser. The services, systems and appliances shown have not been tested and no guarantee as to their operability or efficiency can be given.
Made with Metropix ©2019

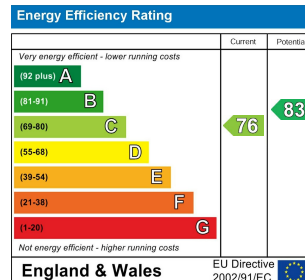

DIRECTIONS

The property boasts excellent connectivity, situated just 0.6 miles from Manchester Piccadilly Station and the vibrant Northern Quarter- both easily reachable on foot. For public transport users, New Islington Metrolink tram stop is only a few minutes' walk away, offering direct links to the city centre and surrounding areas. Those travelling by car will find Manchester City Centre

CONTACT

Colony One
Suite 1.24 1 Silk Street
Ancoats
Manchester

E: hello@maddoxnoel.com
T: 0161 543 3406
www.maddoxnoel.com



MaddoxNoel

ESTATE & LETTINGS AGENTS