

FREEHOLD



Detached House (EPC Rating: 65)

HEATHFIELD ROAD, BUSHEY, HERTFORDSHIRE, WD23 3LJ

Asking Price Of

£1,695,000



5 Bedroom Detached House located in Bushey.

Welcome to Heathfield Road – One of Bushey’s Most Prestigious Addresses.

This substantial five double-bedroom residence, arranged over three floors, offers over 3,500 sq ft of thoughtfully designed living space, perfectly suited for modern family life and entertaining in style.

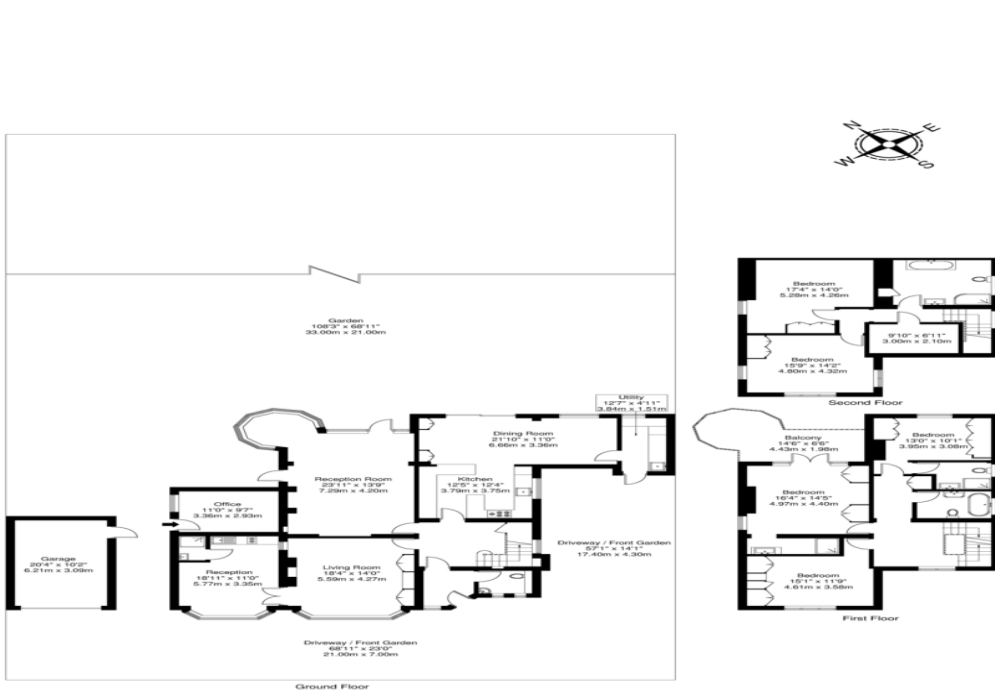

Heathfield Road, Bushey, WD23
 Total Gross Internal Area = 310.9 sq m / 3346 sq ft
 Garage = 19.2 sq m / 206 sq ft
 Total = 330.1 sq m / 3552 sq ft

All Measurements are approximate and for identification guideline purposes only, not to scale.
 Compliant with the RICS code of measuring practice

Council Tax Band
BAND G

Call us on
0203 633 6560

Energy Performance Graph

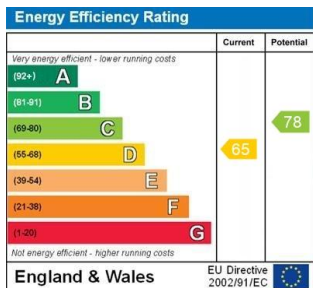

info@brownrok.com
www.brownrok.com

Agents Note: Whilst every care has been taken to prepare these particulars, they are for guidance purposes only. All measurements are approximate and are for general guidance purposes only and whilst every care has been taken to ensure their accuracy, they should not be relied upon and potential buyers are advised to recheck the measurements.

