



Athelstan Road, Hastings TN35 5JE

Offers in excess of £375,000



Beautifully presented THREE BEDROOM Victorian family home set in a sought after Clive Vale location only a short stroll from Hastings Old Town & Hastings Country Park. The accommodation here enjoys GENEROUS PROPORTIONS and a wealth of ORIGINAL FEATURES, the ground floor enjoys a bright living room with a large bay window and a LOG BURNING STOVE, there is a separate dining room and the kitchen/breakfast room sits at the rear of the property with a handy utility room and BI-FOLDING DOORS leading out to the rear garden. On the first floor there are three well proportioned double bedrooms along with a LARGE FAMILY BATHROOM where there is a freestanding, roll top bath with a shower over. The rear garden is a particular feature here, it enjoys a raised area of patio which offers the perfect space to dine al-fresco and there is a generous expanse of lawn beyond. To the front of the property there is a driveway providing OFF ROAD PARKING FOR ONE VEHICLE and gated side access making this fantastic property the PERFECT FAMILY HOME.

GROUND FLOOR
633 sq.ft. (58.8 sq.m.) approx.

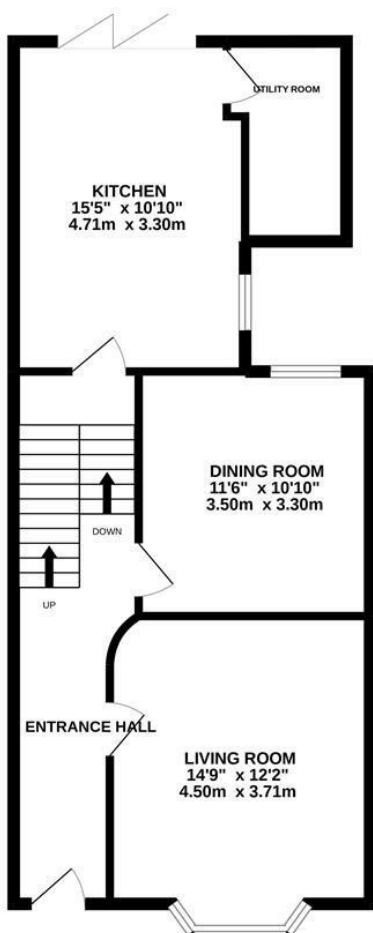

1ST FLOOR
620 sq.ft. (57.6 sq.m.) approx.

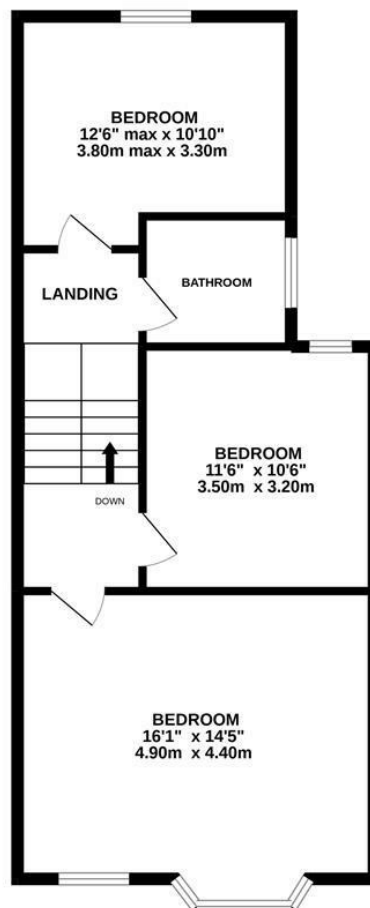

TOTAL FLOOR AREA: 1252 sq.ft. (116.4 sq.m.) approx.

Whilst every attempt has been made to ensure the accuracy of the floorplan contained here, measurements of doors, windows, rooms and any other items are approximate and no responsibility is taken for any error, omission or mis-statement. This plan is for illustrative purposes only and should be used as such by any prospective purchaser. The services, systems and appliances shown have not been tested and no guarantee as to their operability or efficiency can be given.

Made with Metropix 1/2022

