

Earlswood Close, Horsham

Offers Over £525,000

🛏 4 🚗 3 🛋 3



An Extended Family Home located in a Small Cul De Sac, boasting Four Double Bedrooms, with Two Ensuite Shower Rooms, excellent Potential To Extend (stpp) and No Onward Chain.

Tenure: Freehold

Council Tax: Band E

EPC Rating: Current C - Potential C

Key Features

- Watch Our Video Tour
- No Onward Chain
- Accommodation Over Three Floors
- Generous Rear Garden
- Cul De Sac Location
- Extended Family Home
- Four Generous Double Bedrooms
- Two En Suite Shower Rooms
- Excellent Potential To Extend (stpp)
- Close To Popular Schools

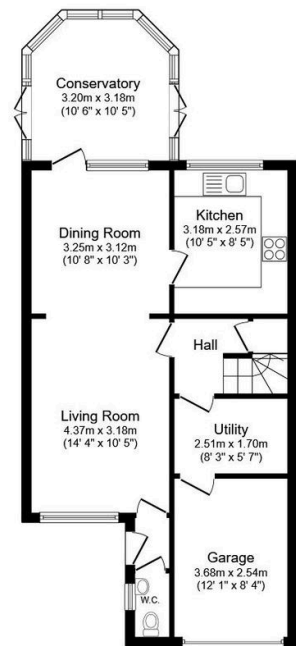

Ground Floor

Floor area 64.5 sq.m. (694 sq.ft.)

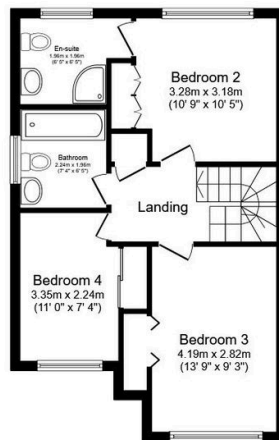

First Floor

Floor area 49.8 sq.m. (536 sq.ft.)

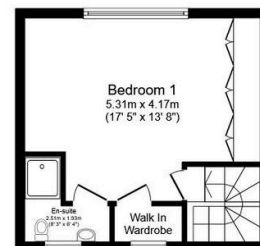

Second Floor

Floor area 26.8 sq.m. (289 sq.ft.)

Total floor area: 141.1 sq.m. (1,519 sq.ft.)

This floor plan is for illustrative purposes only. It is not drawn to scale. Any measurements, floor areas (including any total floor area), openings and orientations are approximate. No details are guaranteed, they cannot be relied upon for any purpose and do not form any part of any agreement. No liability is taken for any error, omission or misstatement. A party must rely upon its own inspection(s). Powered by www.Propertybox.io