



MERCURY HOUSE, E16

£340,000

A two bedroom, two bathroom property. This property offers a bright living room with wooden flooring which leads out onto the private balcony, a semi open plan kitchen, two sizable bedrooms, one of which is en suite, and a family bathroom.

- Two Double Bedrooms
- Chain Free
- Private Balcony
- Modern
- Built In Appliances
- En Suite

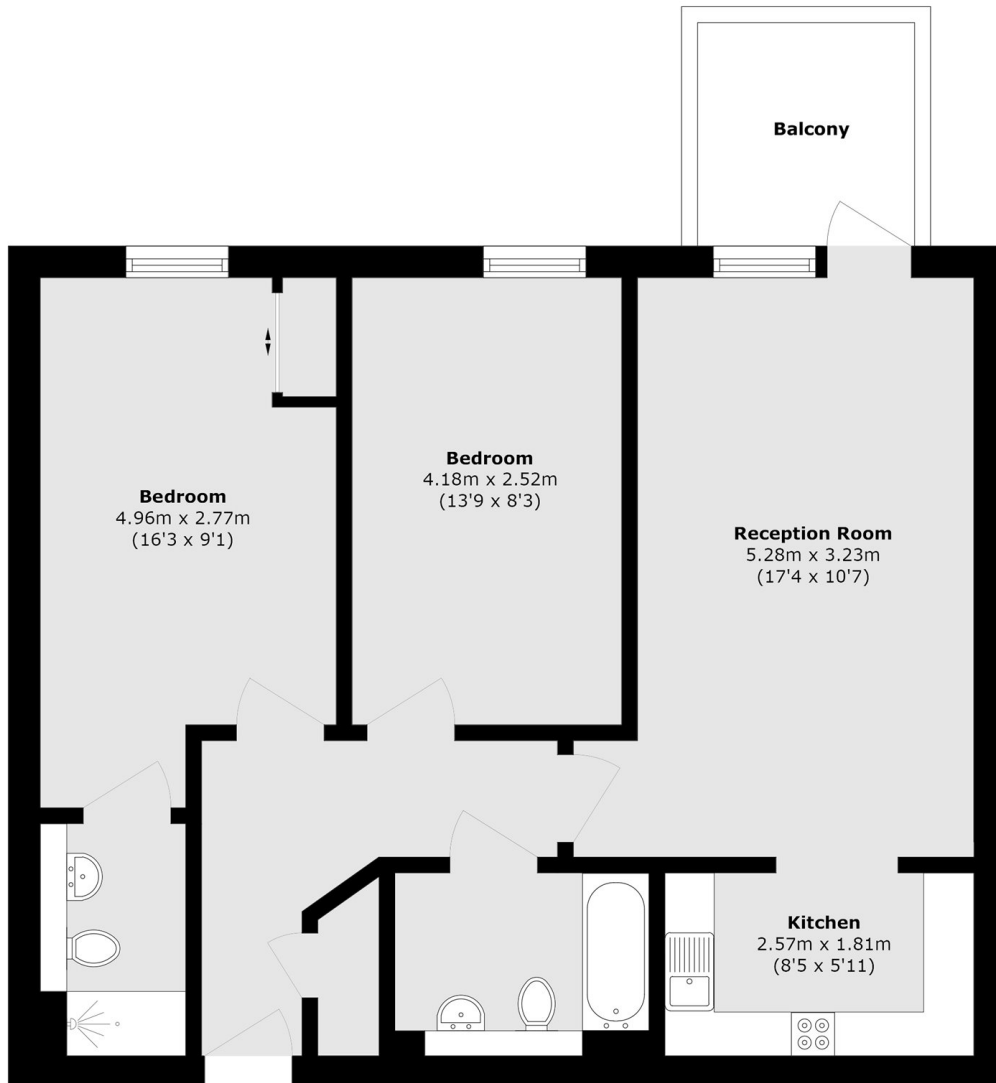

Total area (approx.): 63.6 sq. m (684.5 sq. ft)
Balcony area (approx.): 4.24 sq. m (45.6 sq. ft)

LiFE RESIDENTIAL

16 Royal Crest Avenue,
London, E16 2TQ
Sales: 020 3846 3332
Lettings: 020 3846 3311

Energy Rating: B. We aim to make our particulars both accurate and reliable. However they are not guaranteed; nor do they form part of an offer or contract. If you require clarification on any points then please contact us, especially if you're traveling some distance to view. Please note that appliances and heating systems have not been tested and therefore no warranties can be given as to their good working order.