



**8 Carnation Way, Thames City, SW8 5FT**  
**£4,200 PCM**

**coopers**  
OF LONDON EST. 1986

## 8 Carnation Way, Thames City, SW8

- 24hr Concierge
- 28th Floor
- Gym
- Swimming Pool
- Kids Club
- Close to tube
- Library
- Spa/Sauna

One bedroom apartment on the 28th floor of the prestigious Thames City development in Nine Elms. The property comprises; entrance hallway with ample storage space, open-plan kitchen/reception with floor to ceiling windows, double bedroom with luxury en-suite bathroom (bath + walk-in shower) and separate WC. The Thames City development benefits from 24hr concierge, high quality gym, kids club and London's largest private swimming pool.

One bedroom apartment on the 28th floor of the prestigious Thames City development in Nine Elms. The property comprises; entrance hallway with ample storage space, open-plan kitchen/reception with floor to ceiling windows, double bedroom with luxury en-suite bathroom (bath + walk-in shower) and separate WC. The Thames City development benefits from 24hr concierge, high quality gym, kids club and London's largest private swimming pool.





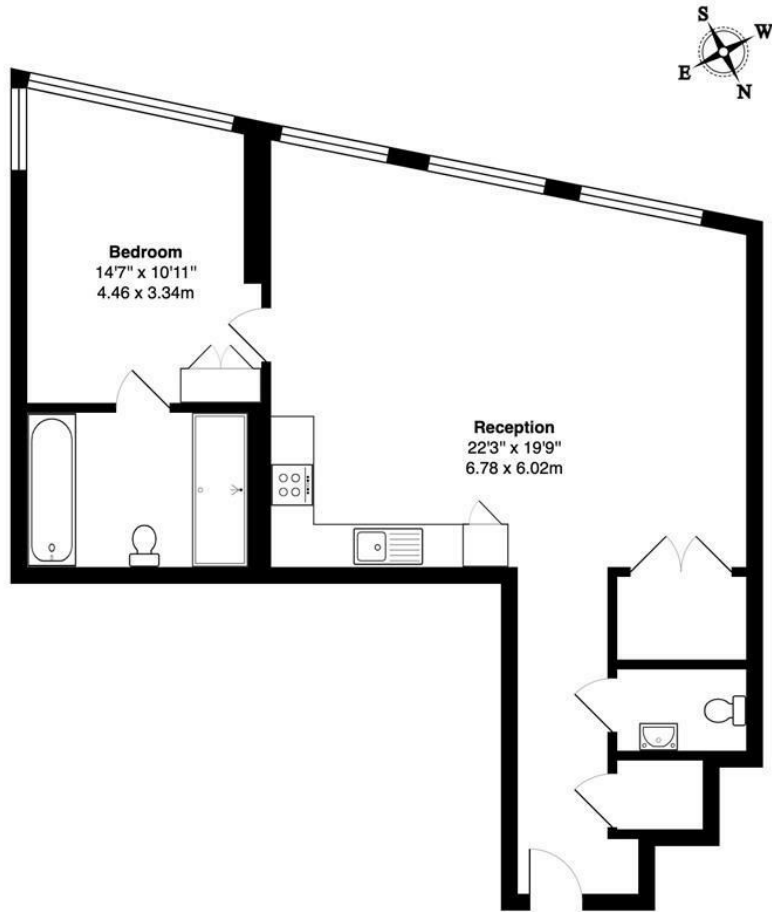

Carnation Way Thames City, SW8

Total Gross Area: 777 ft<sup>2</sup> ... 72.2 m<sup>2</sup>

All measurements are approximate and for identification guideline purposes only, not to scale.  
Compliant with the RICS code of measuring practice

Energy Efficiency Rating		Current	Potential
Very energy efficient - lower running costs			
(92 plus) A			
(81-91) B		85	85
(69-80) C			
(55-68) D			
(39-54) E			
(21-38) F			
(1-20) G			
Not energy efficient - higher running costs			
England & Wales		EU Directive 2002/91/EC	

Environmental Impact (CO <sub>2</sub> ) Rating		Current	Potential
Very environmentally friendly - lower CO <sub>2</sub> emissions			
(92 plus) A			
(81-91) B			
(69-80) C			
(55-68) D			
(39-54) E			
(21-38) F			
(1-20) G			
Not environmentally friendly - higher CO <sub>2</sub> emissions			
England & Wales		EU Directive 2002/91/EC	

## Viewing

Strictly by appointment with:  
Coopers of London, 22 Cleveland Street,  
Fitzrovia, London W1T 4JB  
[info@coopersonlondon.co.uk](mailto:info@coopersonlondon.co.uk)

**0207 580 9658**

These particulars, whilst believed to be accurate are set out as a general outline only for guidance and do not constitute any part of an offer or contract. Intending purchasers should not rely on them as statements or representation of fact, but must satisfy themselves by inspection or otherwise as to their accuracy. No person in this firm's employment has the authority to make or give any representation or warranty in respect of the property.