

9 Morris Way - Guide Price £245,000

Needham Market Ipswich IP6 8TD

shires

Estate & Letting Agents



"Consistently providing outstanding service to our clients"

Guide Price £245,000

The Property

Situated in a quiet cul de sac on the popular Chainhouse development within walking distance of the centre of Needham Market which has a wide range of facilities. This modern semi detached house has been extended to provide accommodation of Entrance Hall, Bathroom, fitted Kitchen, 25ft Sitting/Dining Room, 3 Bedrooms. The property also benefits from a Garage and driveway parking and gardens to front and rear.

Please be aware that images of the property may have been digitally enhanced, edited, or staged using artificial intelligence, and may not reflect the current presentation or furnishings.

Features

- MODERN SEMI DETACHED HOUSE
- WALKING DISTANCE OF NEEDHAM MARKET TOWN CENTRE
- HALL, KITCHEN, BATHROOM
- 25FT SITTING/DINING ROOM
- THREE BEDROOMS
- GARAGE & DRIVEWAY PARKING
- GARDENS TO FRONT AND REAR
- NO ONWARD CHAIN





These sales particulars have been produced as a general guide only and we would draw to your attention that we have not carried out a detailed Survey of the property nor have we tested services, appliances or specific fittings. Whilst measurements and statements given within the details are provided in good faith, their accuracy should not be relied upon. If there are any points about which you may be uncertain or would like further clarification, we would suggest that you telephone this office and speak to our staff who will endeavour to assist you.

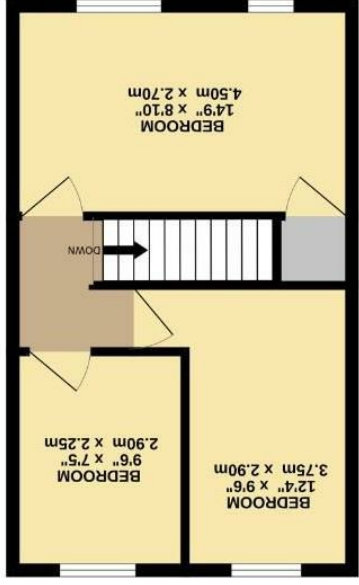
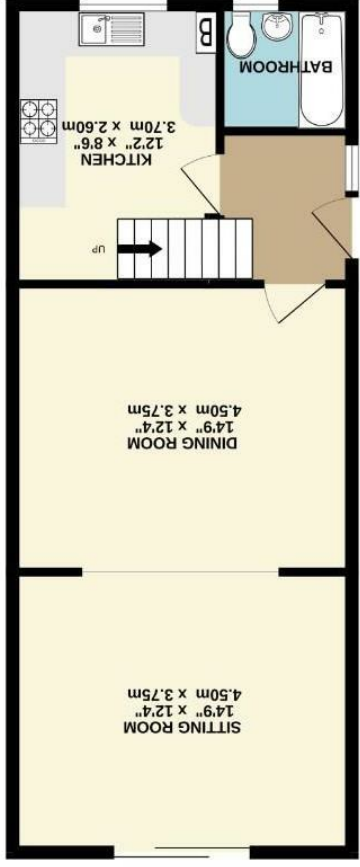

Whilst every attempt has been made to ensure the accuracy of the floorplan contained here, measurements of doors, windows, corners and any other items are approximate and no guarantee is taken as to their accuracy. The floorplan is intended for guidance only and should be used as a guide only. prospective purchaser. The services, systems and appliances shown have not been tested and no guarantee is given as to their operability or energy use.

