



CAMPBELL GORDON WAY, NW2

£400,000

Situated within an award-winning development, this impressive two-bedroom first-floor apartment offers generously proportioned interiors throughout. The property enjoys a desirable position overlooking the lush

Two bedrooms
One bathroom
Off street parking

Gold community award
First floor
Leasehold

STEP INSIDE

CAMPBELL GORDON WAY

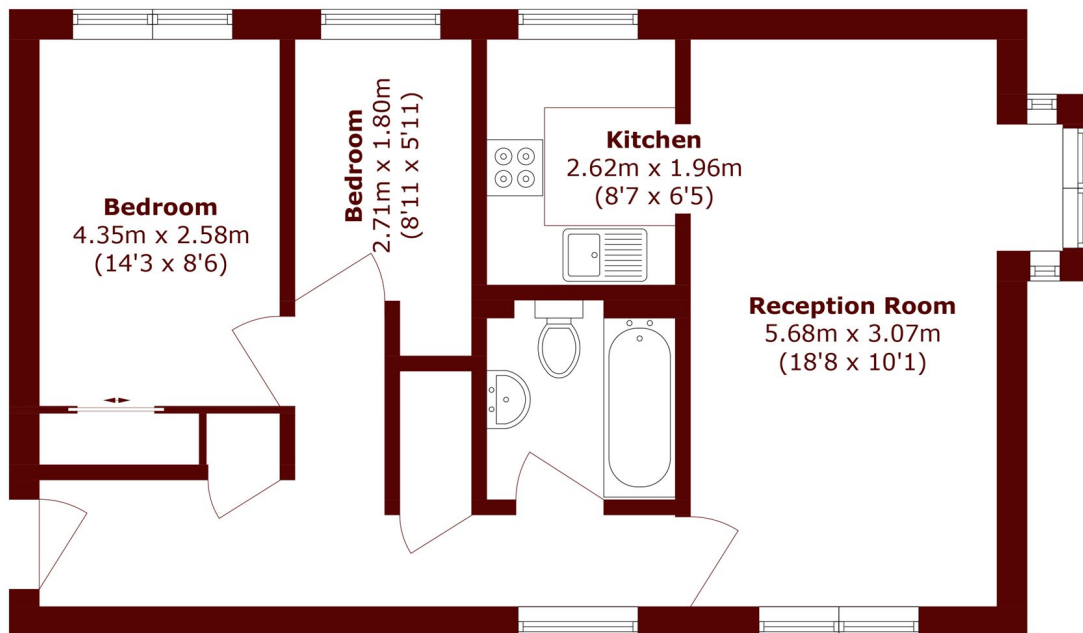

Total area (approx.): 55.3 sq. m (595.2 sq. ft)

Willesden Green
020 8451 0420

Energy Rating: We aim to make our particulars both accurate and reliable. However, they are not guaranteed; nor do they form part of an offer or contract. If you require clarification on any points then please contact us, especially if you're traveling some distance to view. Please note that appliances and heating systems have not been tested and therefore no warranties can be given as to their good working order

**MARSH &
PARSONS**