



## Jermyn Street, SW1Y

£850 Per week

A modern and well presented one bedroom apartment set within a lovely period block benefitting from day porter in the heart of St. James'.

Jermyn Street, well known for its established gentleman's outfitters, art galleries, hotels, and restaurants, is excellently located close to Piccadilly and St James Park. Dating from 1664, it retains a feeling of traditional charm whilst affording modern convenience.

### Features

- One Double Bedroom
- Built-In Storage
- Secure Portered Building
- Large Reception Room
- Lift
- Excellent Location



Jermyn Street, SW1Y





Jermyn Street,  
London, SW1Y

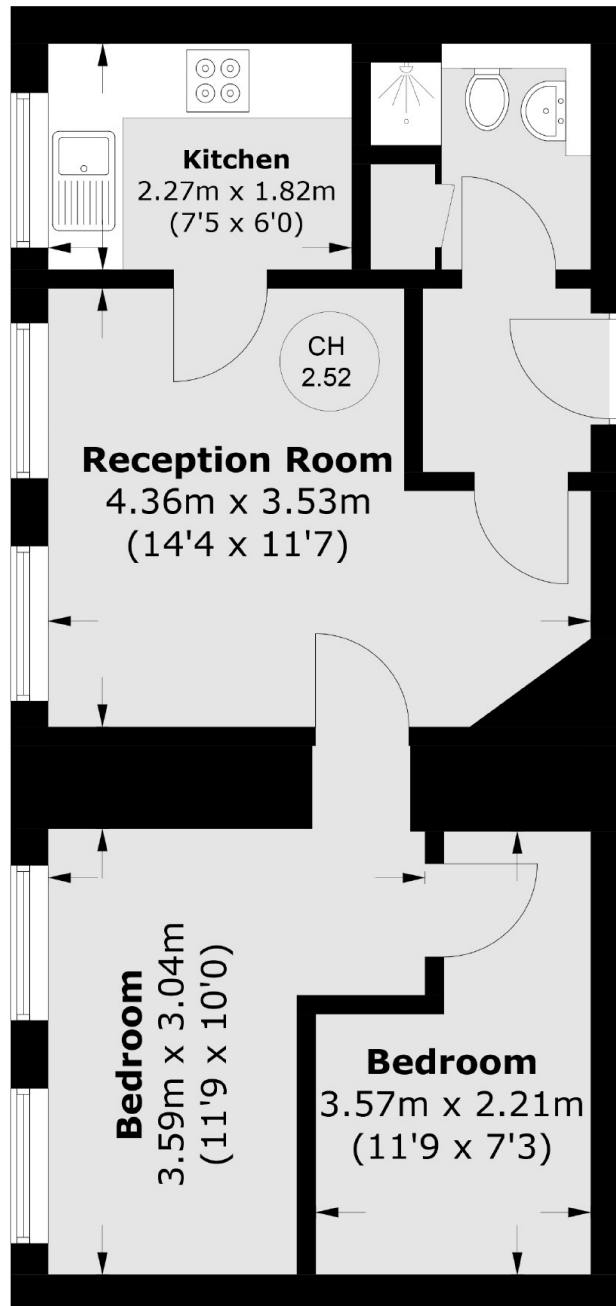

Total area (approx.): 43.3 sq. m (466.1 sq. ft)

**Dexters**

Wetherell  
102 Mount Street  
London  
W1K 2TH  
Lettings  
020 7529 5588

Energy Rating: E. We aim to make our particulars both accurate and reliable. However they are not guaranteed; nor do they form part of an offer or contract. If you require clarification on any points then please contact us, especially if you're traveling some distance to view. Please note that appliances and heating systems have not been tested and therefore no warranties can be given as to their good working order.

 **RICS** | Regulated  
Estate Agent  
and Letting Agent

dexters.co.uk