



14 Meadow Bank , Farnham, GU9 7XN

A 2 double bedroom terrace house with front views over the water meadows situated in a tucked away location within a short walk of Farnham town centre. No onward chain.

Price Guide £425,000

14 Meadow Bank

, Farnham, GU9 7XN



- Entrance hall and cloakroom
- Front views over the water meadows
- Sitting/dining room with sliding patio doors to rear garden
- Kitchen
- 2 double bedrooms with wardrobes
- Shower room
- Enclosed rear garden with gate
- 2 numbered parking spaces
- Short walk to Farnham town centre
- No onward chain



[Directions](#)

Sat Nav GU9 7XN



Floor Plan

GROUND FLOOR
313 sq.ft. (29.1 sq.m.) approx.

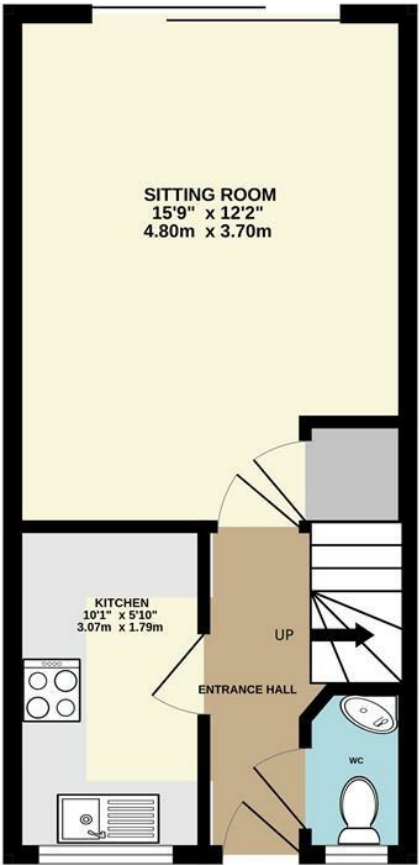

1ST FLOOR
313 sq.ft. (29.1 sq.m.) approx.

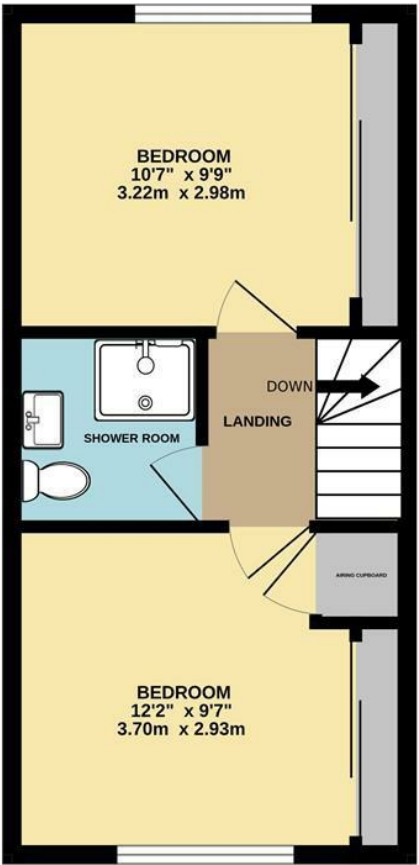

TOTAL FLOOR AREA : 627 sq.ft. (58.2 sq.m.) approx.
Whilst every attempt has been made to ensure the accuracy of the floorplan contained here, measurements of doors, windows, rooms and any other items are approximate and no responsibility is taken for any error, omission or mis-statement. This plan is for illustrative purposes only and should be used as such by any prospective purchaser. The services, systems and appliances shown have not been tested and no guarantee as to their operability or efficiency can be given.
Made with Metropix ©2026



These particulars, whilst believed to be accurate are set out as a general outline only for guidance and do not constitute any part of an offer or contract. Intending purchasers should not rely on them as statements of representation of fact, but must satisfy themselves by inspection or otherwise as to their accuracy. No person in this firms employment has the authority to make or give any representation or warranty in respect of the property.

