



## Arbour Square, E1 £800,000

Grade II listed Georgian Townhouse set within the sought after Arbour Square. This freehold home is arranged over three floors, it is currently presented as a spacious three bed. The ground floor entrance level has a fully integrated dine-in kitchen and a downstairs double bedroom, this floor leads out to the well maintained west facing garden. The first floor offers a bright living room overlooking the tree lined Arbour Square Gardens and the family bathroom and separate WC. The second and final floor has the two generous double bedrooms; the principal room shares the unique aspect as the living room on the floor below whilst the second room faces over the garden.

Arbour Square is set conveniently between Canary Wharf, Shoreditch and The City making the area great for work and leisure. Transport links include Whitechapel (Elizabeth Line, District and Hammersmith & City Lines) and Limehouse (DLR and National Rail) stations for convenient commute to all corners of the City and beyond. The green spaces of Arbour Square Gardens and Stepney City Farm are within short walking distance.

### Features

Three Bedrooms  
Grade II listed  
Georgian Townhouse  
Sashed Windows  
West Facing Garden  
Sought After Location

# Arbour Square, London, E1

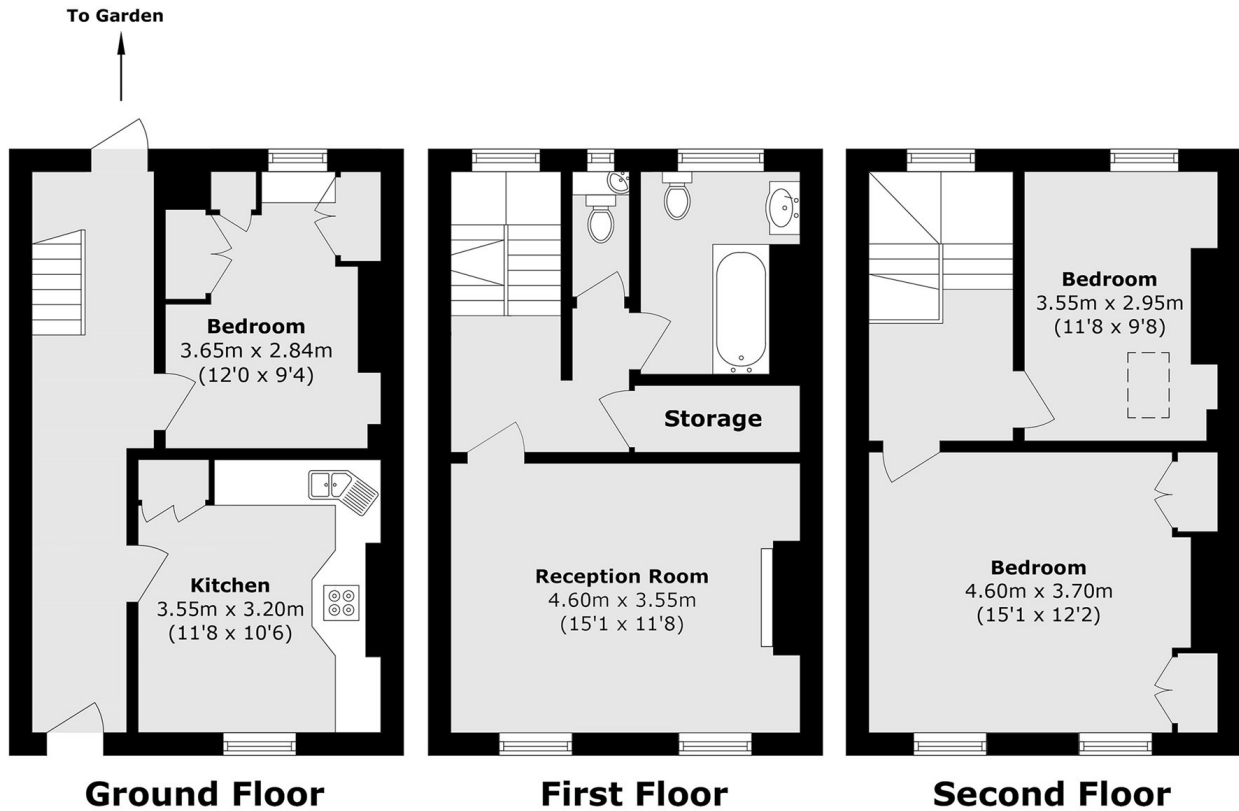

Total area (approx.): 101.8 sq. m (1095.7 sq. ft)