

Guest Street, Leigh, WN7 2RP

£1,000 PCM

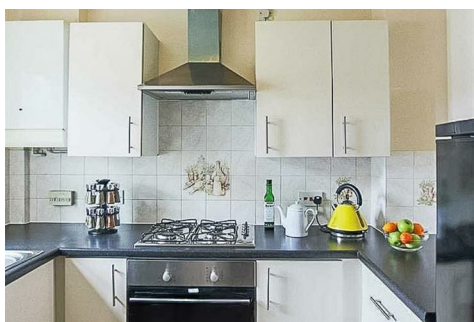



BALMER & CO are delighted to offer TO RENT this fantastic two bedroom semi-detached house situated on the ever popular Guest Street in Leigh. Comprising in brief of entrance porch, large living room, modern fitted kitchen, with a conservatory to the rear completing the ground floor. To the first floor is a large master bedroom, second large single bedroom, with a three piece bathroom completing the accommodation on offer. Externally the property is garden fronted with a single driveway providing off-road parking, whilst to the rear there is a fully enclosed, West facing garden. The property is ideally located close to Leigh town centre and is within walking distance of the Leigh - Manchester guided busway. Early viewings highly recommended, all enquiries welcome.

Floor Plan

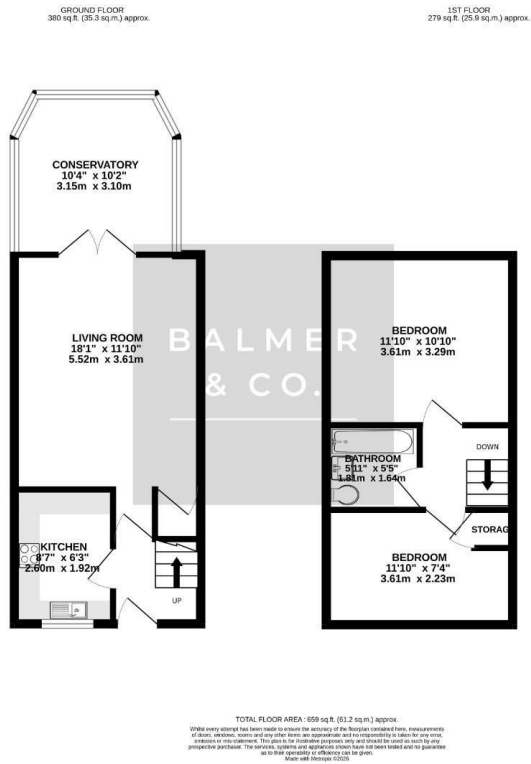

Area Map

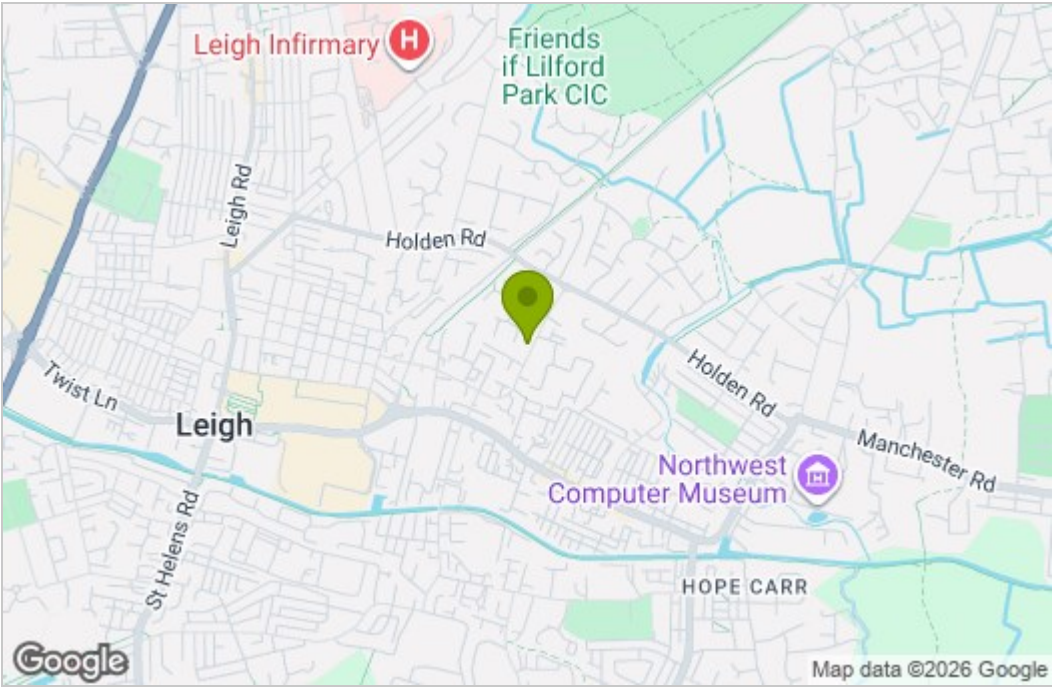

Energy Efficiency Graph

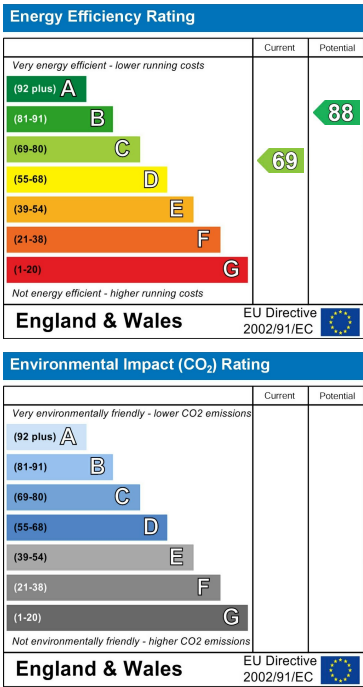

These particulars, whilst believed to be accurate are set out as a general outline only for guidance and do not constitute any part of an offer or contract. Intending purchasers should not rely on them as statements of representation of fact, but must satisfy themselves by inspection or otherwise as to their accuracy. No person in this firm's employment has the authority to make or give any representation or warranty in respect of the property.