



TENANTED GROUND FLOOR
FLAT

RENTAL INCOME £6000 PA

LONG TERM TENANT IN SITU

ALL SAFETY CERTIFICATES IN
PLACE

Main Street, Alexandria, West Dunbartonshire, G83 0AJ

Offers Over £49,995

ATTENTION LANDLORDS – EVE Property are delighted to present this fantastic investment opportunity to the open sales market: nestled within a traditional red sandstone building on Main Street, Alexandria. With a long-term tenant already in place, this investment property offers immediate rental income and hassle-free ownership from day one, generating an annual rental income of £6000.



Property Description

Step inside to discover a welcoming lounge and kitchen combination, with a generous front-facing window. The space flows effortlessly, creating a comfortable living area that feels both functional and inviting. A generously sized double bedroom provides ample room for rest and relaxation, while the well-appointed bathroom completes this thoughtfully arranged home.

Outside, residents enjoy access to a communal garden with refuse area. The property sits within a well-maintained common close, reflecting the pride and care shared among neighbours in this classic Scottish building.

The property further benefits from gas central heating and double glazed windows throughout.

Main Street is within walking distance to Alexandria Town Centre with local shops, library, cafes and banking hub. Alexandria Train Station is a short stroll away making commuting to Glasgow City Centre effortless. A82 road network is also close by offering road links to M8, Erskine Bridge, Glasgow Airport and beyond.





G1, 323 Main Street, Alexandria, G83 0AJ

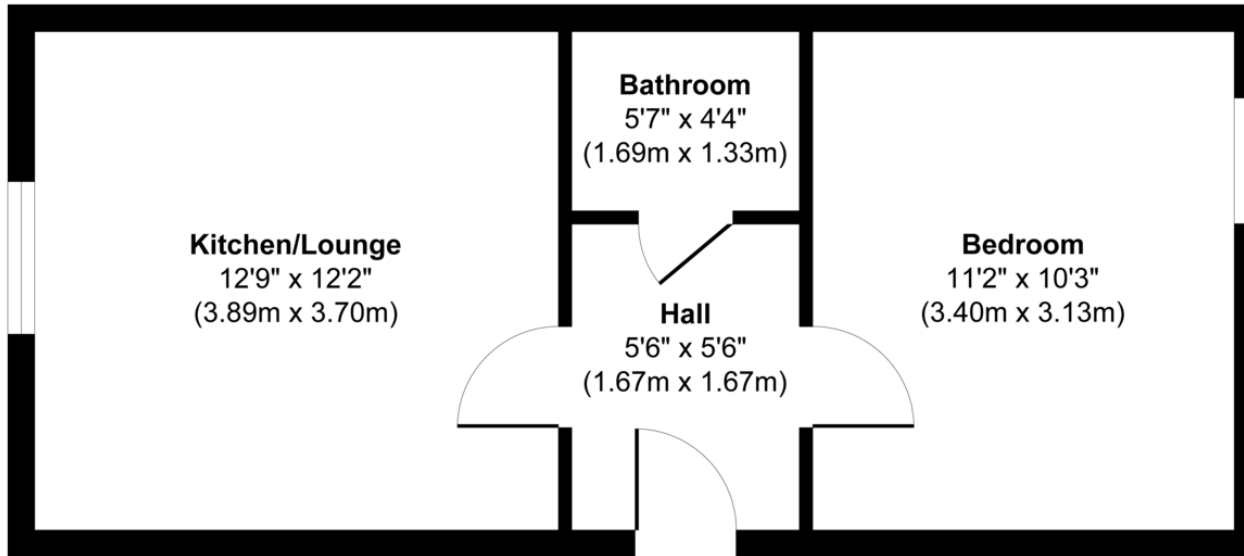

Floor Plan

Approx. Gross Internal Floor Area 355 sq. ft / 32.96 sq. m

Illustration for identification purposes only, measurements are approximate, not to scale.

Produced by Elements Property

1 Herschell Street, Anniesland,
Glasgow, Lanarkshire, G13 1HR

www.eve-property.co.uk
0141 255 0020
hello@eve-property.co.uk

Agents Note: Whilst every care has been taken to prepare these particulars, they are for guidance purposes only. All measurements are approximate are for general guidance purposes only and whilst every care has been taken to ensure their accuracy, they should not be relied upon and potential buyers/tenants are advised to recheck the measurements