



Chart House

6 Burrells Wharf Square, E14

Asking Price £300,000

A charming one-bedroom apartment with private balcony and parking, located in Burrell's Wharf Square on the Isle of Dogs: a popular private development, within close proximity to excellent transport links & amenities.

CHESTERTONS



Chart House

6 Burrells Wharf Square, E14

- 1 Bedroom | 565sq ft Internal Living Space
- Private Balcony
- Secure On-Site Parking
- On-Site Leisure Facilities incl. Swimming Pool, Gym, Spa and Sauna
- 24 Hour concierge
- Mudchute DLR Station 0.5km
- Masthouse Pier for Thames Clipper 0.15km



This large one-bedroom apartment offers in excess of 570sq ft of internal living space that comprises of a generous living space, a fully separate kitchen, a good-sized bedroom and a well-presented three-piece bathroom suite. Both the bedroom and the living room shared access onto a private balcony. The property also benefits from allocated parking as well.

Burrell's Wharf was the site of the construction of (at the time) the world's largest steam ship - SS Great Eastern. The 1850s & 1860s-built buildings were converted in the late 1980s by Galliard Homes, & the site was completed in the early 1990s with the addition of a number of newly built blocks.

Burrell's Wharf features a community feel absent in many developments in the area. The development is centred around a communal courtyard & is located next to the River Thames. On-site facilities are excellent: well-staffed site office (24-hour porteraqe), a residents' gym, sauna & swimming pool.

Tenure: Leasehold w/Share of Freehold – 962 years remaining approx.
Service Charge: £6,821pa approx.
Ground Rent: £10pa; From 24 June 2113, thereafter a peppercorn if demanded.
Local Authority: Tower Hamlets
Council Tax Band: D

Score	Energy rating	Current	Potential
92+	A		
81-91	B		
69-80	C	79 C	79 C
55-68	D		
39-54	E		
21-38	F		
1-20	G		

Chestertons Canary Wharf & Greenwich Sales

Harbour Island
 28 Harbour Exchange Square
 London
 E14 9GE
 canarywharf@chestertons.co.uk
 020 7510 8300
 chestertons.co.uk

Chart House,
Burrells Wharf Square, E14



○ - Ceiling Height

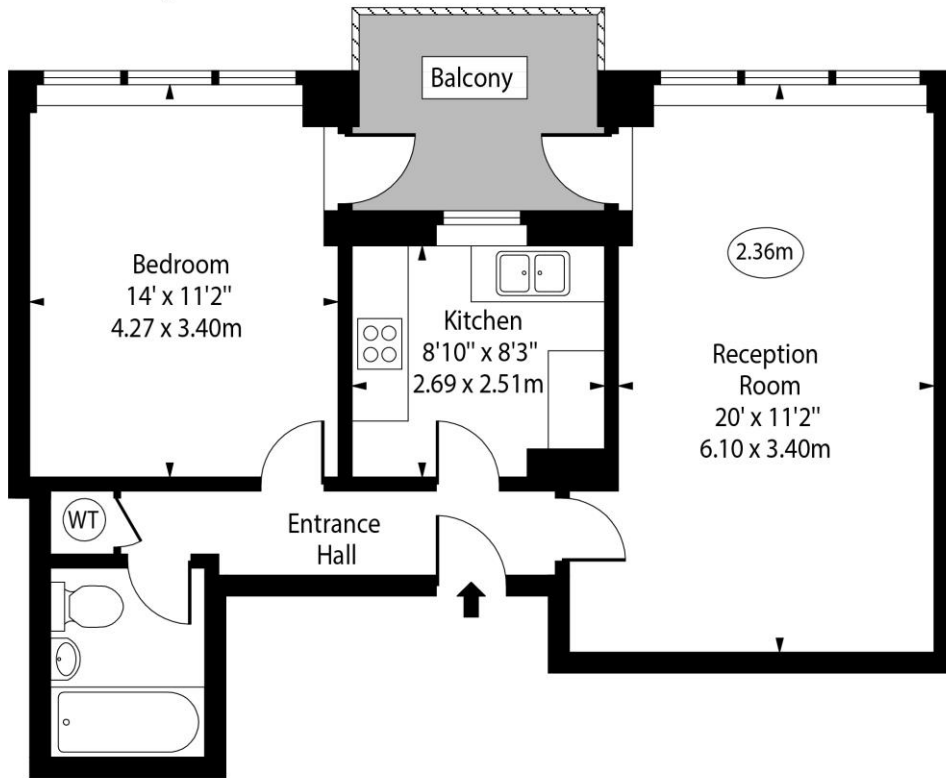

Third Floor

Approx Gross Internal Area 570 Sq Ft - 52.95 Sq M

Every attempt has been made to ensure the accuracy of the floor plan shown. However, all measurements, fixtures, fittings, and data shown are approximate interpretations and for illustrative purposes only. Measured according to the RICS. Not To Scale.

www.goldlens.co.uk

Ref. No. 029188K

