



63 Cradlebridge Drive

Willesborough Ashford, TN24 0RG

Price £310,000

Offered for sale with no onward chain is this semi-detached home in the popular Willesborough area.

Well presented, the property offers an entrance hall, sitting/dining room, kitchen, three bedrooms and bathroom/WC. A block paved driveway provides ample off road parking with an easy to maintain rear garden, gas central heating and double glazing. Several schools of good standing are in easy reach with Ashford town centre and mainline station just over one mile.

- PLEASANTLY APPOINTED SEMI DETACHED HOUSE
- THREE BEDROOMS
- SITTING / DINING ROOM
- MODERN KITCHEN
- LOW MAINTENANCE REAR GARDEN
- OFF ROAD PARKING
- GAS CENTRAL HEATING & DOUBLE GLAZING
- CLOSE TO POPULAR SCHOOLS & TRANSPORT LINKS

Viewing

Please contact our Ashford Office on 01233 646411 if you wish to arrange a viewing appointment for this property or require further information.



Floor Plan

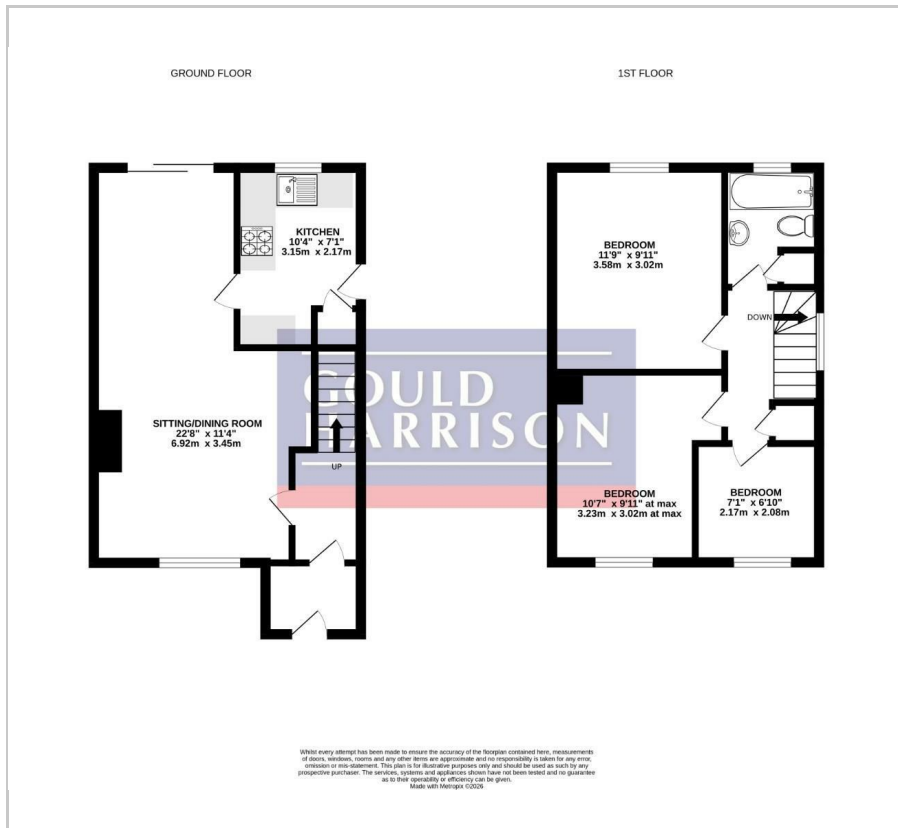

Area Map



Energy Efficiency Graph

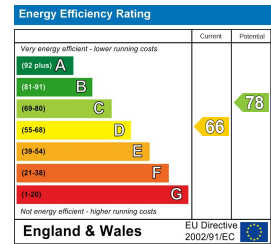

These particulars, whilst believed to be accurate are set out as a general outline only for guidance and do not constitute any part of an offer or contract. Intending purchasers should not rely on them as statements of representation of fact, but must satisfy themselves by inspection or otherwise as to their accuracy. No person in this firm's employment has the authority to make or give any representation or warranty in respect of the property.