



3 Barn Owl Close, Whiteley, Fareham, PO15 7QN

Offers In Excess Of £300,000



Barn Owl Close | Whiteley
Fareham | PO15 7QN
Offers In Excess Of £300,000

W&W are delighted to offer for sale this well presented two double bedroom terraced home offered with no chain ahead. The property boasts two double bedrooms, modern kitchen, lounge/dining room, cloakroom, modern bathroom & modern en-suite shower room to the main bedroom. Outside, the property benefits from a landscaped rear garden & allocated parking for two vehicles.

Barn Owl Close is in the new Whiteley development ideally located for the modern family lifestyle, the shopping centre providing a variety of shops and eateries as well as a cinema and supermarket is just a short stroll away, as is 'Meadowside', offering large play field, park & leisure centre. The nearby market town of Fareham and the M27, provides easy access to the vibrant coastal city of Portsmouth and further afield to London.



ID Checks/ Anti Money Laundering Checks

Should a purchaser(s) have an offer accepted on a property marketed by Walker & Waterer Estate agents, they will need to undertake an identification check. This is done to meet our obligation under Anti Money Laundering Regulations (AML) and is a legal requirement. We use a specialist third party service to verify your identity. The cost of these checks is £25 inc. VAT per person, which is paid in advance, when an offer is agreed and prior to a sales memorandum being issued. This charge is non-refundable under any circumstances.





Well presented 2022 built two double bedroom terraced home

No chain ahead

Welcoming entrance hall enjoying Amtico flooring flowing throughout the ground floor

Modern kitchen with attractive worktops, cabinets & upgraded LED kickboard lighting

Integrated appliances include oven, hob, dishwasher, washing machine & fridge/freezer

Lounge/dining room with double doors opening out to the rear garden & built in understairs storage cupboard

Downstairs cloakroom

Main bedroom with en-suite

Modern en-suite shower room comprising three piece white suite with feature large low profile shower cubicle tray & attractive wall tiling

Guest bedroom benefitting from twin windows & built in storage

Modern main bathroom comprising three piece white suite & attractive wall tiling

Southerly facing rear landscaped garden majority laid to lawn, multiple paved patio areas with shed to remain & rear access

Allocated parking to the rear for two vehicles

Estate management charge approx. £175 PA

Remainder of the NHBC warranty

ADDITIONAL INFORMATION

Property construction - Traditional brick build

Electricity supply - Mains

Water supply - Mains

Sewerage - Mains

Heating - Gas central heating

Broadband - There is broadband connected to the property

Please check here for potential broadband speeds - <https://www.openreach.com/fibre-broadband>

Please check here for all mobile networks - <https://checker.ofcom.org.uk/>

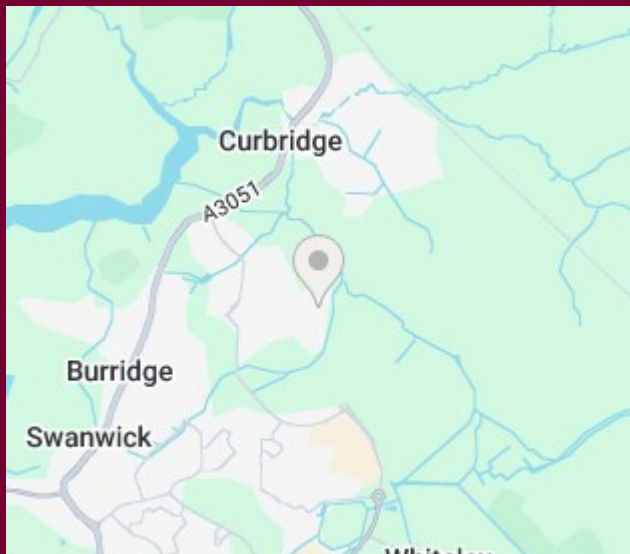

Ground Floor
332 sq.ft. (30.8 sq.m.) approx.

1st Floor
331 sq.ft. (30.7 sq.m.) approx.

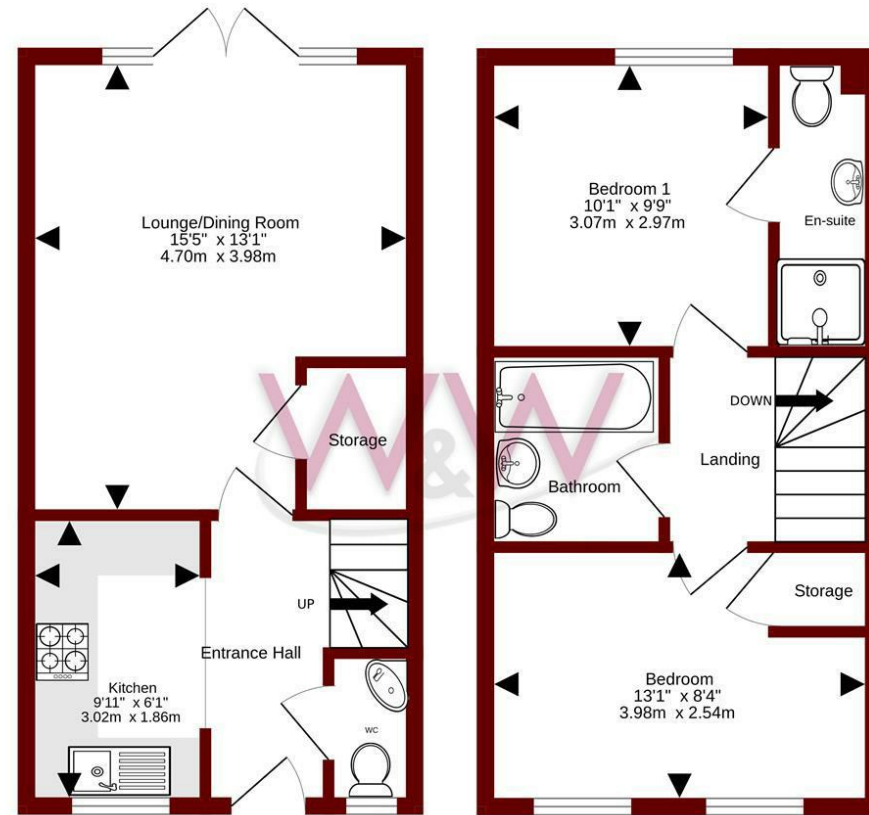

TOTAL FLOOR AREA: 663 sq.ft. (61.6 sq.m.) approx.

Whilst every attempt has been made to ensure the accuracy of the floorplan contained here, measurements of doors, windows, rooms and any other items are approximate and no responsibility is taken for any error, omission or mis-statement. This plan is for illustrative purposes only and should be used as such by any prospective purchaser. The services, systems and appliances shown have not been tested and no guarantee as to their operability or efficiency can be given.
Made with Metropix ©2026

Energy Efficiency Rating		Current	Potential
Very energy efficient - lower running costs			98
(92 plus) A			
(81-91) B		84	
(69-80) C			
(55-68) D			
(39-54) E			
(21-38) F			
(1-20) G			
Not energy efficient - higher running costs			
England & Wales		EU Directive 2002/91/EC	

Council Tax Band - C

Tenure - Freehold

Current EPC Rating - B

Potential EPC Rating - A

H3 Whiteley Shopping Centre

Whiteley Way

Whiteley

Hants

PO15 7PD

01489 580800

whiteley@walkerwaterer.co.uk

www.walkerwaterer.co.uk