



Ivyfield Court, Charter Road, Chippenham SN15 2QR

welcome to

Ivyfield Court, Charter Road, Chippenham

A ground-floor one-bedroom retirement apartment at Ivyfield Court. A Spacious living room, separate kitchen, double bedroom with wardrobe, shower room and handy storage cupboard. A well-planned retirement apartment with easy access to town in a peaceful setting.



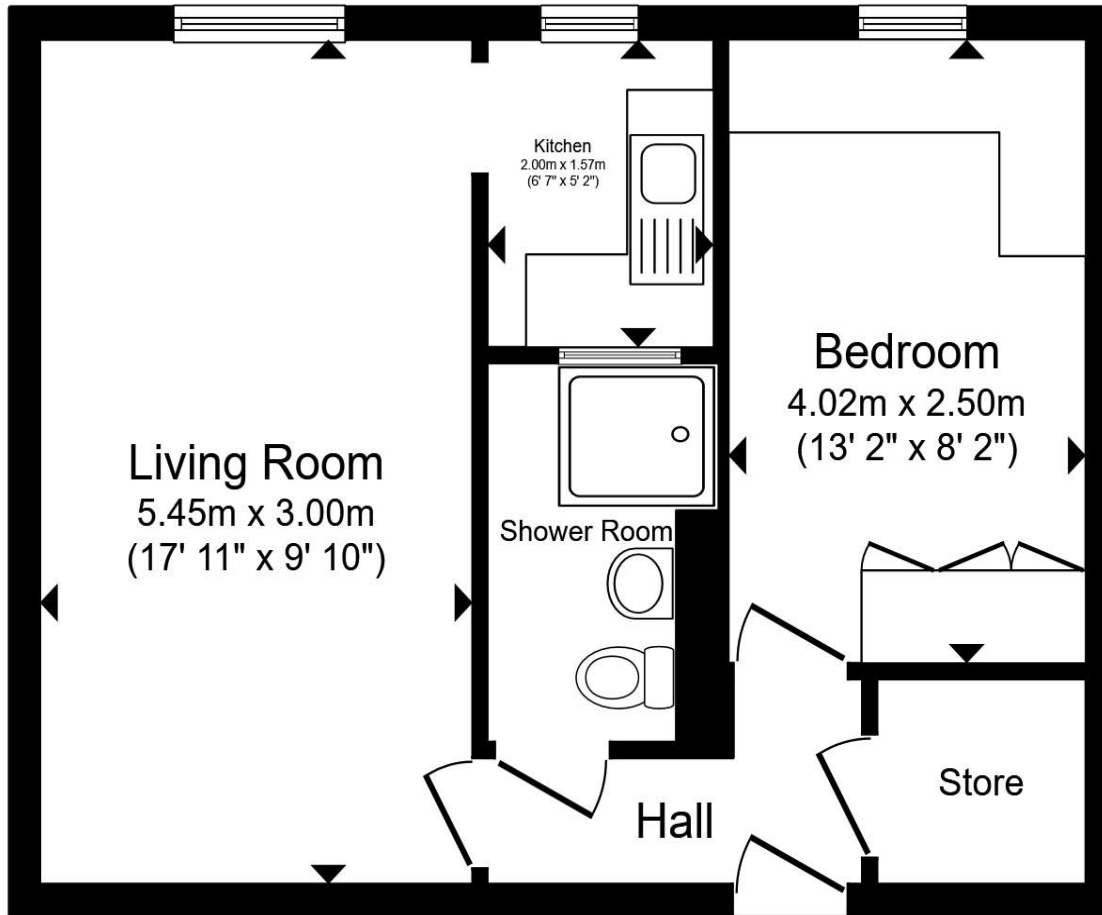

Agents Note

The sale of this property is subject to grant of probate. Please seek an update from the branch with regards to the potential timeframes involved.

Entrance Hall

Living Room

17' 11" x 9' 10" (5.46m x 3.00m)

Kitchen

6' 7" x 5' 2" (2.01m x 1.57m)

Bedroom

13' 2" x 8' 2" (4.01m x 2.49m)

Shower Room

Total floor area 39.5 m² (425 sq.ft.) approx

This floor plan is for illustrative purposes only. It is not drawn to scale. Any measurements, floor areas (including any total floor area), openings and orientation are approximate. No details are guaranteed, they cannot be relied upon for any purpose and they do not form part of any agreement. No liability is taken for any error, omission or misstatement. A party must rely upon its own inspection(s). Powered by www.propertybox.io

welcome to

Ivyfield Court Charter Road, Chippenham

- One Bedroom Ground Floor Apartment
- Close Proximity to Town Centre
- Spacious Living Room
- Communal Parking
- No Onwards Chain

Tenure: Leasehold EPC Rating: C

Council Tax Band: A Service Charge: 3501.96

Ground Rent: Ask Agent

This is a Leasehold property with details as follows; Term of Lease 99 years from 01 Dec 1987. Should you require further information please contact the branch. Please Note additional fees could be incurred for items such as Leasehold packs.

£110,000



Please note the marker reflects the postcode not the actual property

view this property online [allenandharris.co.uk/Property/CHP111682](https://www.allenandharris.co.uk/Property/CHP111682)



Property Ref:
CHP111682 - 0002

1. MONEY LAUNDERING REGULATIONS Intending purchasers will be asked to produce identification documentation at a later stage and we would ask for your co-operation in order that there is no delay in agreeing the sale. 2. These particulars do not constitute part or all of an offer or contract. 3. The measurements indicated are supplied for guidance only and as such must be considered incorrect. Potential buyers are advised to recheck measurements before committing to any expense. 4. We have not tested any apparatus, equipment, fixtures or services and it is in the buyers interest to check the working condition of any appliances. 5. Where an EPC, or a Home Report (Scotland only) is held for this property, it is available for inspection at the branch by appointment. If you require a printed version of a Home Report, you will need to pay a reasonable production charge reflecting printing and other costs. 6. We are not able to offer an opinion either written or verbal on the content of these reports and this must be obtained from your legal representative. 7. Whilst we take care in preparing these reports, a buyer should ensure that his/her legal representative confirms as soon as possible all matters relating to title including the extent and boundaries of the property and other important matters before exchange of contracts.

allen & harris



01249 655255



chippenham@allenandharris.co.uk



37 Market Place, CHIPPENHAM, Wiltshire,
SN15 3HT



[allenandharris.co.uk](https://www.allenandharris.co.uk)