

Towers Wills

Town & Country

📞 01935 577 032 | 01460 298 530 | ✉ info@towerswills.co.uk



**Dervaig, 6 Halfway, Chilthorne Domer, Yeovil,
Somerset BA22 8RE**

£300,000

Towers Wills welcome to market this extended semi-detached home, situated within a generous plot and offering countryside views to the front and rear. The property briefly comprises of; dual aspect sitting room, large kitchen/diner, three bedrooms, family bathroom, off road parking and a stunning rear garden, of which to enjoy this countryside setting.

Porch 0.47m x 1.90m

Double glazed patio doors to the front.

Entrance Hall

Double glazed window to the side and radiator.

Kitchen/Diner 7.05m x 3.71m - maximum measurements

Comprising of a range of wall, base and drawer units, work surfacing with sink/drain, triple glazed windows to the front, sides and rear, two radiators, triple glazed door to the rear garden, LPG boiler, space for electric cooker with extractor over, space for dishwasher, space for washing machine, space for under counter fridge or freezer and separate space for fridge/freezer.

Sitting Room 7.71m x 3.34m - maximum measurements

Double glazed door to the rear, double glazed window to the rear, double glazed bay window to the front and two radiators.

First Floor Landing

Loft hatch, radiator and double glazed window to the side.

Bathroom

Suite comprising bath with mixer tap shower, wash hand basin, w.c, double glazed window to the rear and radiator.

Bedroom One 3.68m x 3.32m - maximum measurements

Double glazed window to the rear, radiator and fitted wardrobe.

Bedroom Two 3.32m x 3.35m - maximum measurements

Double glazed window to the front and radiator.

Bedroom Three 2.19m x 1.87m

Double glazed window to the front and radiator.

Outside

To the front of the property is a driveway and gravel area with planted beds and mature shrubs.

Rear Garden

To the rear the garden is largely laid to lawn with patio area, well stocked borders, wooden shed, mature fruit trees, small pond and an outside tap.

Key Features

- Extended Semi-Detached
- Countryside Views
- Three Bedrooms
- Front and Rear Gardens
- Driveway
- Early Viewing Advised

Contact Us

Towers Wills Estate Agents - Yeovil

114, Hendford Hill

Yeovil

Somerset

BA202RF

T: 01935 577032

E: info@towerswills.co.uk

Energy Efficiency

Score	Energy rating	Current	Potential
92+	A		
81-91	B		
69-80	C		
55-68	D		55 D
39-54	E		
21-38	F	37 F	
1-20	G		



Floor Plan

GROUND FLOOR

1ST FLOOR

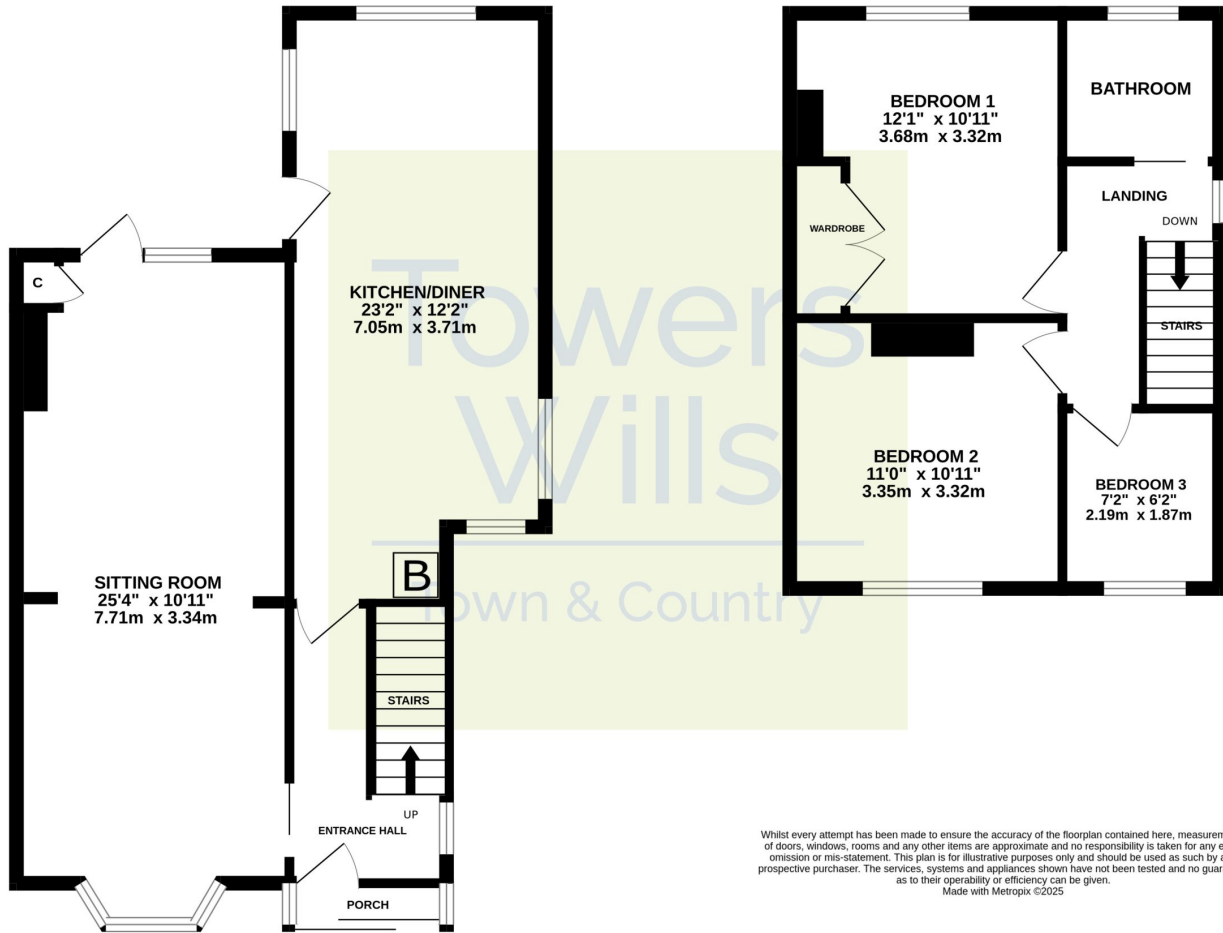

Please Note No tests have been undertaken of any of the services and any intending purchasers should satisfy themselves in this regard. Towers Wills Ltd for themselves and for the vendor of this property whose agents they are, give notice that, (i) these particulars do not constitute any part of an offer or contract, (ii) all statements contained within these particulars are made without responsibility on the part of Towers Wills or the vendor, (iii) whilst made in good faith, none of the statements contained within these particulars are to be relied upon as a statement of representation or fact, (iv) any intending purchaser must satisfy him/herself by inspection or otherwise as to the correctness of each of the statements contained within these particulars, (v) the vendor does not make or give either Towers Wills or any person in their employment any authority to make or give representation or warranty whatsoever in relation to this property.

Photographs / Floor Plans Photographs are reproduced for general information and it must not be inferred that any item is included for sale with this property. Please note floor plans are not to scale and are for identification purposes only. The photographs used in these particulars may have been taken with the use of a wide angle lens. If you have any queries as to the size of the accommodation or plot, please address these with the agent prior to making an appointment to view

Towers Wills

The White House, 114 Hendford Hill, Yeovil BA20 2RF

Yeovil 01935 577032 / South Petherton 01460 298530

info@towerswills.co.uk | www.towerswills.co.uk