



**6 Bed
House - Mid Terrace
located in**



7 Forest Road

Fishponds

BS16 3XH



£3,800 Per month

STUDENT PROPERTY – Ensuite rooms | Available August for the 2026/27 academic year

We are pleased to present this premium six-bedroom student home in the heart of Fishponds. Designed with student living in mind, this property offers spacious double bedrooms, 4 with private ensembles, and comes fully furnished throughout. There are two separate bathrooms for the two rooms without an ensuite.

The open plan living area downstairs comes with white goods, and there is a separate study area at the top of the house if you want to unwind or relax away from the rest of the house.

Located just 5 minutes walk away from the main university bus routes, with UWE Frenchay and Glenside campuses within easy reach, this house is perfectly placed for student life. Fishponds High Street, with its mix of shops, supermarkets, bars, and eateries, is only a short walk away.

Key Features:

- Six bedrooms
- 4 with ensuite bathrooms and 2 off suites bathroom
- Separate study area
- Premium student finish
- Excellent Fishponds location
- University bus routes 5 minutes walk away
- Close to shops, cafes, and eateries
- Wi-fi Included
- Available August 2026



GROUND FLOOR
535 sq.ft. (49.7 sq.m.) approx.

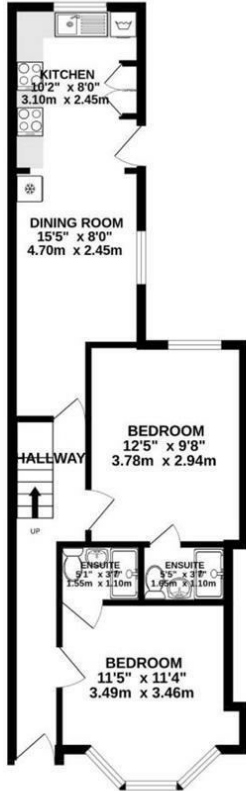

1ST FLOOR
452 sq.ft. (42.0 sq.m.) approx.



2ND FLOOR
291 sq.ft. (27.1 sq.m.) approx.

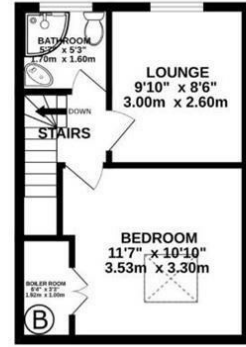

TOTAL FLOOR AREA: 1279 sq.ft. (118.8 sq.m.) approx.

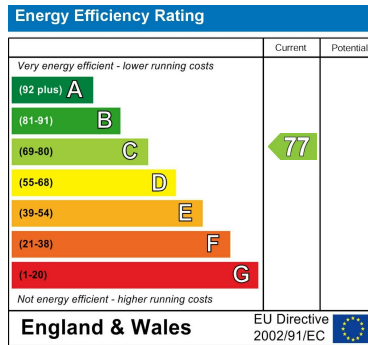

DIRECTIONS

CONTACT

Shore House Westbury Hill
Westbury-on Trym, Bristol
BS9 3AA

E: elliott.sherwood@frontdoorlettings.co.uk

T: 0117 457 8577

frontdoorlettings.co.uk

