



Disraeli Gardens, SW15

£699,950

Dexters



Disraeli Gardens, SW15

Set in the sought-after Disraeli Gardens, this large three bedroom mansion flat is offered to the market chain free. All three bedrooms are generously sized double bedrooms, this residence is ideal for families or professionals seeking ample living space. The flat also offers a large living room with three large sash windows allowing in abundant natural light.

The property also offers a modern bathroom and large eat in kitchen. This building has stunning communal gardens, which provide a serene escape with an on-site tennis court offering available to residents.

Disraeli Gardens is just off Putney High Street, between the station, River Thames and Wandsworth Park. Just moments from East Putney Tube and Putney station.

Features

- Three Bedrooms
- Chain Free
- Tennis Court Access
- Communal Gardens
- Share Of Freehold
- 5 Min Walk to East Putney







Disraeli Gardens, London, SW15

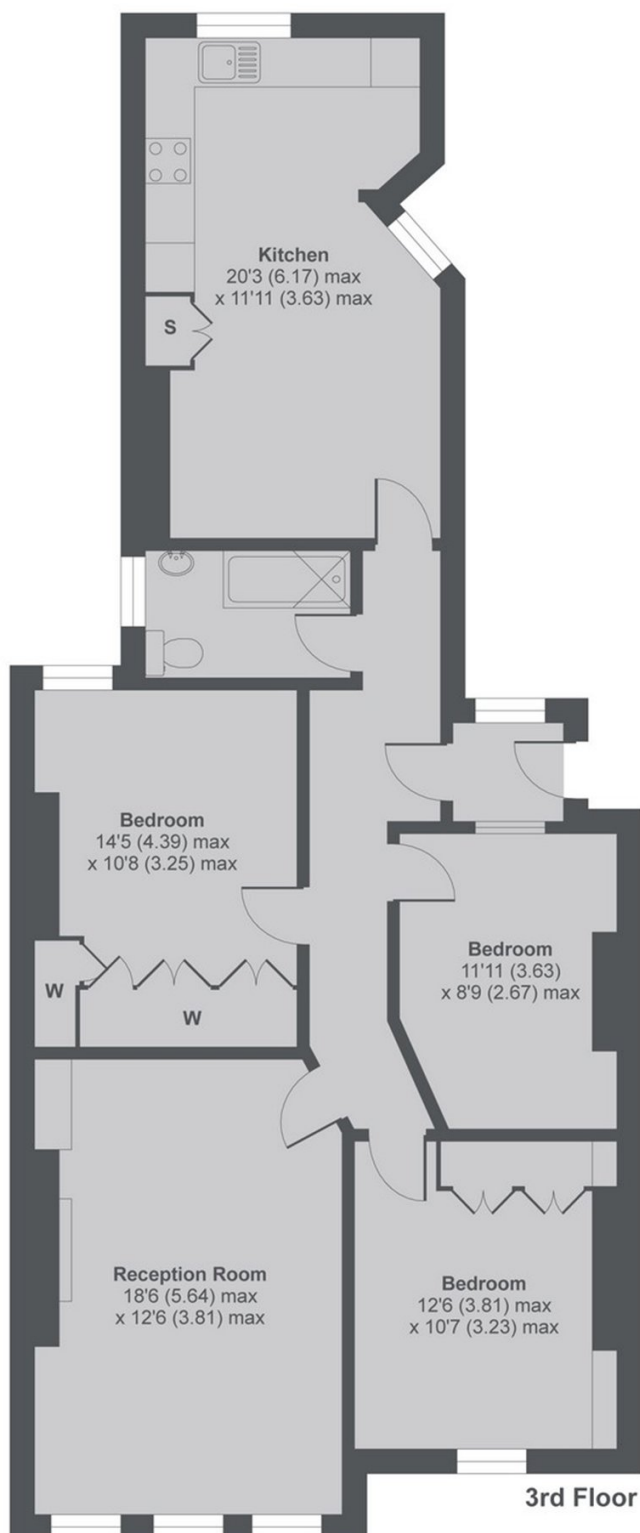

Disraeli Gardens, London, SW15

MAIN HOUSE APPROX FLOOR AREA 1048 SQ.FT 97.4 SQ.M
Copyright nichecom.co.uk 2017 Produced for Dexters REF : 196624

Dexters

Putney
176 Putney High Street
London
SW15 1RS
Sales
020 8789 9999

Energy Rating: . We aim to make our particulars both accurate and reliable. However they are not guaranteed; nor do they form part of an offer or contract. If you require clarification on any points then please contact us, especially if you're traveling some distance to view. Please note that appliances and heating systems have not been tested and therefore no warranties can be given as to their good working order.

 **RICS** Regulated
Estate Agent
and Letting Agent

dexters.co.uk