



Wimpson Lane, Southampton, SO16 4QA
Southampton

£150,000

Property Type: Flat

Bedrooms: 2 | Bathrooms: 1 | Receptions: 1

- Two Double Bedroom Second Floor Flat
- Ideal First Time Buyer Opportunity
- Bright Lounge With Balcony Access
- Modern Fitted Kitchen
- Well Presented Throughout
- Gas Central Heating
- Double Glazed Windows
- Secure Communal Entry System
- Convenient Maybush Location
- Affordable Service Charges & Low Ground Rent

Tenure Information - Leasehold

125 Years From 1988

Approx. 86 Years Remaining

Ground Rent: £10 Per Annum

Maintenance / Service Charge: £728 Per Annum

Additional Information

Construction: Brick Under Tiled Roof

Utilities: Mains Water, Mains Electric, Gas Central Heating

Council Tax Band: A

Local Authority: Southampton City Council

Location - Situated within the popular Maybush area of Southampton, Wimpson Lane offers excellent convenience for day-to-day living and is particularly well suited to first time buyers wanting both affordability and accessibility. The property is within easy reach of local shops, supermarkets, bus routes and road links, with Southampton General Hospital, Shirley High Street and Southampton city centre all easily accessible. The area is also well placed for commuters, with convenient access towards the M271, M27 and wider motorway network.





This attractive home presents an excellent opportunity for first time buyers, those looking to step onto the property ladder, or investors seeking a well-balanced and easy-to-maintain property in a popular residential location. Offering generous room proportions throughout, the property benefits from a bright lounge with direct access onto a private balcony, a modern fitted kitchen, two genuine double bedrooms, gas central heating and double glazed windows.

The accommodation is approached via a secure communal entrance with security entry system, leading through to the private front door and welcoming entrance hallway. The hallway offers a practical first impression with carpeted flooring, radiator, and access through to all principal rooms.

The lounge is a particularly appealing main living space and offers a bright and comfortable setting for both everyday living and entertaining. A double glazed window and door allow for excellent natural light, while direct access onto the balcony provides a lovely additional feature, ideal for enjoying some outdoor space, morning coffee or simply allowing the room to feel even more open and airy.

The kitchen is fitted with a good range of base and eye level units, together with work surface space ideal for day-to-day use. There is a single drainer sink unit, built-in cooker/oven, space and plumbing for a washing machine, and further space for a fridge/freezer. Finished with vinyl flooring, part tiled surrounds and a double glazed window, this is a practical and functional kitchen well suited to modern living.

Both bedrooms are excellent doubles, making this property especially appealing when compared to many similar apartments in the area. Bedroom one offers a comfortable principal bedroom with double glazed window, radiator and fitted carpet. Bedroom two is another generous double room and benefits from a useful built-in storage cupboard which houses the refitted gas boiler, providing both practicality and efficient use of space.

The bathroom is fitted with an enclosed bath with shower fitted above and curtain rail, low level WC, wash hand basin, part tiled walls, vinyl flooring, an obscure double glazed window, and the added benefit of a separate storage cupboard.

Overall, this is a fantastic opportunity to purchase a well presented, sensibly priced first home in a highly convenient Southampton location, offering spacious accommodation, sensible ongoing costs, and excellent access to local amenities and transport links.

Disclaimer - All information has been provided by the vendor and is believed to be accurate at the time of publication. Buyers are advised to verify all information, including tenure, lease length, service charges, ground rent, utilities, construction type and measurements, via their solicitor or surveyor prior to purchase.

Tenure: Leasehold

Council Tax Band: A



TOTAL APPROX FLOOR AREA - 63sq m. / 678 sq ft.

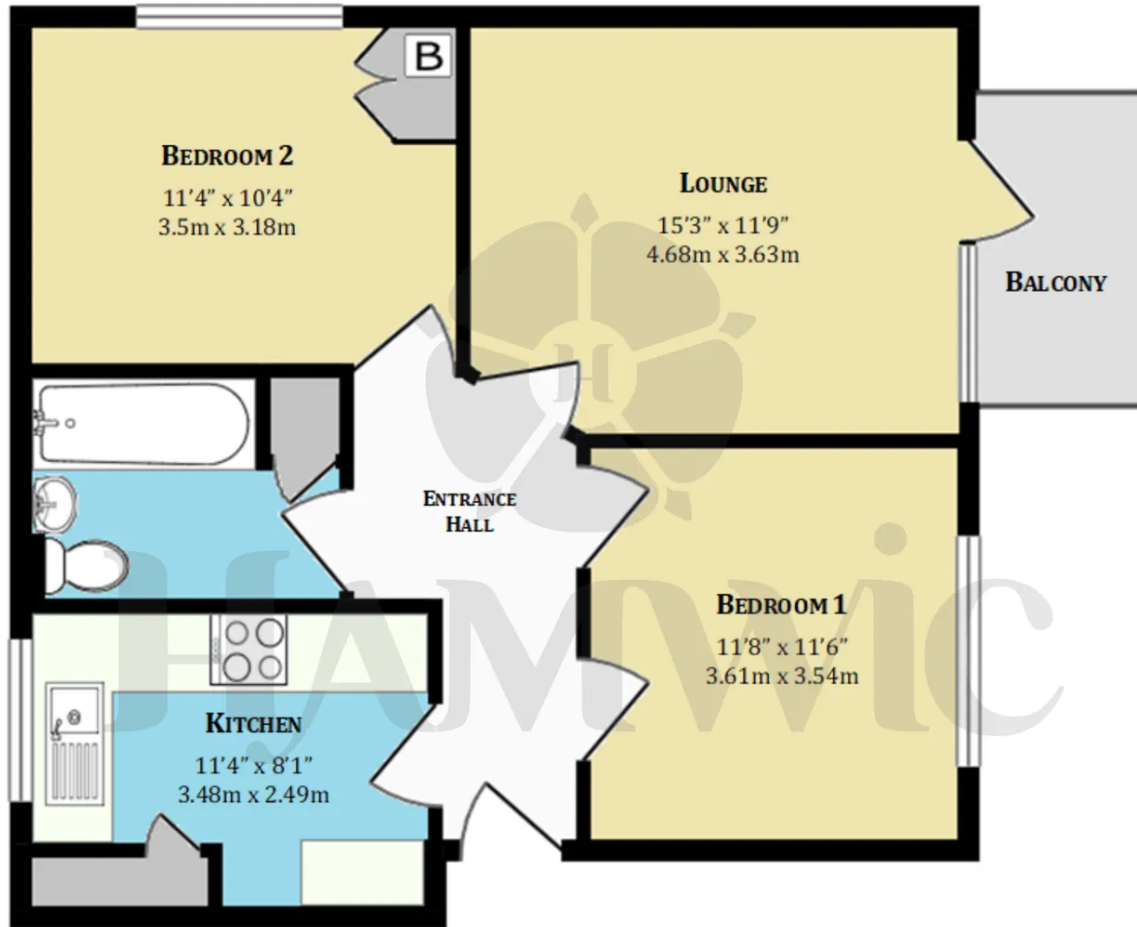

All measurements are approximate and for guidance only. Floorplans are not to scale and should not be relied upon as exact representations. Fixtures, fittings, and services have not been tested. Purchasers must verify the accuracy of all information and satisfy themselves before proceeding. Hamwic Independent Estate Agents Ltd accepts no liability for errors or omissions.



Trusted. Award Winning. Experts.

Hamwic Estate Agents

3 – 4 South Parade, Salisbury Road, Southampton SO40 3PY

02380 663999

enquiries@hamwicestateagents.co.uk

<https://www.hamwicestateagents.co.uk/>

