



Gidea Close, South Ockendon RM15

Guide Price £200,000





## Gidea Close, South Ockendon RM15

Presenting this well-presented ground-floor apartment, ideally situated in the heart of South Ockendon, offering a superb opportunity for first-time buyers or investors seeking a property with excellent transport links and modern convenience.

The apartment features a spacious lounge, perfect for relaxing or entertaining guests, complemented by a fitted kitchen that provides ample storage and worktop space for all your culinary needs.

There are two generously sized bedrooms, each offering comfortable accommodation and flexibility for a range of lifestyles, whether you require a guest room, home office or nursery. The bathroom is well-appointed, featuring a contemporary suite and practical layout. This property benefits from an allocated parking space, ensuring convenience and peace of mind for residents.



## Gidea Close, South Ockendon RM15

With 157 years remaining on the lease, buyers will appreciate the long-term security and low maintenance concerns associated with this home. The location is particularly advantageous, with South Ockendon Station located nearby, offering direct rail connections into London and surrounding areas, making this an attractive proposition for commuters.

Council Tax band: B

Tenure: Leasehold

EPC Energy Efficiency Rating: D

- Ground floor apartment situated in South Ockendon
- Lounge
- Fitted kitchen
- Two bedrooms
- Bathroom
- Allocated parking space
- 157 years remaining on lease
- Close to South Ockendon Station
- No onward chain



# Gidea Close, South Ockendon, RM15

Approximate Area = 500 sq ft / 46.4 sq m

For identification only - Not to scale

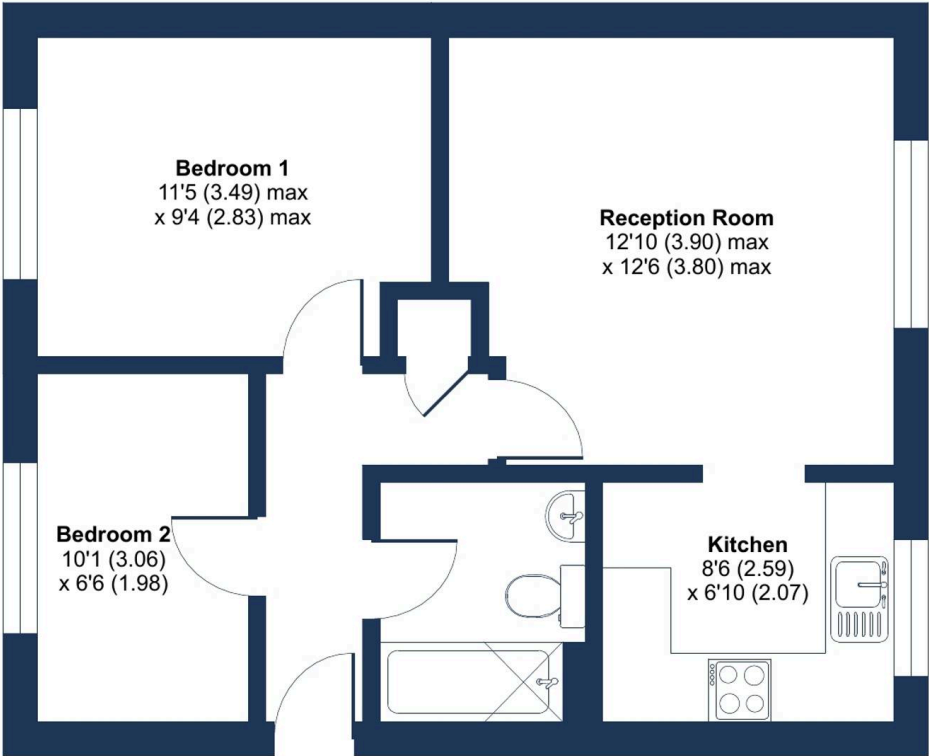

**GROUND FLOOR**