

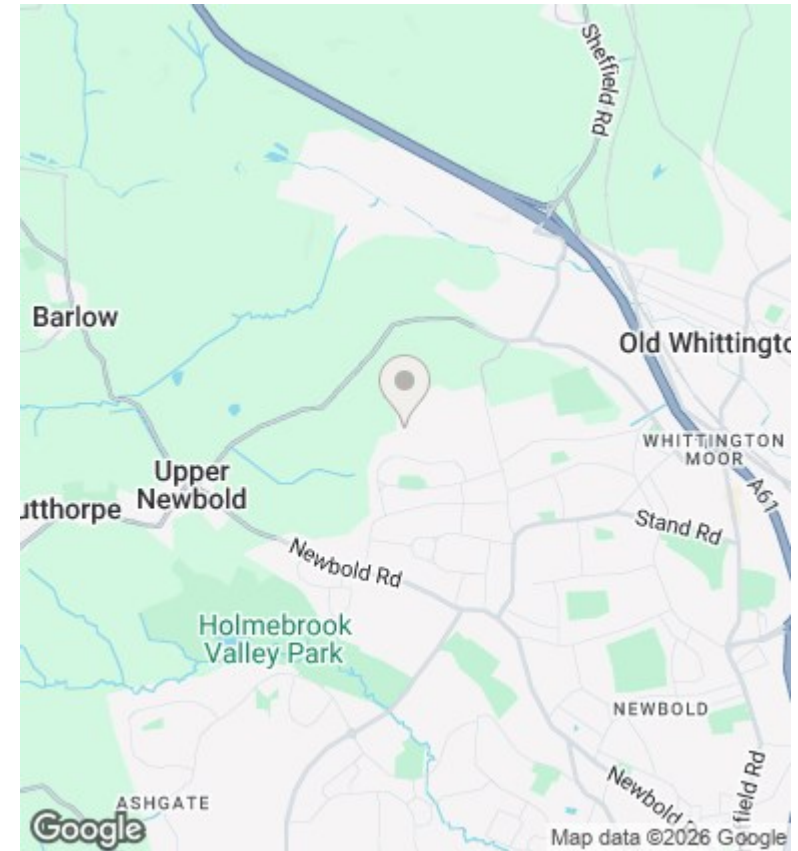

25 Patterdale Road, Newbold, Chesterfield, S41 8FE

Offers In The Region Of £210,000

- Ideal starter home
- Kitchen diner with integrated appliances
- Contemporary styling throughout
- Still under NHBC warrantee GCH and Double glazing
- 2 Double bedrooms
- Downstairs Wc
- Indian paver patio area with low maintainance lawn
- Summer house with electrics ideal for home office/gym
- Off street parking for two vechicles
- Viewing is highly recommended

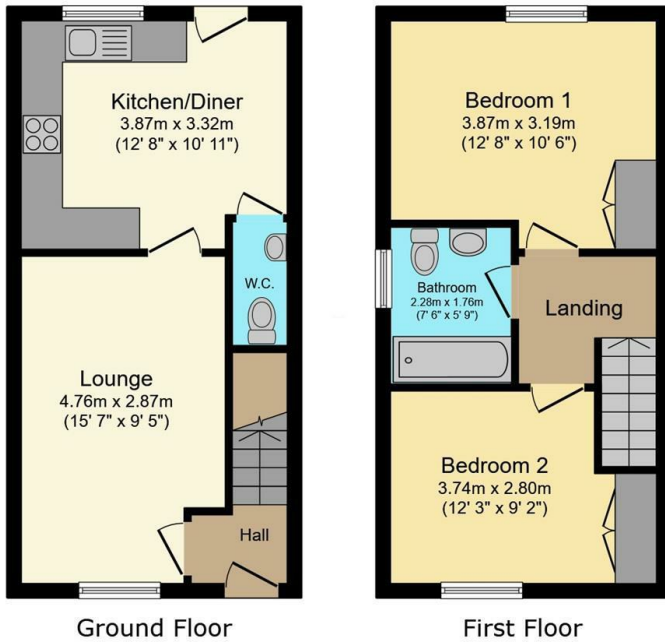

Energy Efficiency Rating		Current	Potential
Very energy efficient - lower running costs			
(92 plus) A			96
(81-91) B		83	
(69-80) C			
(55-68) D			
(39-54) E			
(21-38) F			
(1-20) G			
Not energy efficient - higher running costs			
England & Wales		EU Directive 2002/91/EC	

Total floor area: 63.3 sq.m. (681 sq.ft.)

This floor plan is for illustrative purposes only. It is not drawn to scale. Any measurements, floor areas (including any total floor area), openings and orientations are approximate. No details are guaranteed, they cannot be relied upon for any purpose and do not form any part of any agreement. No liability is taken for any error, omission or misstatement. A party must rely upon its own inspection(s). Powered by www.Propertybox.io

Directions

Viewings

Viewings by arrangement only. Call 01246 276 276 to make an appointment.

Council Tax Band

A

EPC Rating:

B