



Charter Street | | Chatham | ME4 5RZ

Offers invited £150,001



Charter Street |  
Chatham | ME4 5RZ  
Offers invited £150,001

Positioned in a convenient and well-connected part of Chatham, this well-proportioned two-bedroom maisonette presents an excellent opportunity for first-time buyers looking to step onto the property ladder, as well as buy-to-let investors seeking a strong, low-maintenance addition to their portfolio.

The property offers approximately 560 sq. ft. of internal space and is arranged to provide a practical and comfortable layout. The spacious reception room enjoys plenty of natural light, creating a welcoming environment ideal for both relaxing and entertaining. The separate kitchen is functional and well-sized, with scope for modernisation to add further value.

There are two bedrooms, both offering good proportions, making the property suitable for sharers, small families, or those needing a home office. The bathroom is conveniently located and completes the internal accommodation.

- Two-bedroom maisonette
- Well-proportioned layout (approx. 560 sq. ft.)
- Close to Chatham station (direct links to London)
- Long lease with 89 years remaining
- Communal outdoor space
- Spacious and bright reception room
- Ideal for first-time buyers or investors
- Convenient access to town centre and amenities
- Low ground rent (£10 per annum)
- Scope to modernise and add value





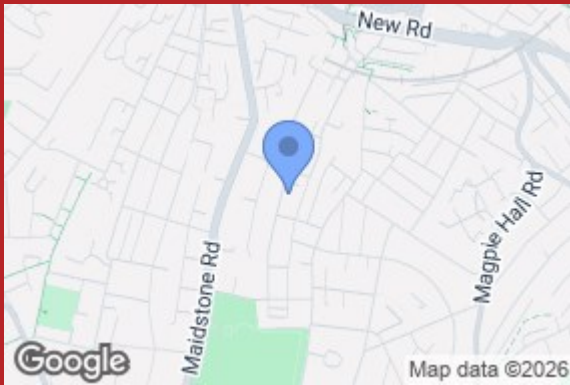

GROUND FLOOR  
608 sq.ft. (56.5 sq.m.) approx.

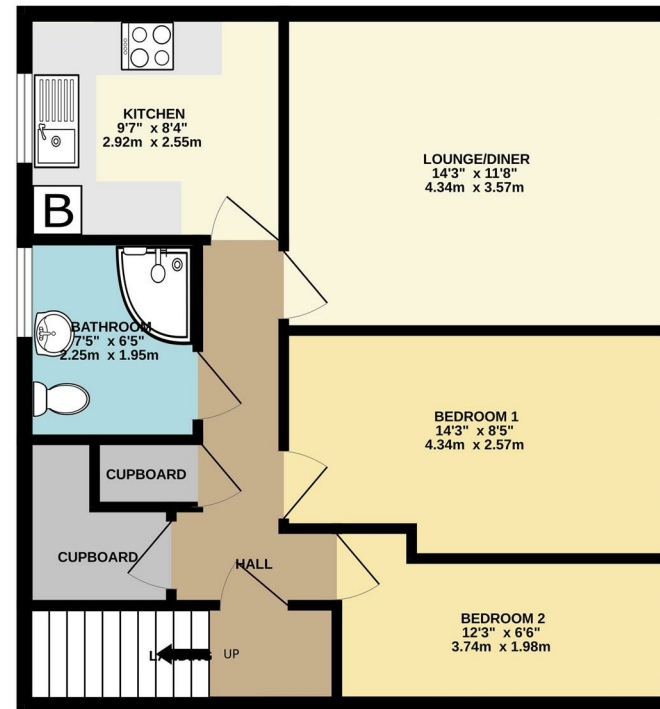

TOTAL FLOOR AREA - 608 sq.ft. (56.5 sq.m.) approx.

Whilst every attempt has been made to ensure the accuracy of the floorplan contained here, measurements of doors, windows, rooms and any other items are approximate and no responsibility is taken for any error, omission or mis-statement. This plan is for illustrative purposes only and should be used as such by any prospective purchaser. The services, systems and appliances shown have not been tested and no guarantee as to their operability or efficiency can be given.  
Made with Metropax ©2026

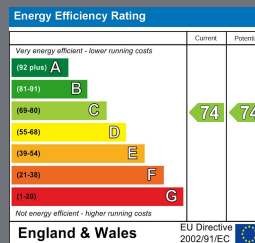

2B Crow Lane  
Rochester  
Kent  
ME1 1RF  
01634 829080

admin@machin-lane.co.uk  
<https://www.machin-lane.co.uk/>