



Luscombe Maye

Since 1873

Court Road, NEWTON FERRERS, South Devon

4 2 4



Nestled in the heart of the highly sought-after South Hams village of Newton Ferrers, this exceptional four-bedroom, two-bathroom detached home offers a blend of luxury and contemporary living.

Upon entering this spacious home, you are greeted by a thoughtful layout designed for modern life. The ground floor boasts three reception rooms and a cosy study/snug, providing versatile spaces for relaxation, dining, and home office. At the heart of the home is an impressive kitchen/dining room, recently extended by the current owners to create a sociable and relaxing space. The central island, integrated appliances, and impressive range oven make it a chef's delight and the double doors opening onto from dining area to a large patio, creating an ideal space for entertaining and family life. A convenient utility room and cloakroom complete the ground floor amenities.

Upstairs, the primary bedroom suite is a true sanctuary, offering a luxurious en-suite bathroom and a dedicated dressing room. There are three further double bedrooms sharing a family bathroom, providing ample space and privacy for all occupants.

Externally, the property truly shines with a sunny, level rear garden, mainly laid to lawn with a maturing beech hedge and pretty, established borders and flower beds. To the front of the property is a sheltered and sunny terrace where broad steps and a paved pathway lead up to the detached double garage and driveway large enough for 2 cars.

VERIFIED MATERIAL INFORMATION

To ensure legal compliance, we require our sellers to complete a Property Information Questionnaire or provide a Material Information Guide along with the title document. If available, please scan the QR code or access the additional online material information (<https://moverly.com/sale/Rt5znctmqWga7f6MadCKqP/view>).



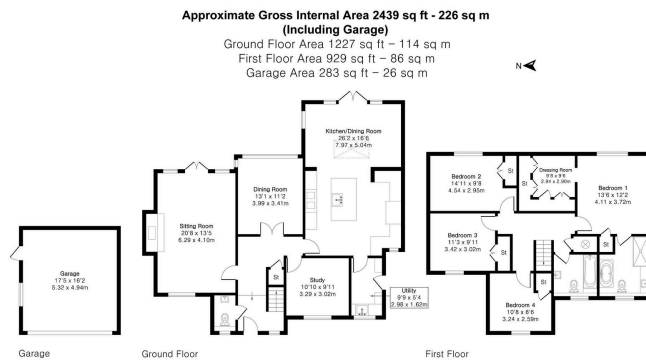

Floor plan produced in accordance with RICS Property Measurement 2nd Edition. Although Pink Plan Ltd ensures the highest level of accuracy, measurements of doors, windows and rooms are approximate and no responsibility is taken for error, omission or misstatement. These plans are for representation purposes only and no guarantee is given on the total square footage of the property within this plan. The figure shown is for initial guidance only and should not be relied on as a basis of valuation.



- Exceptional modern detached family home
- Stylish kitchen with feature island
- Sitting room with log burner
- Primary bedroom suite with dressing room and en-suite bathroom
- Further three double bedrooms with family bathroom
- Private, sheltered level garden
- Double garage with driveway
- Private, central village location
- Short Walk To All local amenities
- Council Tax Band G



Use the QR code for further "Material Information" about this home



Newton Ferrers:
 Newton Hill, Newton Ferrers PL8 1AA
 01752 872417
 newtonferrers@luscombemaye.com
 www.luscombemaye.com

Important Notice: Luscombe Maye gives notice that: 1. These particulars do not constitute an offer or contract or part thereof. 2. All descriptions, photographs and plans are for guidance only and should not be relied upon as statements or representations of fact. All measurements are approximate and not necessarily to scale. Any prospective purchaser must satisfy themselves of the correctness of the information within the particulars by inspection or otherwise. 3. Luscombe Maye does not have any authority to give any representations or warranties whatsoever in relation to this property (including but not limited to planning/building regulations), nor can it enter into any contract on behalf of the Vendor.